

Sketch for No. 12 D.
 Baylor County
 Sketch file

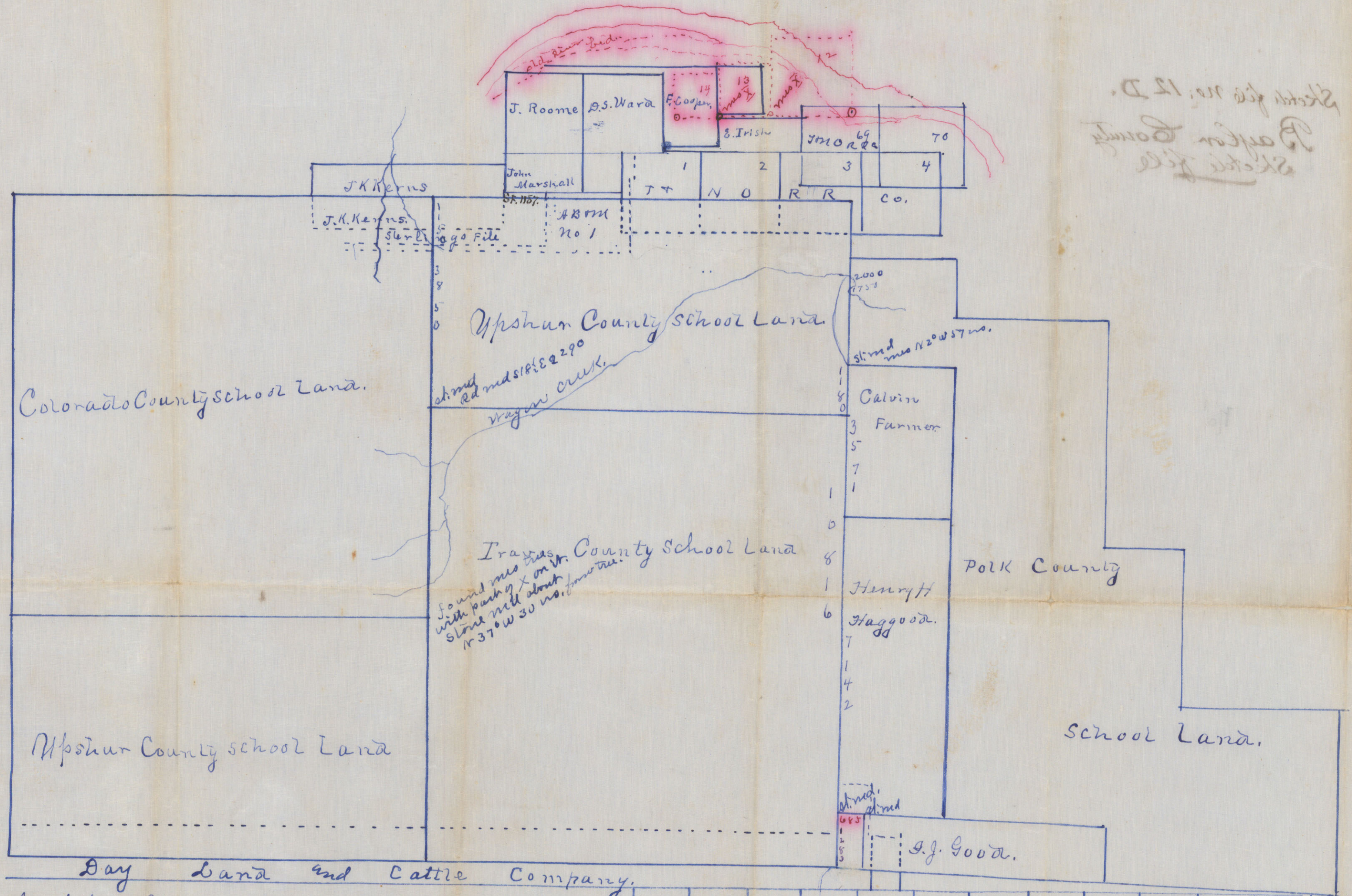

The State of Texas
 County of Baylor
 J.A. Kerr, Surveyor of Baylor Co
 hereby certify that the above sketch
 with all its representations thereon
 are correct as fed by actual
 survey made on the ground.
 Witness my official signature
 at Office in Seymour, this
 11th day of Sept A.D. 1900.
 J.A. Kerr
 Sur. Baylor Co Texas.

3087	3086	3063	3062	3039	3038	3015	3014	2200	2199	2153	2152	2131	2111
		T.		E.		S.		L.		Co.			
3088	3085	3064	3061	3040	3037	3016	3013	2198	2197	2154	2151	2132	2110

Received Sept. 15th 1900
 and filed in Baylor County
 Sketches, See collecting line filed 8/15/1900
 C. von Rosenberg
 Examining draftsman.

Counter # 10323

COMPTON # 1882

10

Sketch file no: 12 D.
 Baylor County
 Sketch file

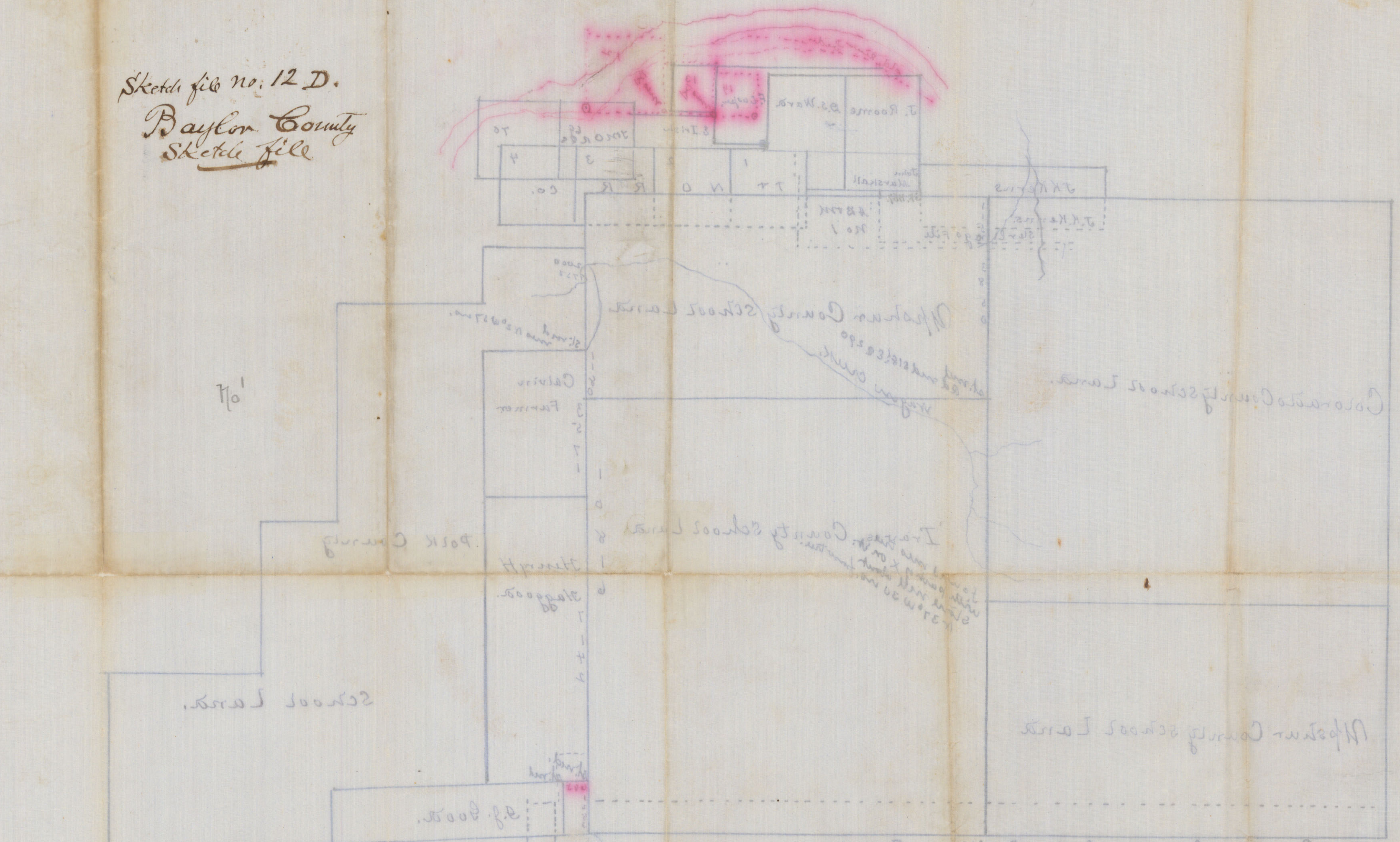

3081	3082	3083	3084	3085	3086	3087	3088	3089	3090	3091	3092	3093	3094	3095	3096	3097	3098	3099	3100	3101	3102	3103	3104	3105	3106	3107	3108	3109	3110	3111
T.	T.	T.	T.	T.	T.	T.	T.	T.	T.	T.	T.	T.	T.	T.	T.	T.	T.	T.	T.	T.	T.	T.	T.	T.	T.	T.	T.	T.	T.	
3081	3082	3083	3084	3085	3086	3087	3088	3089	3090	3091	3092	3093	3094	3095	3096	3097	3098	3099	3100	3101	3102	3103	3104	3105	3106	3107	3108	3109	3110	

The State of Texas,
 County of Baylor,
 J. H. Baker, Surveyor of Baylor Co.
 hereby certify that the above sketch
 with all the representations thereon
 are correct as far as actual
 survey made on the ground.
 Witness my official signature
 at office in my name this
 11th day of Sept 1890.
 J. H. Baker
 Surveyor of Baylor Co. Texas.

Received Sept. 12th 1900
 and filed in Baylor County
 records, see construction
 of map & records
 Examined and approved
 To

COUNTER # 78865

See later sketch 12 E.

Counter # 10323

52

Recd 9-15-1900

Vol. 607
p. 205

Acknowledged Oct 4/1900

Seymour Dyer

Henry Chas Royan

9:30

Land Comm

Austin Tx

Dwain

In closed find sketch compiled in accordance with connecting lines made for Fred A. Sterling, which should have been sent you some time ago.

In your cord ack. receipt of Sterling papers you state "Send 1.00 filing fee. I did not return Field notes of a survey for acreage but only two connecting lines. but if Filing fees are due for filing Field notes of Connecting lines, please in form me and same will be remitted.

Please notice at top of sketch in I show position of Lynn & Hordie surveys nos 13 & 14. The place for

stone and at S E cor of sur 12
is in River.

When I ran west for Hackberry
called for in field notes of survey
no 15 - I came to point near Hackberry
groves, on Dry creek.

have no doubt but this
is the true position for surveys
nos 13 & 14 for J. H. Lynn &
John S. Hardin.

Yours Truly

A. S. Kerr

Sur. Baylor Co Texas

Answered Oct 4/1900, by Peoples.

vol. 607

Roseburg

120

OFFICE OF

A. D. KERR,

County Surveyor,

...BAYLOR COUNTY...

120

SEYMOUR, TEXAS, 10/12 1900

Herb Chas Royan,
Land Commr,
Austin Texas

Dear Sir,

In a recent
favor you say you fail to find
any field notes with P. A. Sterling's
File. There are no field notes
for the reason that if you will
examine the Connecting line you
will find that there is no land.

See field notes of Connecting
Lines and plat forwarded some
time ago.

Yours Respectfully
A. D. Kerr,

Recd 10/15/1900

Returned to the application of F. A.
Sterling re this to him this day 5/1900
88495

OFFICE OF
A. D. KERR
TAYLOR COUNTY...

SPRYMOUR, TEXAS

100...

Sketch file no. 12 D.

Taylor County
Sketch file

Certified sketch in
S.E. part of Taylor
County on line of Henkle
Co. See also connecting
lines & letter of explanation
all forming part of this
sketch Filed Sept 15/19

See connecting lines
mkd 12 A. 12 B & 12 C.

Edw. R. Roubey Draftsman
88496