

Tom Green Co
 State
 filed Sept 25/93
 B. R. G. Co.
 San Saba Co.
 1000



J. C. Davis, Deft. In Tom Green Co.
 Do hereby certify that this sketch
 represents the Survey as found by
 me on the ground and is correct
 C. E. Davis Deft. In Tom Green Co.

J. H. B. Garrow do certify that I have
 examined this sketch and find the
 same correct
 J. H. B. Garrow
 Deft. In Tom Green Co.

See Sketch 48



No. 763
 Tom Green Co.
 Sketch
 (old Tom Green 46)
 filed Sept. 25th / 83.
 D. H. Robinson
 Chief Clerk.
 Sketch file 51
 Coke Co.

J. E. Davis says in his book
 he says that the sketch
 represents the survey as found by
 me on the ground and is correct.
 J. E. Davis
 J. E. Davis for witness I have
 examined this sketch and find it
 correct.
 J. E. Davis
 J. E. Davis

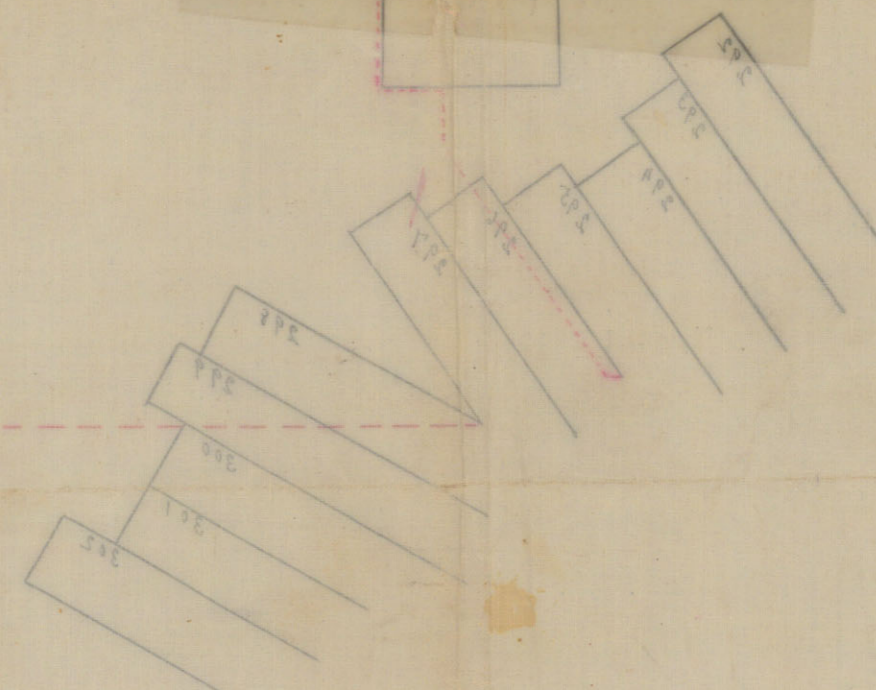

Sketch of Block W. in Palo Verde
 Land District made for the
 J.H. New Co.

Handwritten notes in red ink, partially illegible.

17 Bks. 11. 128 W.

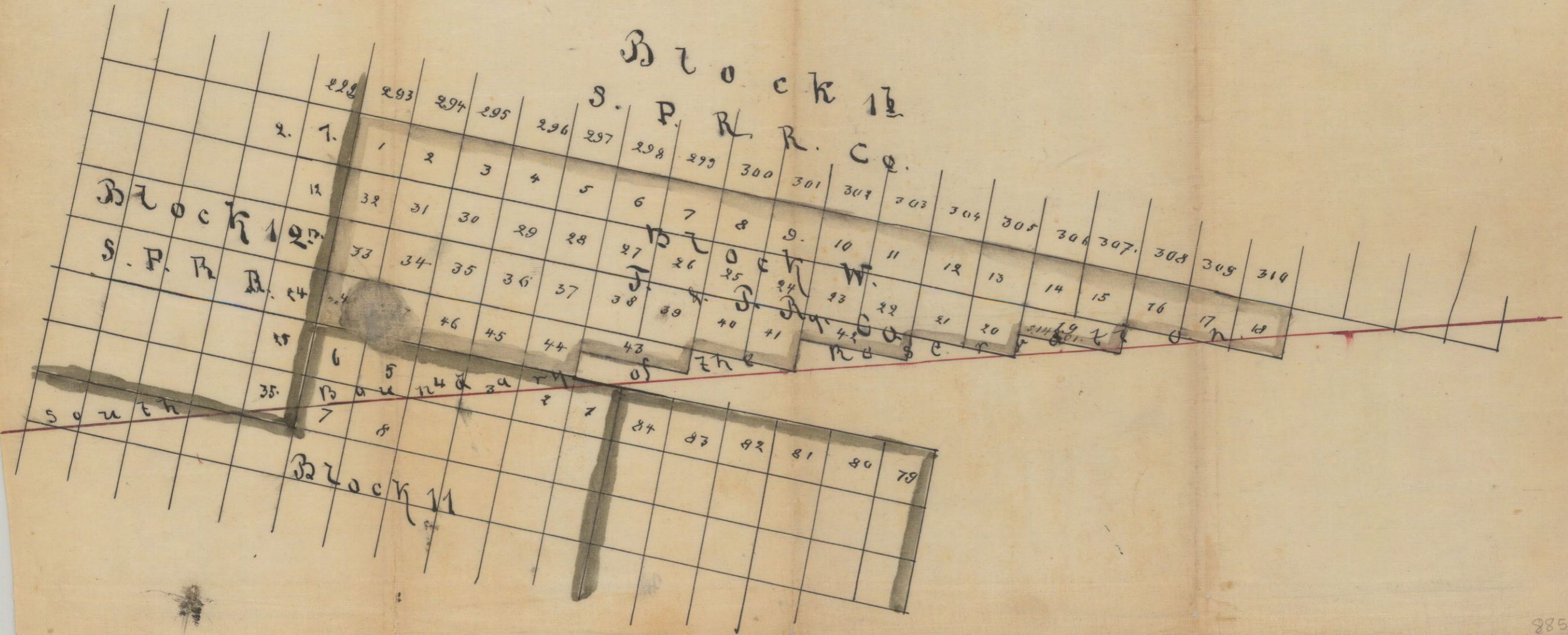

W. H. ...
...
C. H. ...

File No. 3
Tom Guido

17 BIKS, 11, 12 & W.

10	11	12	13	14	15	16	17	18	19
20	21	22	23	24	25	26	27	28	29
30	31	32	33	34	35	36	37	38	39
40	41	42	43	44	45	46	47	48	49
50	51	52	53	54	55	56	57	58	59
60	61	62	63	64	65	66	67	68	69
70	71	72	73	74	75	76	77	78	79
80	81	82	83	84	85	86	87	88	89
90	91	92	93	94	95	96	97	98	99
100	101	102	103	104	105	106	107	108	109