

Scurry Co.

Fisher Co.

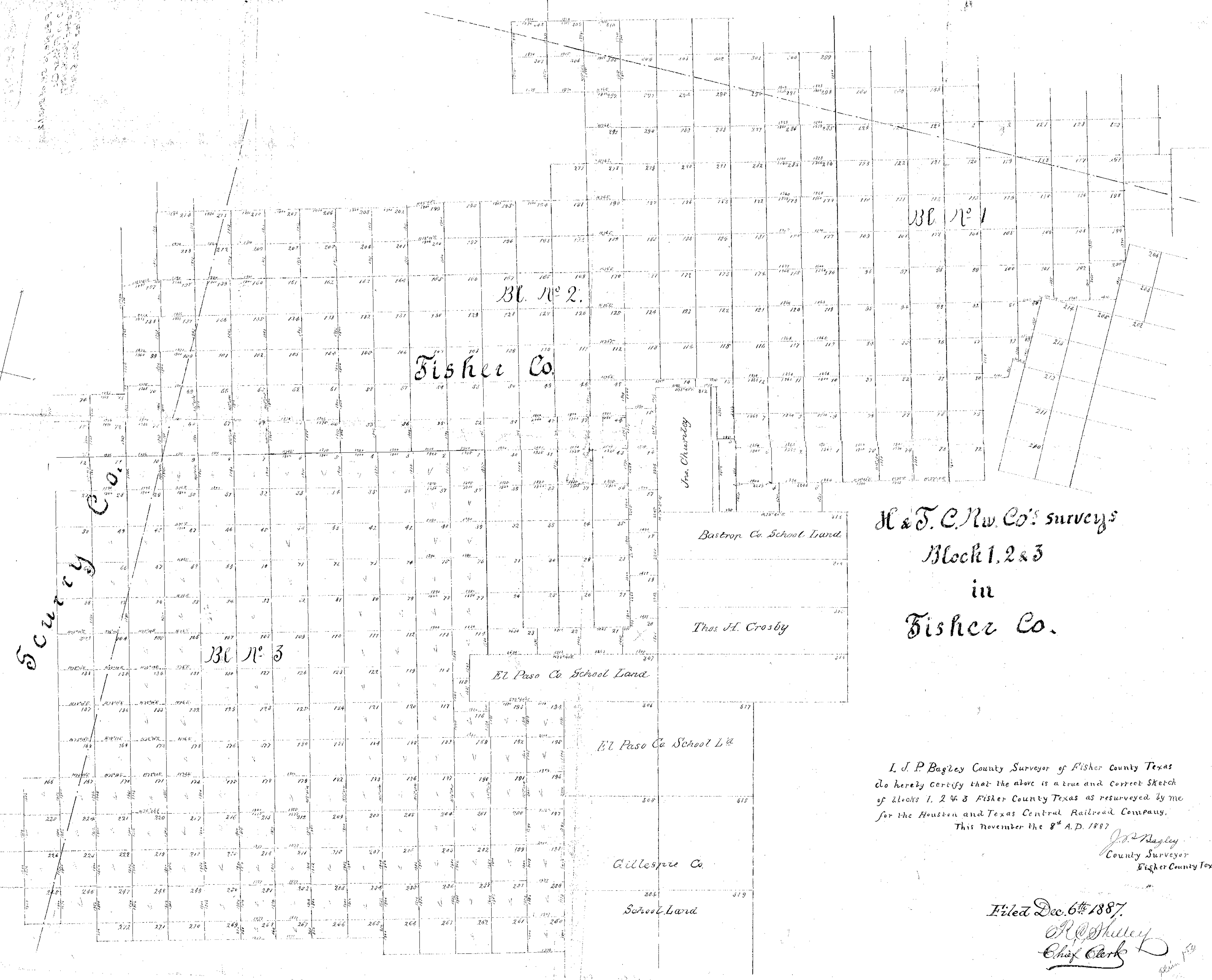

H & T. C. R. Co.'s surveys
 Block 1, 2 & 3
 in
 Fisher Co.

I, J. P. Bagley County Surveyor of Fisher County Texas
 do hereby certify that the above is a true and correct sketch
 of blocks 1, 2 & 3 Fisher County Texas as resurveyed by me
 for the Houston and Texas Central Railroad Company,
 This November the 8th A.D. 1887

J. P. Bagley
 County Surveyor
 Fisher County Texas

Filed Dec 6th 1887

R. W. Shulley
 Chief Clerk