

JAMES B. WELLS SURVEY

TEXAS CITY

NORMAN HURD SURVEY

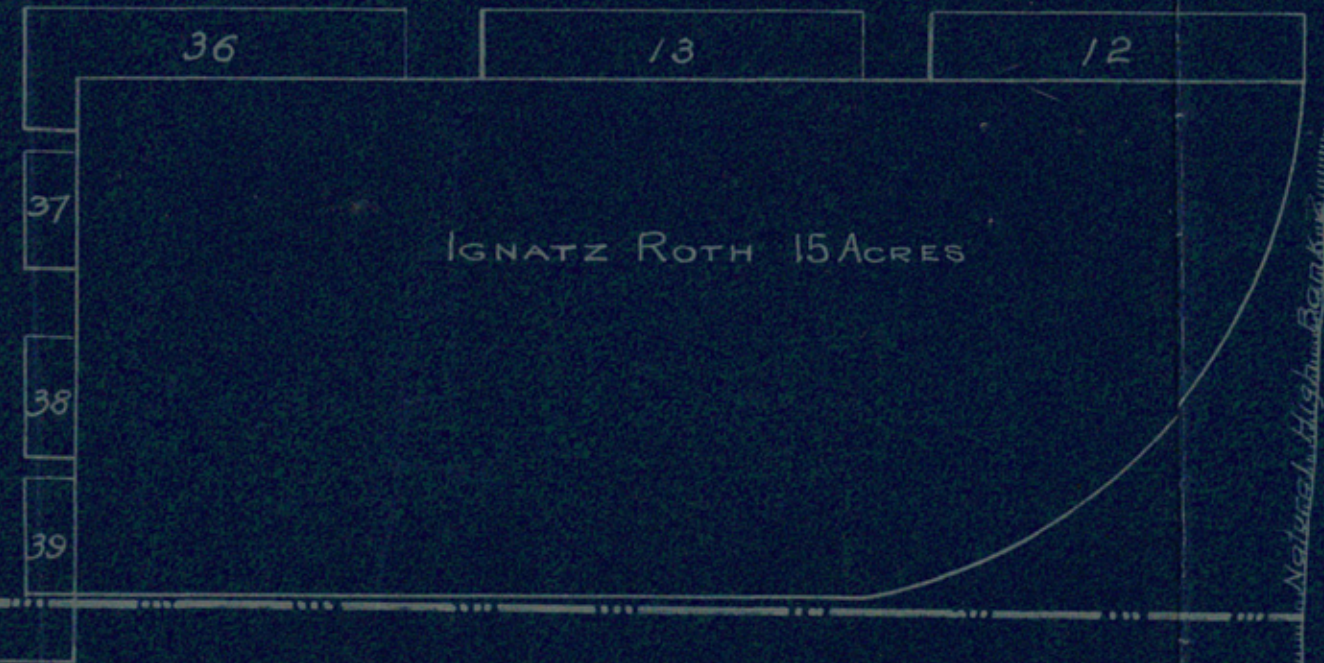

SURVEY of CLAY SPOIL BANKS  
 FOR  
 Mr. A. E. NEWMAN  
 By virtue of his application filed in Book H,  
 Page 123, County Surveyor's Record,  
 Galveston County, Texas.  
 Dated July and Aug., 1915.  
 R. M. Sias,  
 COUNTY SURVEYOR.

Scale 1" = 200' or 72 Vs.

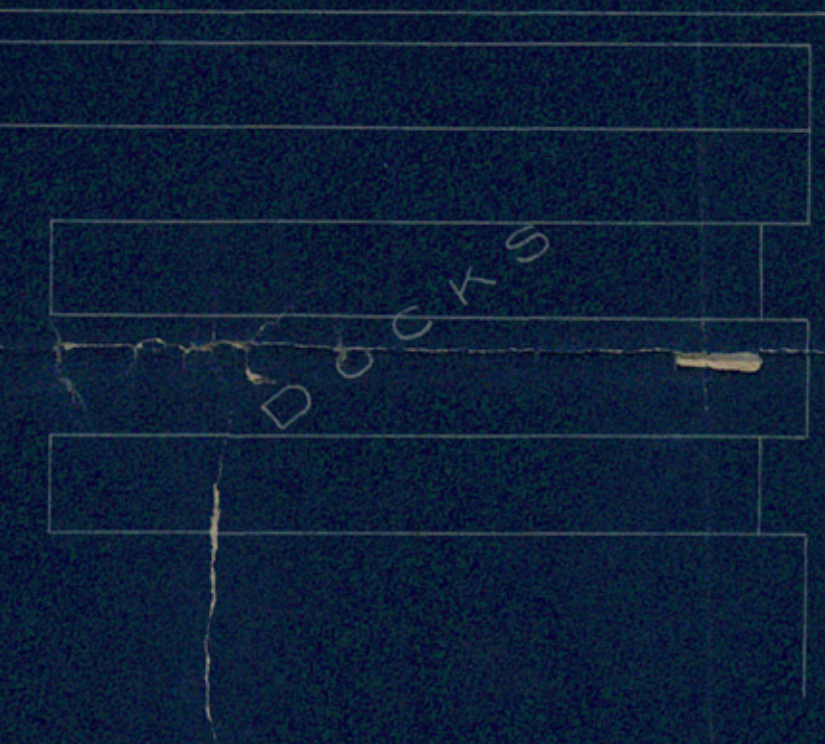

STATE OF TEXAS, Aug. 12, 1915.  
 COUNTY OF GALVESTON, I, R. M. Sias, County Surveyor of Galveston County, Texas,  
 do hereby certify that the foregoing survey was made by me on the ground  
 and according to law and that the limits, boundaries, and corners well  
 marked with natural and artificial are truly shown hereon.  
 R. M. Sias  
 County Surveyor Galveston County, Texas.