

S. Castillo

N. Mitchell

H. S. T. C. R. R. Co.
N^o 82



W. Whitmira

A. Nantz

T. F. N. O. R. R. Co.
N^o 49
N. Abiler

Variation 8° 15' E.

83

84

95

47

96

46

Geo. W. Johnson

101

A. A. Joiner

1856
T. F. N. O.
R. R. Co. N^o 75
1841

Ben Richardson
League

Elisha Pruitt

Scale 4000 per inch

N^o 4

Handwritten notes in blue ink: "27262" and "171"

K

L.P.

2

2500 4000 box incip

Best Richardson
Treasurer

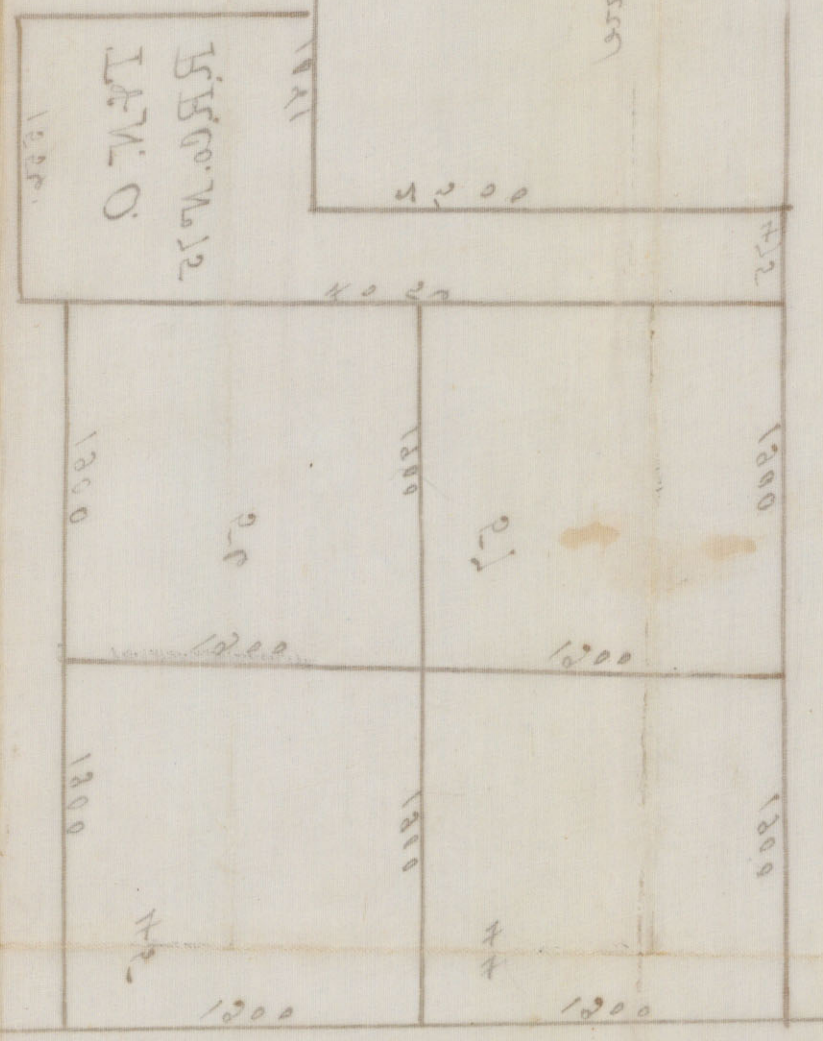

SK. 18
17
JASPER

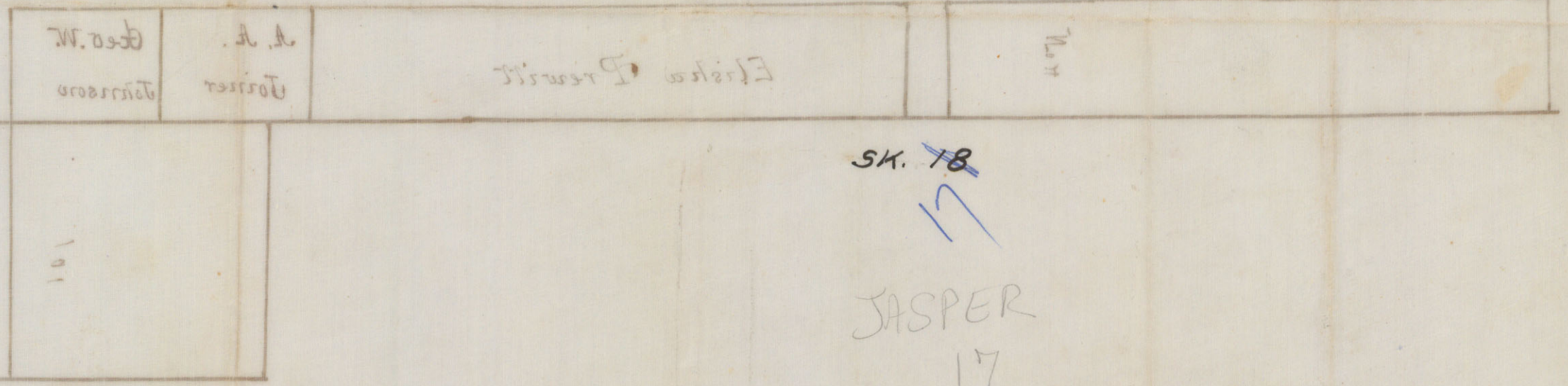

variation 1. 12 E.

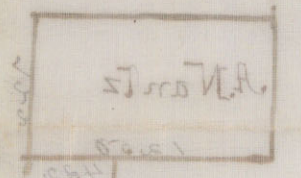
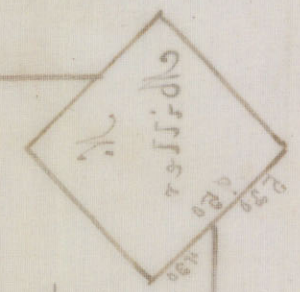
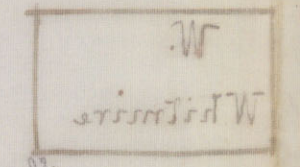

W. W. Turner

No. 10
J. I. Turner

J. I. Turner

J. L. S. Scarborough County Surveyor
of Jasper County do hereby
Certify that - I have found and
identified the south east corner of
the forfeited league survey in name
of Stephen Jones and ran and
measured the south boundary line
N. 75° W. to the N. E. Corner of the Louis
Lebrun league - Thence ran south
on E. line of Lebrun's league to his
south east corner and found the
measurement - as given by Wm Armstrong
who surveyed the H + Y. C. R.R. Co lands
to be correct - I also find the most
western N. W. Corner of Section No 152
to be on the south boundary line of
the Louis Lebrun league 1570 rods
from its south east corner - and south
of that point 265 rods I found the
south west corner of section No 152 and
North west corner of section No 146

This March 18th 1886

J. L. Scarborough
County Surveyor

F. C. Ratchiff } Chain
J. O. Thompson } Measures
Jasper County Exes

Recorded in Book P Page 110

I L. Scarborough County Surveyor
of Jasper County. do hereby Certify
that I have ~~been~~ run and measured
from the N.W. corner of section No 83
A & G. C. R. survey, on the E line of
the W. Mitchell Survey East- 3800 Varas
Thence South 1900 Varas - Thence East- 1770
Varas - Thence South 254 Varas and
intersected the South boundary line of
A. Mahaffy's 160 acre survey
This March 18th 1886

L. Scarborough
County Surveyor

F. C. Ratcliff } chain
J. C. Thompson } rears

Jasper County Texas

Recorded in Book D. page 109.

I L. Scarborough County Surveyor for
Jasper County do hereby Certify that -
I began at the South east-Corner of
L B Sandy's Survey + South west-Corner
of Section No 25. on north line of H
Webb's League. and ran and measured
east on north line of H Webb, M Flores
and J. M. Madras leagues 5700 varas and
found S.W. Corner of Section No 49 -
I then ran North 860 varas and found
Corner on south line of A. Wright's
160 acre Survey - I then ran west on
wright's south line 140 varas and
found S.W. corner of said Wright's Survey
This March 18th 1886

I L. Scarborough

County Surveyor

Jasper County Texas

F. B. Ratcliff } chain
J. O. Thompson } Revers

Recorded in Book D Page 109

Q12

I L. S. Scarborough County
Surveyor of Jasper County do
hereby certify that the north west
boundary line of the W. S. Pearce
Survey situated in Jasper County
on the waters of Big Creek and joining
the A. C. Palmer, only measures
1820 varas instead of 1900 varas, as
called for in original field notes

This March 19th 1886

L. S. Scarborough
County Surveyor
Jasper County Texas

Recorded in book D page 109

17

Jessie County

Connections

18-
Filed March 27/86

D. M. Robinson
Chap. 1. 1886

QT4