

I, C.B. Linn, Depl. Sur of Oklahoma District of
 County Sur of Moore County, do hereby
 certify that this sketch truly & correctly
 represents the survey shown, as
 determined by a survey made by me
 upon the ground.
 Witness my hand this 7th day of Nov 1902
 C.B. Linn
 Depl. Sur of Oklahoma Dist^{ct}
 County - Moore County
 Examined & approved *M. Warner*
 District Sur, Oklahoma

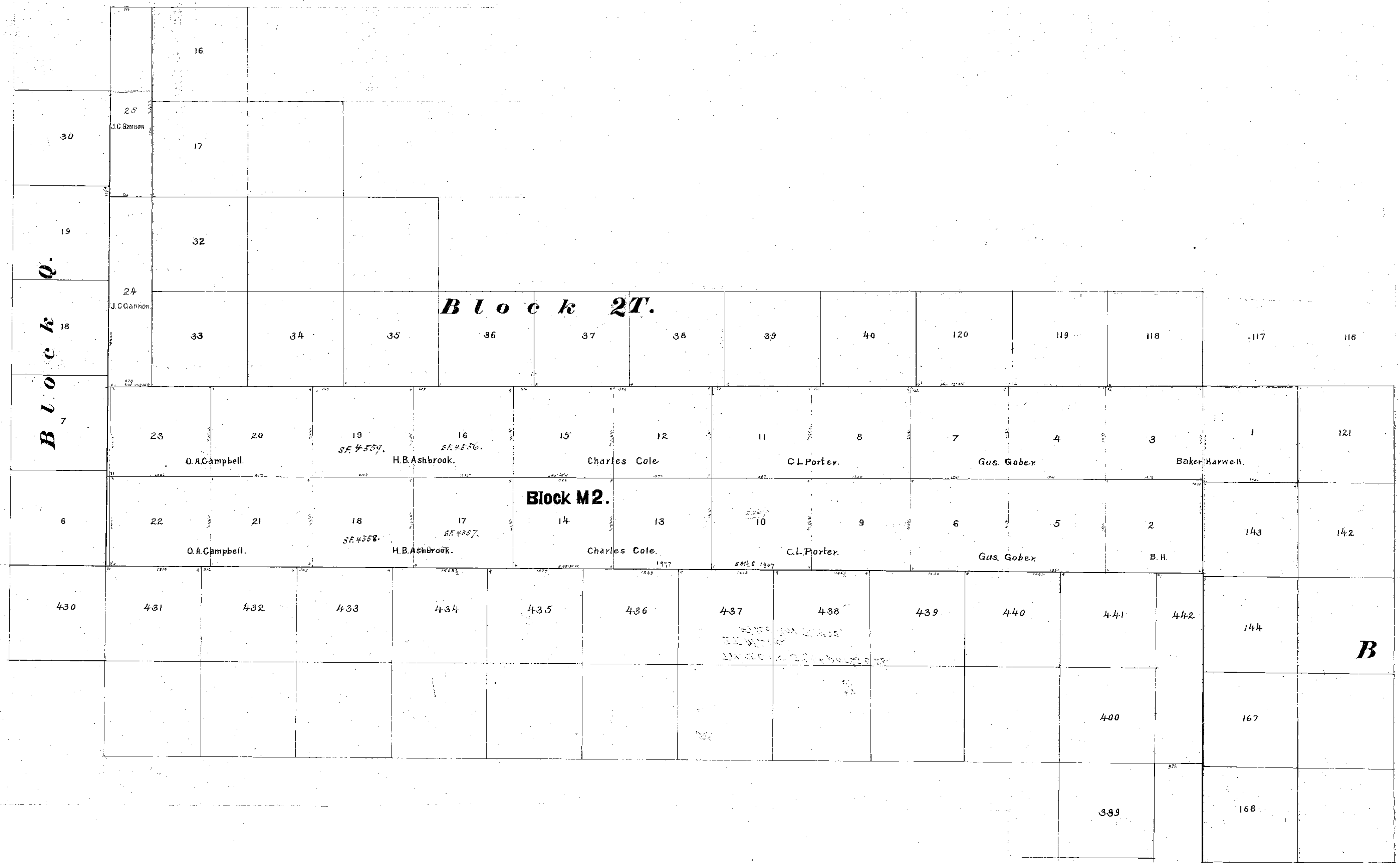

Ch X
 D. F. Fitchell State Surveyor
 under 20th 1902.
 Registrar
 Commissioner