

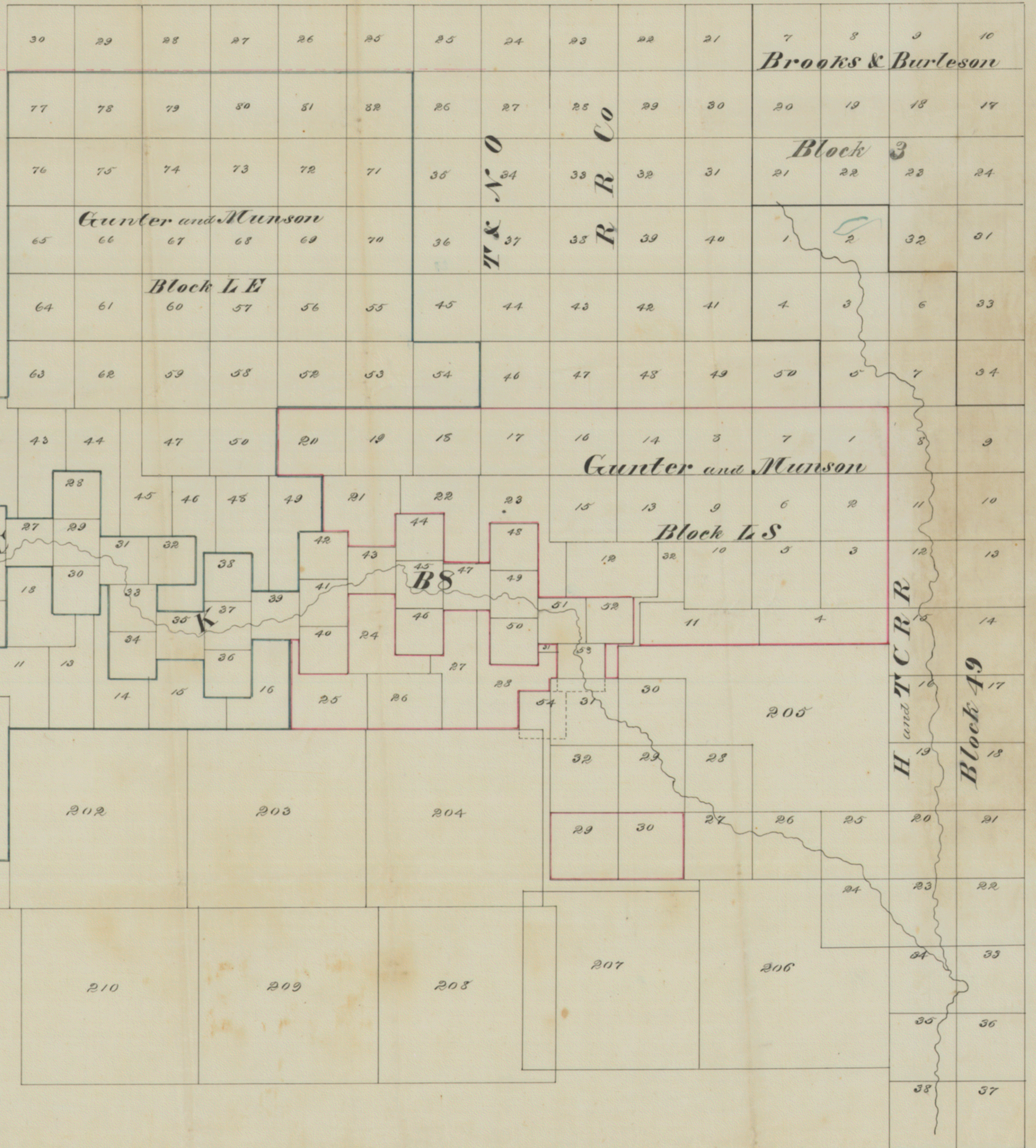

I H S Mabry Surveyor Oldham County, do hereby certify that the sketch below, shows the true positions of Capital Leagues with reference to Blocks 49 H & S R R Co and also Block 40 R. Witness my hand this 4th day June 1853
 H S Mabry
 Surveyor Oldham Co



Copy of Original Sketch
 filed June 17/53.
 Genl. Land Office Austin Nov 24/53.

per Auditor Bro & Andrews
 per 24/53