

Showing Lands taken up inside of the
 Memphis El Paso and Pacific Railway Reserve
 by the Texas and Pacific Railway Company.
 Lands taken up marked
 Scale,
 5000 yards to the Inch

Handwritten notes in the top right corner, including the number '10' and some illegible cursive text.

Vertical handwritten notes on the right side of the map, including the number '10' and some illegible text.

H.C. Johnson

*J. L. Johnson
H. L. Johnson
C. Johnson*

*June 17, 1876
Tenn. 10, 8*

#10

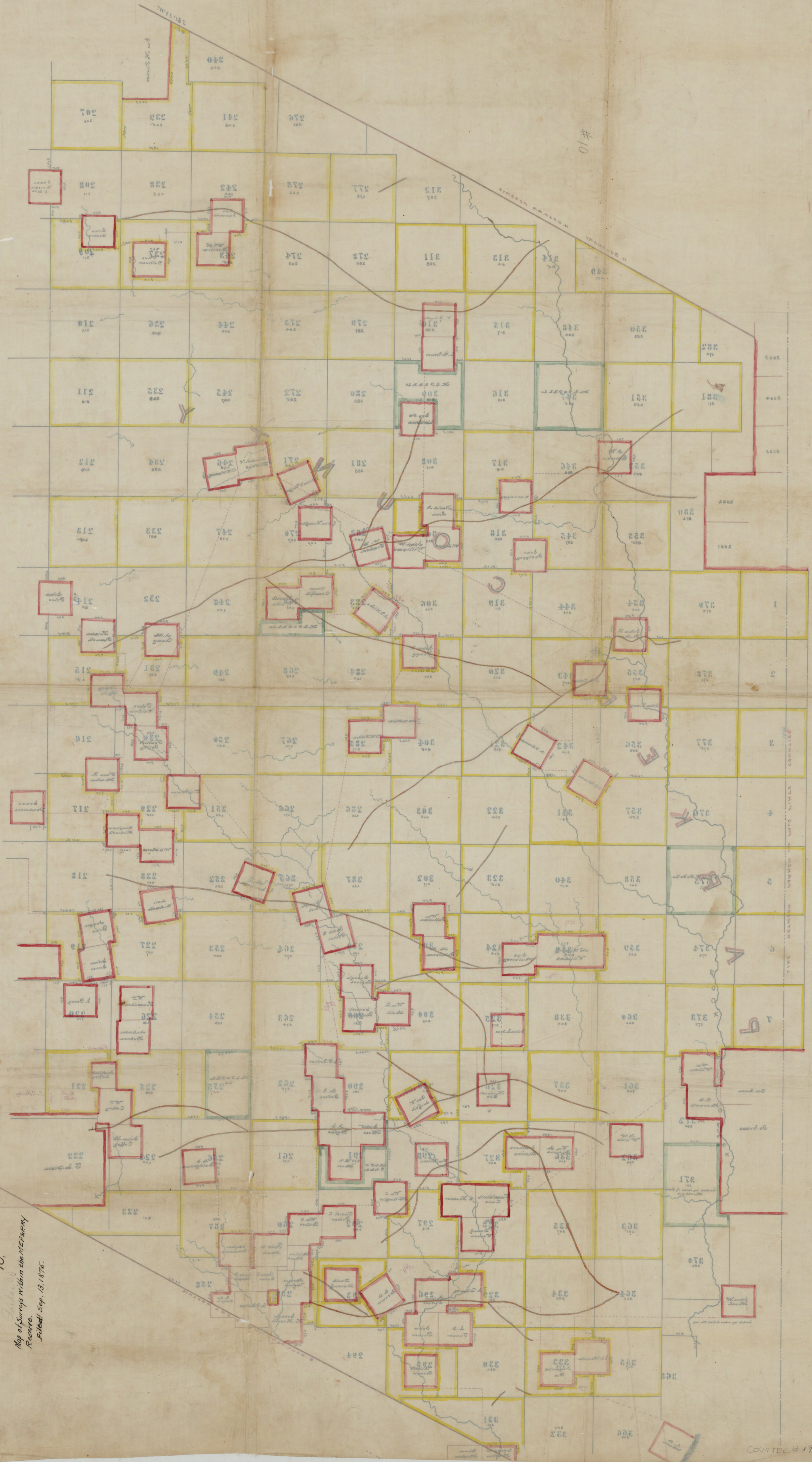

*2000 acres in the year
Cable
In 1876 the
of the tract and the
of the tract and the
of the tract and the*

10.

*Map of Surveys within the MEADSBURY
RECORD.
Filed Sep. 13, 1876.*