

file # ~~10815~~
 Angelina County
 Survey of 1858
 1. 110 E. 18th of Houston
 2. 125 E. 15th of Houston
 Surveyor's Statement & St.
 Sub. on Ang & Clinch River
 25th. S&SE & E&SW
 Sub. near Neches River
 21th. S&SE & E&SW

[Faint, mostly illegible handwritten notes on lined paper, possibly bleed-through from the reverse side.]

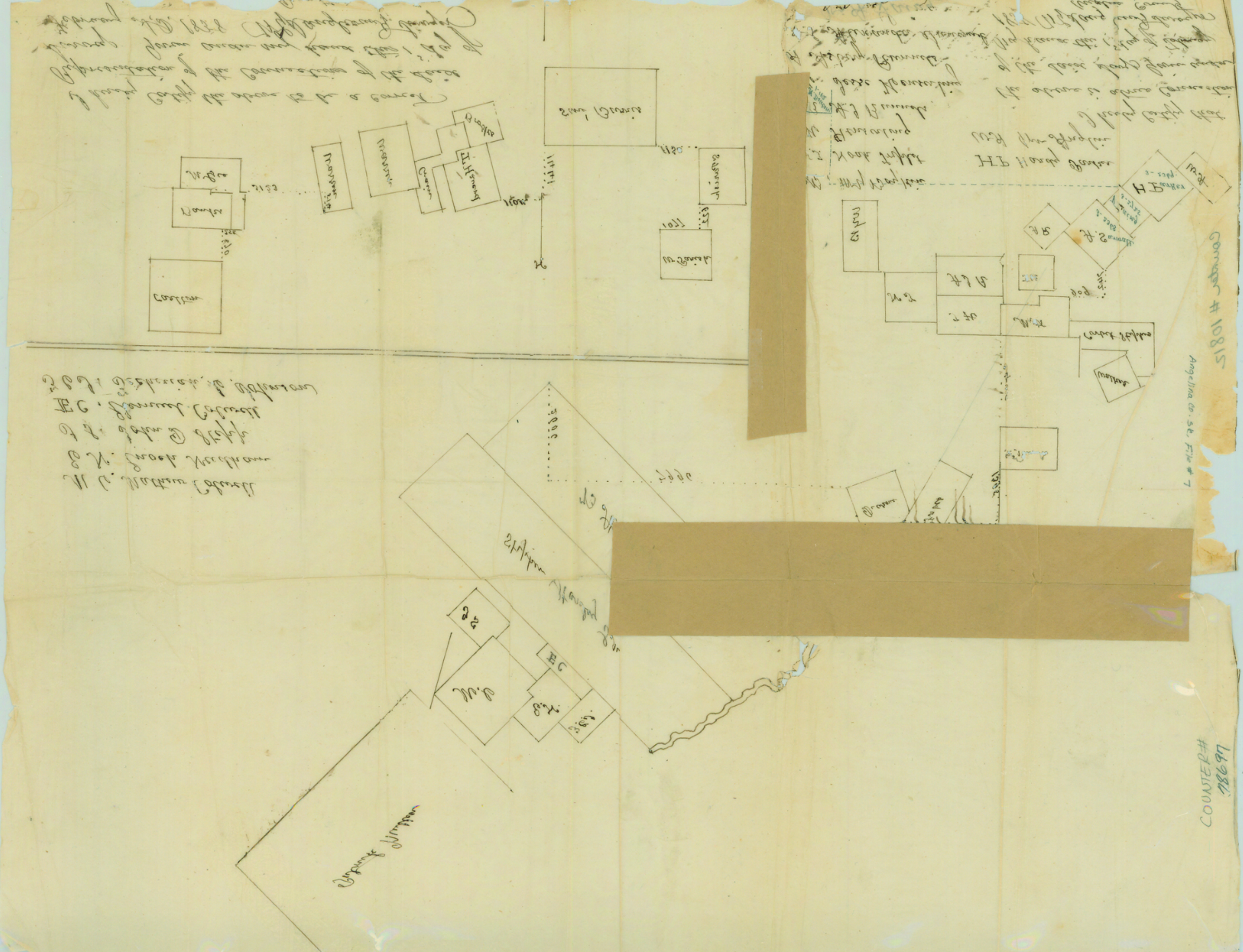

Counter # 10815
 Angelina Co. St. File # 7

Counter # 18697