

7th Mill - Superior City

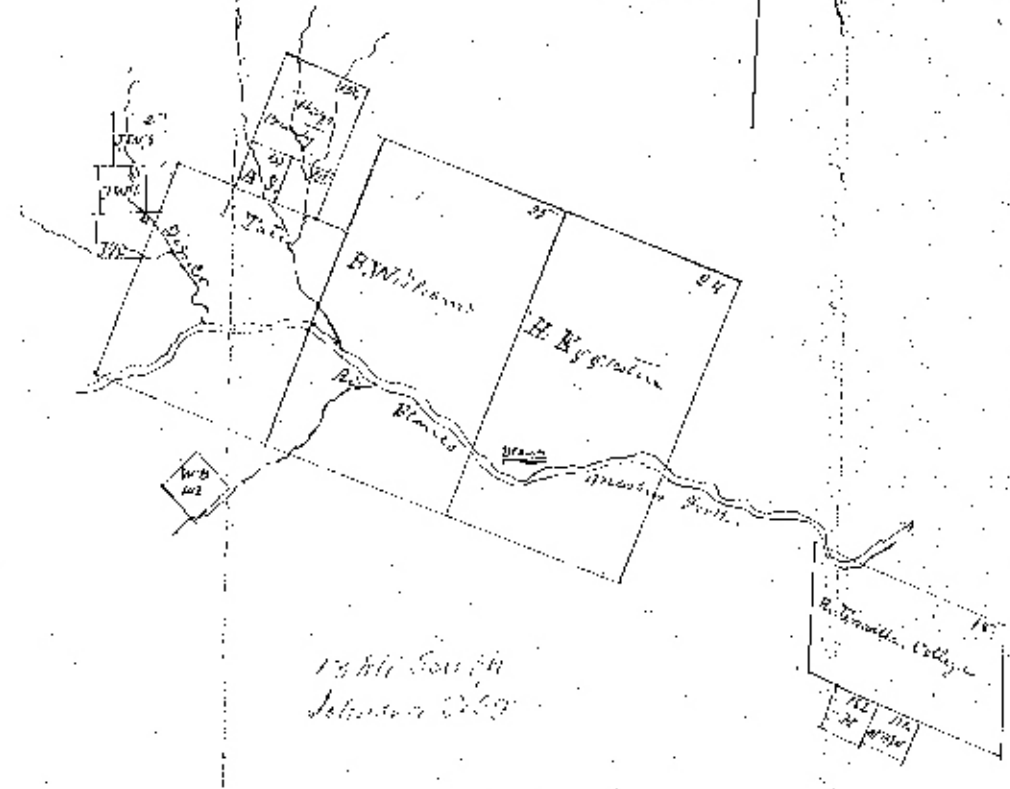

13th Mill - Superior City

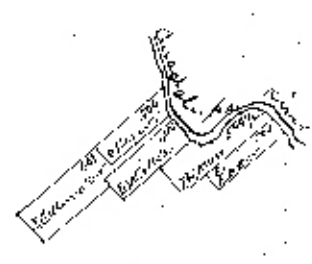

Scale 4000 ft to the inch - Blaine 100 ft

I, John M. Watson, Surveyor of Blaine  
hereby certify that the above sketch  
of water, drawn by me up to quarter ending  
May 1st 1861.

J. M. Watson  
Sur. Blaine Co.



COUNTER # 78888

File 16

SK File No. 16.  
Blanco County  
Sur. May 21/61

Surveys on Blanco R. 13 Mi. S. Johnson City.  
Sur. on Perdennia R. 7 Mi. W. Johnson City.

Sketch  
of survey  
of Co  
May 16

Filed May 21  
61 at Post