

scale of 2000 fts. to the inch

COMPLER # 10522

General Land Office
 Austin, Texas, Dec. 4th 1896
 I, Andrew J. Baker, Commissioner

of the General Land Office of the State of Texas do hereby certify that this sketch shows the surveys represented hereon, the same being situated in Brazoria County, as compiled from the original field notes of said surveys now on file in this Office.

In testimony of which I have hereunto set my name and have caused the seal of my office to be attached on the date above mentioned

Andrew Baker
 Commissioner

SKETCH FILE NO. 32 (1 of 3)
 COUNTY Brazoria

Brazoria Co. 2K FINE # 33

Sk. File No. 32.
Brazoria County
Office Sk. of surreys between
Chocolate & Flores Bayous
Dated Dec. 4th, 1896.

3 of 3



Carter 78921



Dated December 1858.
 Charles S. Brown
 Office of Surveyor General
 Brazoria County
 2d. File No. 32.

3073

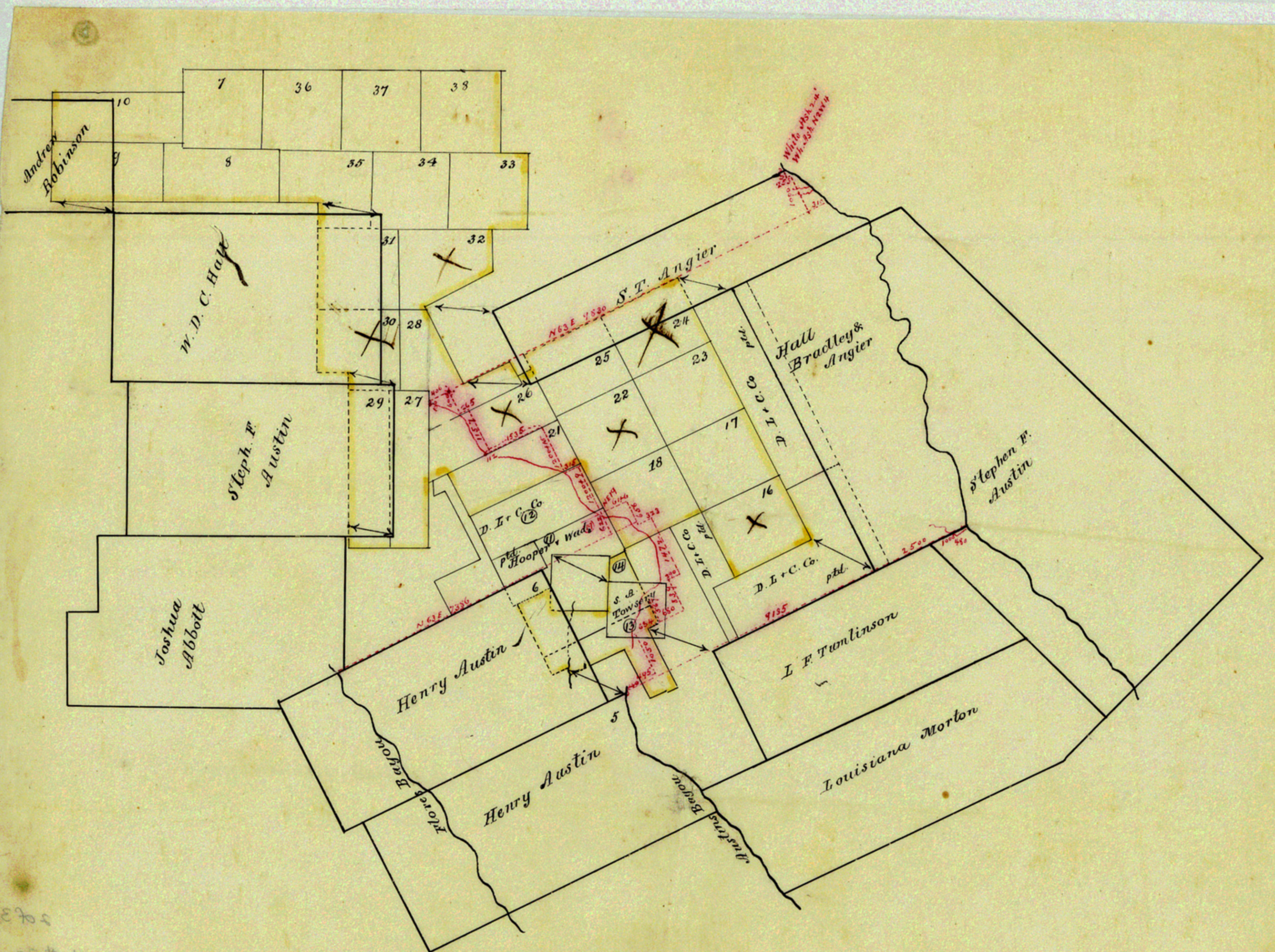

Brazoria Co. SK. File # 32
 283

COMPTON # 10828