

Surveyed & Mapped by  
 John Stovell, Brewster County Surveyor  
 Scale 1000 Fts. = 1 inch.  
 Var. 12°00' E  
 May 1, 1941.  
 Alpine, Texas.

MAP RECORDED BOOK CFN-3 PAGE 183.

PLAT OF SURVEY  
 MADE FOR  
**STEVE L. STUMBERG**  
 ALPINE, TEXAS

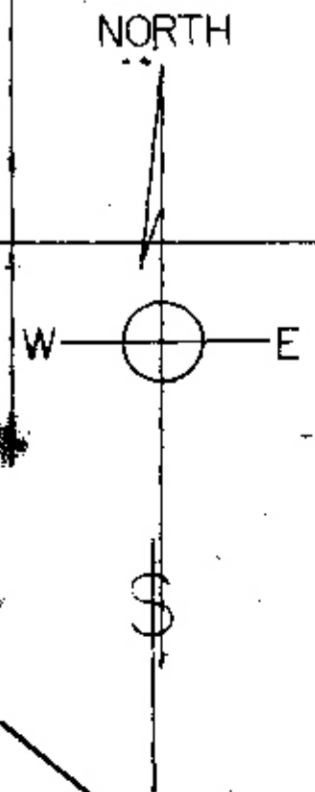

SKETCH FILE No. N-20  
 COUNTY Brewster

Sketch of Stumberg Ranch  
in Blocks 156 and 7  
Brewster & Pecos Counties

Survey made  
May 1, 1941  
and filed  
June 15, 1941  
for  
Block 156 and 7  
in the Stumberg Ranch Survey  
Brewster & Pecos Counties

ALPINE TEXAS  
STEVE L. STUMBERG  
MADE FOR  
PLAT OF SURVEY

North  
File No. 20  
Brewster-Pecos County  
Parts of Blocks-155-6-7  
Steve L. Stumberg Ranch  
Filed \_\_\_\_\_, 19\_\_\_\_  
BASCOM GILES, Com'r  
[Signature] File Clerk