

Scale 500 in

Oliver

Dick

Marsh

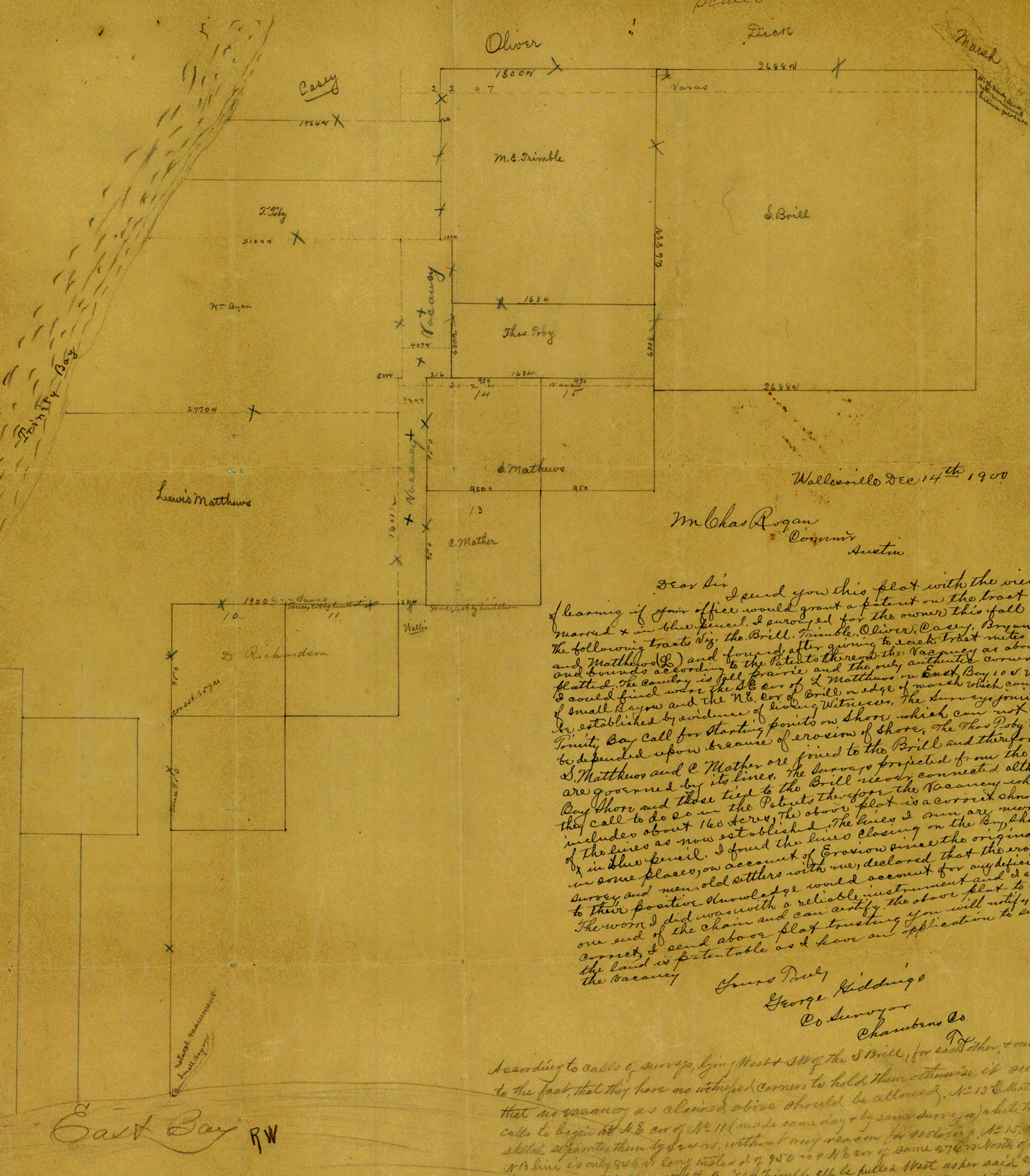

Wallerillo Dec 14th 1900

M. Chas Rogan
Comm'r
Surtm

Dear Sir I send you this plat with the view of learning if your office would grant a patent on the tract marked x in blue pencil. I surveyed for the owner this fall the following tracts viz. the Brill, Trimble, Oliver, Casey, Bryan and Matthews (L) and found after giving to each tract notes and bounds according to the patents thereof, the Vacancy as above platted. The country is all prairie and the only authentic corner I could find was the S.E. cor of S. Matthews on East Bay 10 & W. of small Bayou and the N.E. cor of Brill on edge of marsh which can be established by evidence of living witnesses. The surveys joining Trinity Bay call for starting points on shore which can not be depended upon because of erosion of shore. The Thos Tobey the S. Matthews and C. Mather are joined to the Brill and therefore are governed by its lines. The survey projected from the Bay shore and those tied to the Brill never connected although they call to do so in the Patents therefore the Vacancy which includes about 160 acres. The above plat is a correct showing of the lines as now established. The lines I run are marked in blue pencil. I found the lines closing on the original survey and men old settlers with me, declared that the erosion to their positive knowledge would account for any deficiency. The work I did was with a reliable instrument and I carried one end of the chain and can certify the above plat to be correct. I send above plat trusting you will notify the land is patentable as I have an application to survey the Vacancy

Yours Truly
George Kidding
Co Surveyor
Chambers Co

According to calls of survey, lying West & SW of the S Brill, for each other, & owing to the fact that they have no untraced corners to hold them otherwise, it seems that no vacancy as claimed above should be allowed. N-13 S. Mather calls to begin at N.E. cor of N-11 (made same day & by same surveyor) while this sketch separates them by 2000, without any reason for such a distance. N-15 Mather's N-13 line is only 926.00 long instead of 950.00 + N.E. cor of same 974.00 North of S Brill's S.E. cor. Now if N-13, 14 & 15 & the Brill & Trimble all be pulled West as her said calls there would be no space as shown on this sketch East of Bryan & Lewis Matthews
12/22/1900 Hill

East Bay RW