

County Line

Motley County

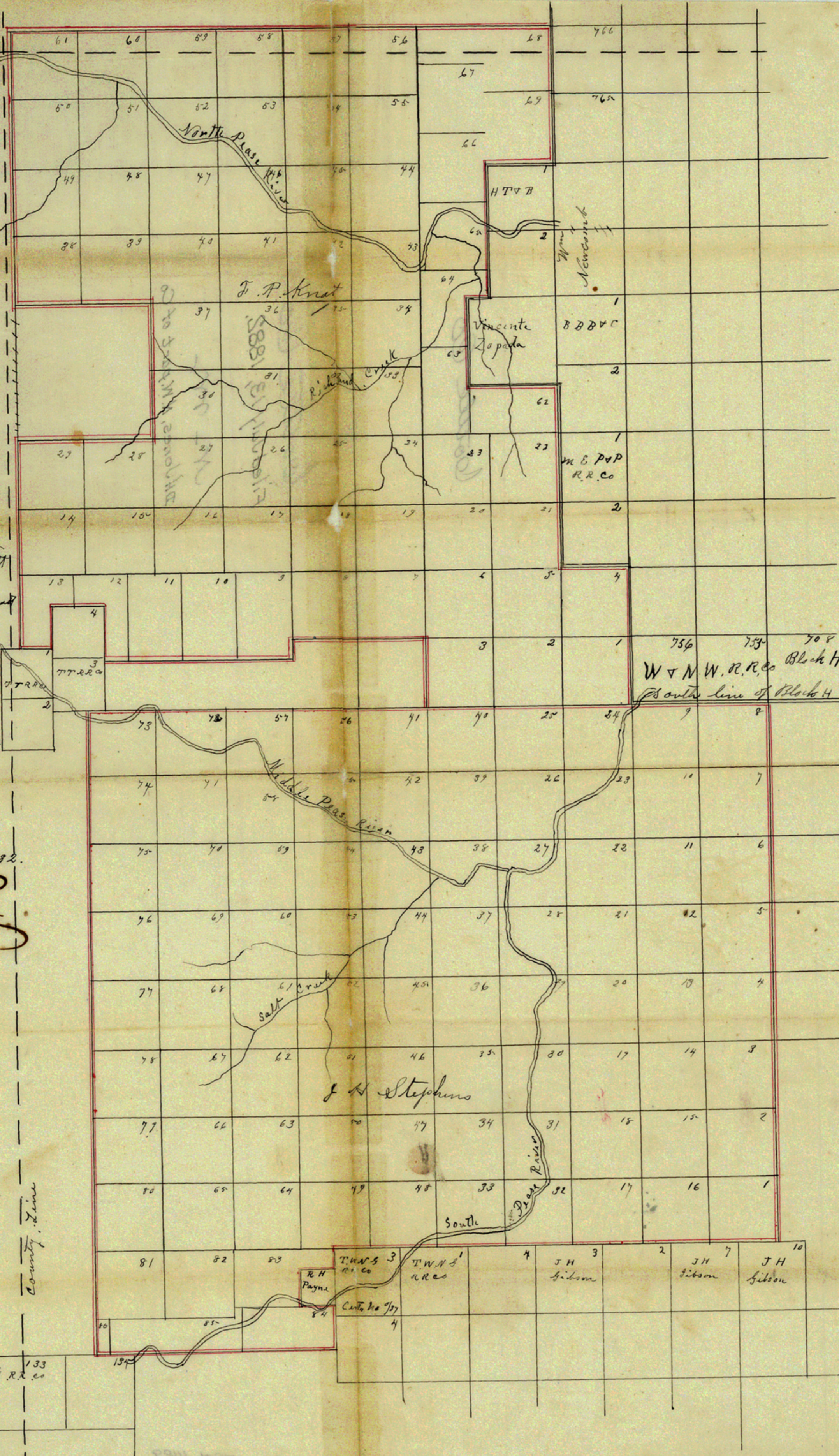

I D H Jones do hereby  
 Certify that the foregoing <sup>plat</sup> is a true representation of  
 Lands surveyed for F.P. Knut  
 & J.H. Stephens lying in  
 North west part of Cattle  
 County Tex. ab. July 5<sup>th</sup> 1882

D H Jones  
 Surveyor of  
 Baylor Land District

Scale 2000 ft = 1 inch

Filed July 13<sup>th</sup> 1882.

*Rhoads Fisher*  
 C.S. & Co.

See sketch by  
 R.M. Kenney filed  
 9/19/02

Xo

SKETCH FILES NO. 1  
 COUNTY CATTLE

CATTLE CO  
 100  
 100