

13A

C. B.
Cannon

Garwood C.

Anglin

Collin Co.

See Pac City - to Keymer

Otto P.O.

S. 16160

B.L.O.

B.L.P.

Counter
19419

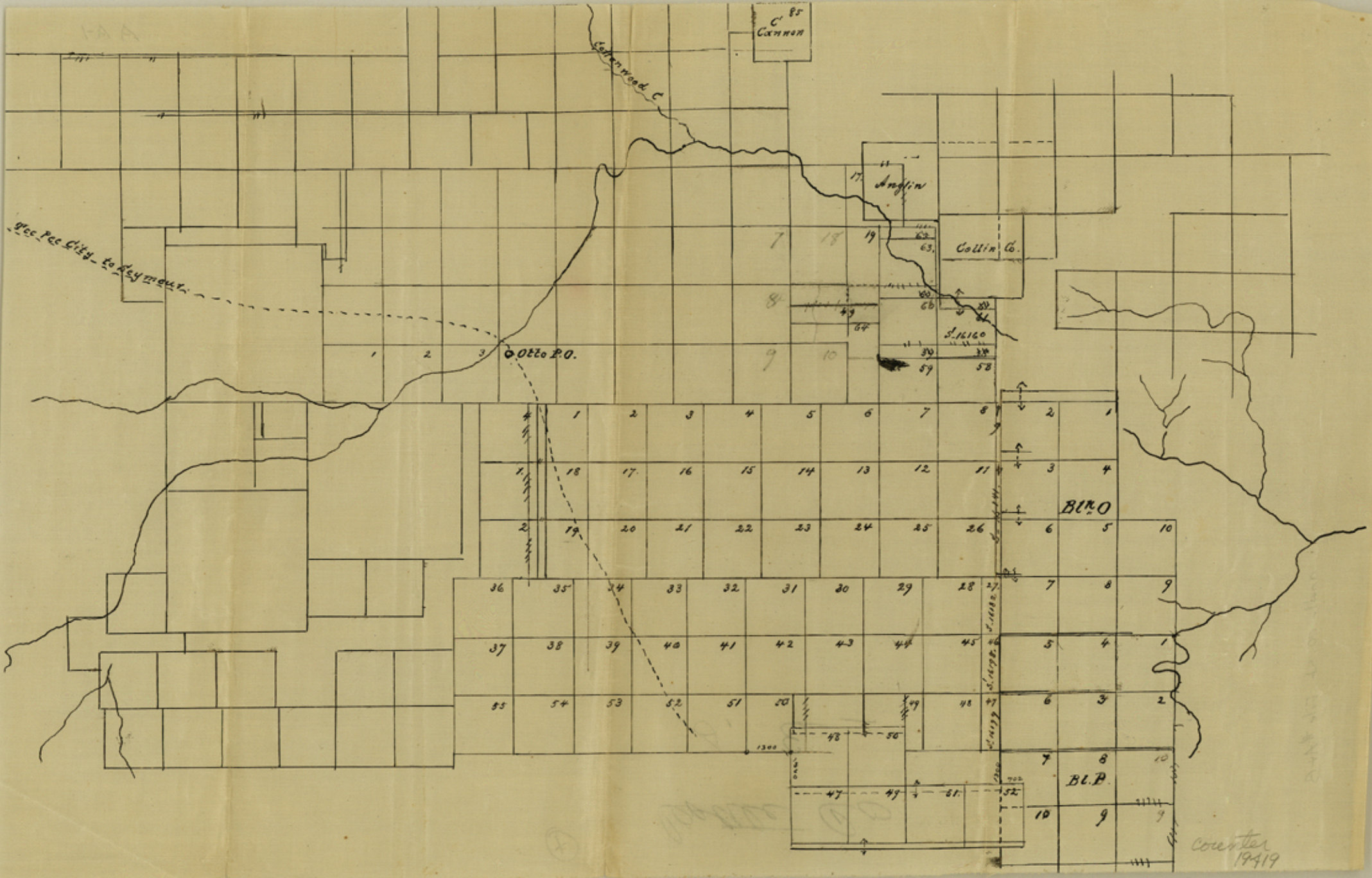

Ver. 10, 9

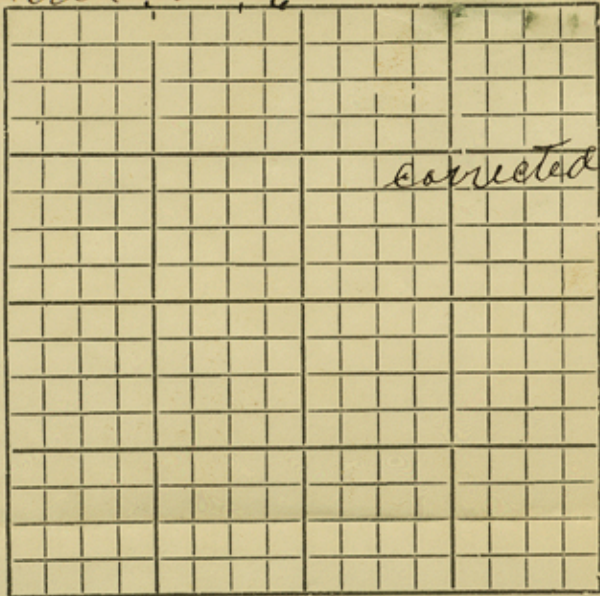

The State of Texas, } SURVEY
Seattle County. } No.

FIELD NOTES of a Survey of connecting line
between the S.E. cor. lands made for
of Sec No 35 blk B for a
forestry and the S.E. cor
of the J. G. Dulaney
Home Stead Survey

Scale _____ Varas per inch.

Said Survey is No. _____, in Seattle County, Texas, situated on the waters of

S Reese a tributary of Red River, about 8 miles N
of Paducah Beginning at S.E. cor of Sec No

35 for a forestry a set stone marked
A from which a cypress wood 24 in in
diameter standing below Owl Springs
Brz N 18 W 260 thence to at 1900 vms a
stone marked K the S.W. cor of said No
35 and at 3800 vms nothing found for cor
and at 5700 vms a stone marked K for
the S.W. cor of Sec No 33 a forestry
thence north at 1900 vms nothing found
for cor at 3800 vms a stone pile one marked
K for S.W. cor of Sec No 3 for a forestry
and at 5700 vms a stone Mc the S.E. cor of a
sur made for B. F. Brather and now sur
No 1 for A. D. Swearingen thence continuing
north at 1313 vms a stone Mc the S.E. cor of
sur No 2 for said Swearingen and at 3558 vms
a stone Mc the S.E. cor of the J. G. Dulaney Home
stead survey as corrected to the place of beginning

Bearings marked _____

Surveyed June 24th 1900

Jerry Gruppitt
George Sullivan } Chain Carriers.

I, O. Lombest Co Surveyor
of Seattle County, Texas, do hereby certify that the foregoing described Survey was actually
made by me on the ground, according to law, on the date and with the Chain Carriers aforesaid, duly qualified, and
that all the corners, lines, boundaries and marks of the same, whether natural or artificial, are truly and correctly
described and set forth in the foregoing Plat and Field Notes.

By _____ Deputy _____
O. Lombest
Sec. Surveyor of Seattle County, Texas.

Filed for Record the _____ day of _____ 189 _____ }
at _____ o'clock _____ M. } Surveyor.

Recorded in Book No 3 Page 291

712

703

662

661

1900 vrs

704

1900
00

1863

1/26

1704

49

60

648

705

670
665

1900
00

1313

1900

48

W & N R R Co
Blk A

J. J.
Bulancy

699

47

706

1900
00

2245

1900

A. Forsythe

707

1900
00

762

1900

46

1313

796

1

2

1/26

3

4

16

17

1900

18

19

31

32

1900

33

34

35

1900

1900

1900

Filed in General Land
Office Sept. 18th 1900
Wise

