

64,509  
57,200  
7,309  
1854

Runnels  
Co School  
Land

The State of Texas }  
Marion County }

I, *W. G. Bassin* Deputy Justice of the Peace  
do hereby certify that I have examined the courses and distances  
represented in this sketch actually upon the ground  
and that the courses and distances represented on the  
sketch are true & correct.

Witness my hand this 10th  
day of November 1850  
*W. G. Bassin*  
Deputy Justice of the Peace

*J. L. C. Navarro* J. P. do  
do hereby certify that I have examined the foregoing sketch &  
find it correct & that a true  
copy of the same is recorded  
in my office in sketch book  
for *Beaver* *J. L. C. Navarro*  
Nov. 10 1850

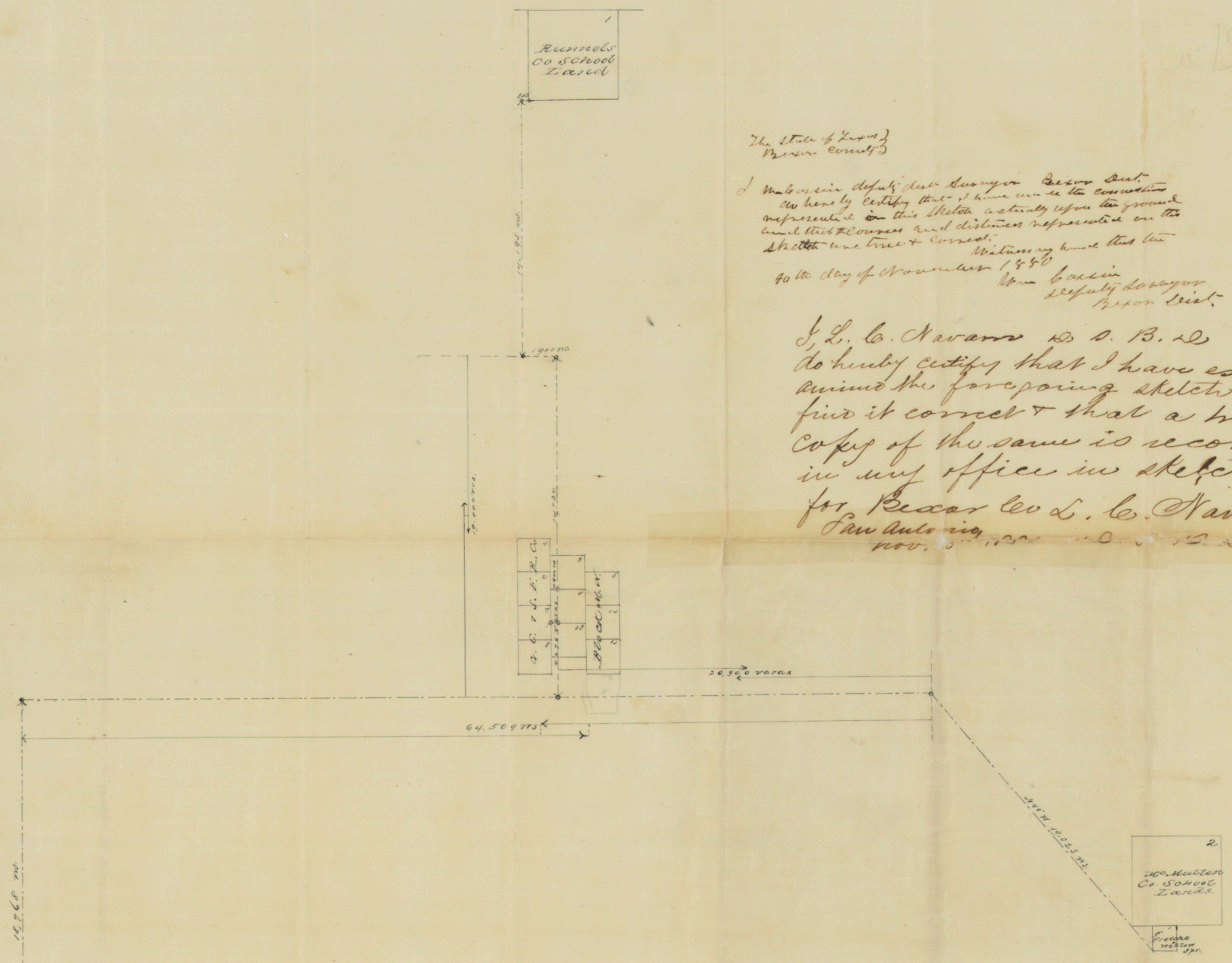

Scale 4000 m per inch  
Variation 10° East

2  
J. C. Muller  
Co School  
Land  
Beaver  
J. P.

5511 # 951005