

Pascosa, Texas, Jan 16 1885

Miss Taylor Babcock  
Chicago

Gents:  
Please find herewith a sketch made to show the difference in the location of the North West corner of the Paw Staudle, as established by two different United States Surveyors.  
It also shows the position of the exterior lines of the Capital lands with reference to the 103<sup>rd</sup> Meridian of W.L. & 36<sup>th</sup> N.L. as established by the U.S. Boundary Com. in 1858 & 1859.  
The Texas Commissioner refused to act with the U.S. Commissioner in the establishment of these boundary lines & therefore Texas may claim that the boundary is still an undecided question. I do not think you would be safe in placing your contemplated fence any west of the 103<sup>rd</sup> Meridian as established by U.S. Com.  
Respectfully W. S. Mabry

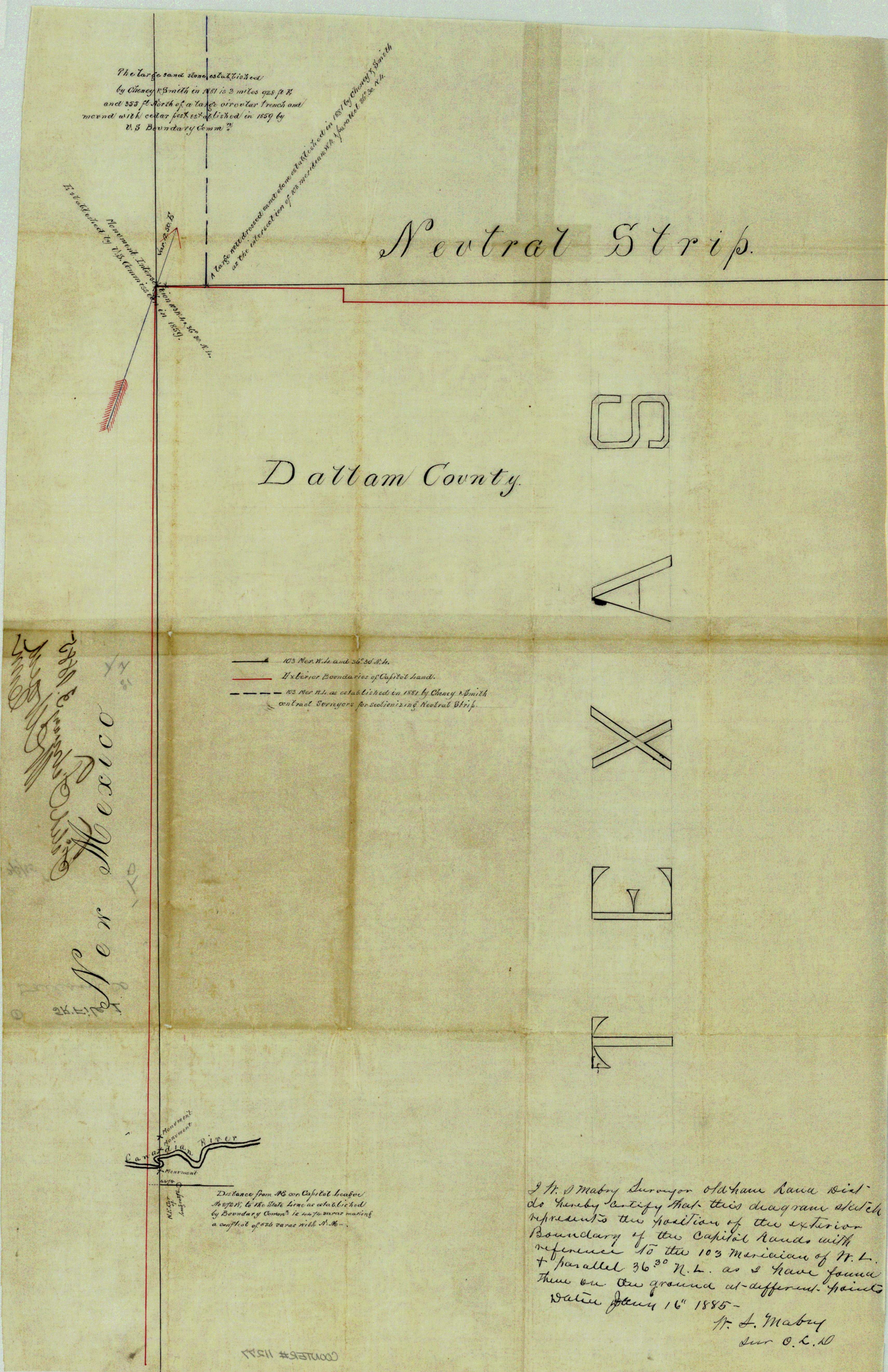

OFFICE OF  
W. S. MABRY,  
SURVEYOR.

Oldham Land District.

COUNTIES OF  
Oldham, Dallam,  
Sherman, Hartley,  
Deaf Smith, Potter,  
Parmer, Castro  
and Moore.

Pascosa, Texas,

January 16<sup>th</sup>

1885

Miss Taylor Babcock & Co  
Chicago

Gents:

Please find herewith a sketch made to show the difference in the location of the North West corner of the Panhandle, as established by two different United States Surveyors.

It also shows the position of the exterior lines of the Capital League with reference to the 103<sup>rd</sup> Meridian of  $W L 4 36^{\circ} 30'$  N.L. as established by the U.S. Boundary Com<sup>y</sup> in 1858 & 1859.

The Texas Commissioner refused to act with the U.S. Commissioner in the establishment of these boundary lines & therefore Texas may claim that the boundary is still an unsettled <sup>question</sup> - but I do not

think you would be safe in placing your contemplated fence any west of the 103<sup>rd</sup> Meridian as established by U.S. Com<sup>y</sup> -

Respectfully W. S. Mabry