

S- 43581-

10000 3000
30 miles

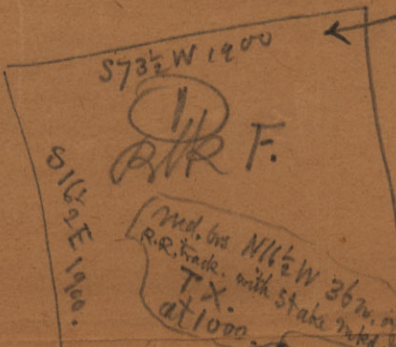

3 1/2 miles
2250 m.

300
5 miles 2 382 m.
Aroya Station

T & P. R. R.

+
88056

CHARLES J. CANDA, SIMEON J. DRAKE AND WILLIAM STRAUSS,
proprietors of the Lands heretofore belonging to
THE TEXAS & PACIFIC RAILWAY COMPANY.

W. H. ABRAMS,
AGENT.

109

DALLAS, TEXAS, July 10-1889.

Recd 7/12/89 -

Hon. R.M.Hall,
Com'r., G.L.O.,
Austin, Texas.

Dear Sir:-

I return herewith your favor of 9th., and in reply would state, that according to the Murray Harris survey for the Texas and Pacific, the distance from Aroya Station (Ward County) to where the 103d. Meridian crosses the T & P.R'y. track, is five miles and 977 Feet, not varas.

Yours truly,

W. H. Abrams,

= 352 varas

+ -



General Land Office.

Rustin, Tex., July 9, 1889. 188

Mr W. H. Abrams,
Land Com'r T & P. R'y Co,
Dallas, Texas.

Sir:- If convenient, please furnish this Office, the distance from Arroya Station of the T & P. R. R. (Ward Co) to where the 103 degree Meridian crosses said Railroad tract as surveyed by Murry Harris. The blue print sketch filed by you Nov, 22, 1886, gives the distance as 5 miles and a fraction in varas, but the fraction is "blurred".

Respectfully,

Commissioner.

(C)

5 Miles & 977 feet

CHARLES J. CANDA, SIMEON J. DRAKE AND WILLIAM STRAUSS,
Proprietors of the Lands heretofore belonging to
THE TEXAS & PACIFIC RAILWAY COMPANY.

W. H. ABRAMS,
AGENT.

DALLAS, TEXAS, July 31-1889.

Hon. R.M.Hall,

Com'r. G. L. O.,

Austin, Texas.

Dear Sir:-

In reply to yours of 26th. would state that we make the distance, from West Head Block of siding or switch at Donro Station to center of siding at Donro Station $30,87/100$ miles, as measured along center line of T & P.R'y. Station number at center of siding at Donro is #5612, and Station number of West line of T & P. land surveys in Block 44 Town 3 South is, as we make it, at Station 5919 plus 50, or say nearly six miles West of Donro. I enclose tracing which may aid you in the matter?

Yours respectfully,

W. H. Abrams

Agent.

88059

~~Ector~~ #3
~~Ward~~ Co

Sketches.

Design of a Ector
to a K. H.

12-11-36
C. F. Blucher