

Filed Nov 23/80



Scale 2000 feet per inch

I will H. Bonnell Dep. Sur. Rec. list
do hereby certify that the above is a
true & correct plot of the connection
between the NW corner of
Survey No. 14 in the name of the
State of Texas. & the south west
corner of survey No. 9 in the name
of the Gulf Water, Soc & R. C. R.

I Will H. Bonnell Deputy Surveyor
 Resear District do hereby certify that the foregoing is
 a true & correct plat of the Connection between
 the North West corner of Survey no. 14 in the name of
 the State and the South West corner of Survey no. 9 in
 the name of the G. W. S. & P. R. R. Co.
 The connection being from the N.W. corner of
 Survey no. 14 -

Thence North 208 ns.
 Thence West 967 ns.
 to the S.W. cor. survey
 no. 9 - The corner of
 no. 9 being found upon
 the ground & the corner
 of no. 14 being estab-
 lished by running out
 connections according
 to plat - from East
 bank of Muced River

Will H. Bonnell
 Deputy Sur Bea Dist.

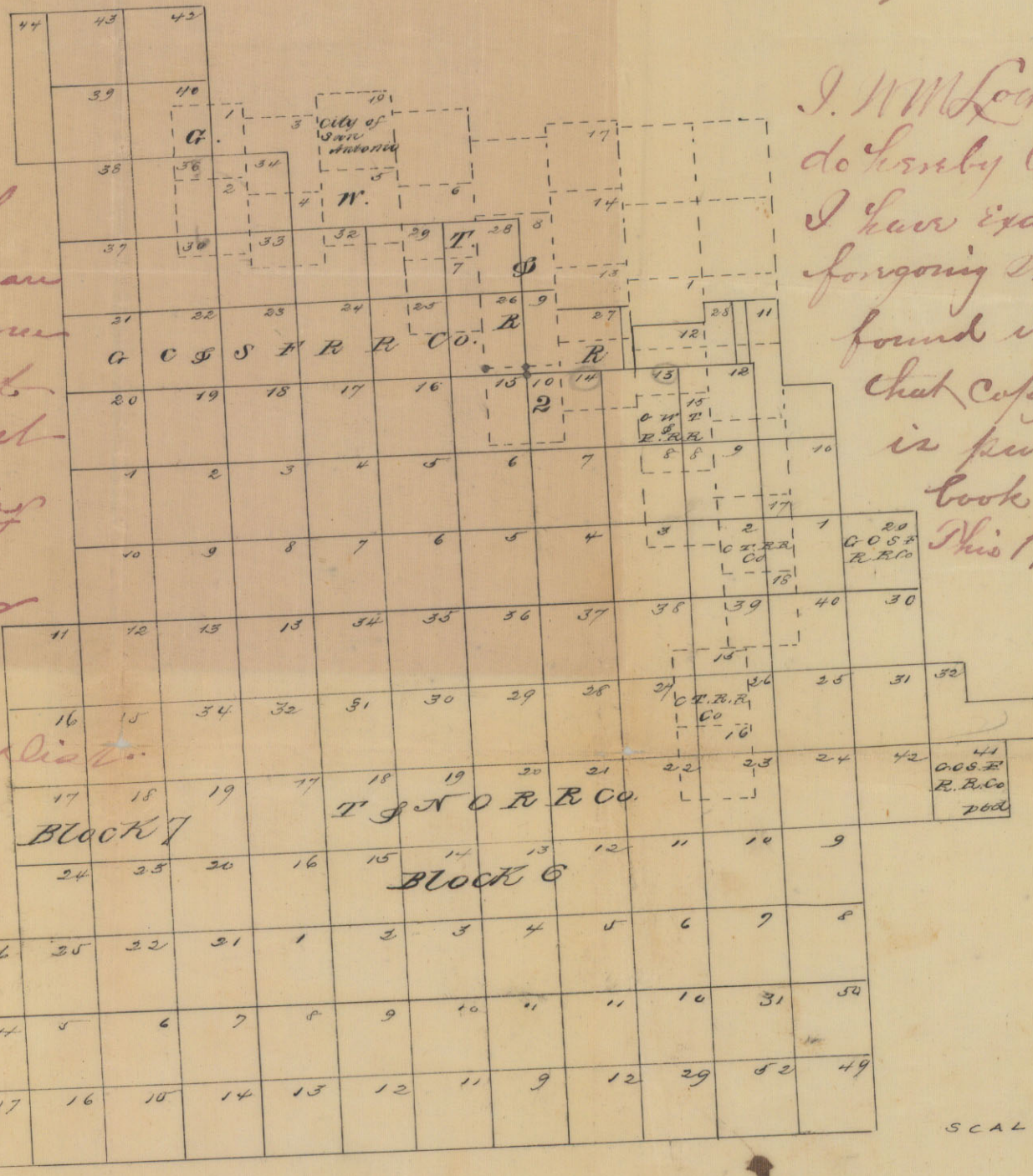

I. W. Locke & S. B. Bab
 do hereby certify that
 I have examined the
 foregoing sketch and
 found it correct and
 that copy of the same
 is put on the sketch
 book in my Office
 This 19th day of Nov. 1880

I. W. Locke,
 S. B. Bab,

SCALE 4000 VARAS to the Inch
 88061

File "6."
 Edwards County
 Sketches.

Filed by
 Joseph James
 Nov 23/80

Rhoads Fisher
 Chf Clerk

See sketch no. 7 A
 by S. von Rosenberg
 July 1881.

28062

[Faint, mostly illegible handwritten text]

[Faint handwritten notes, possibly a letter or report]

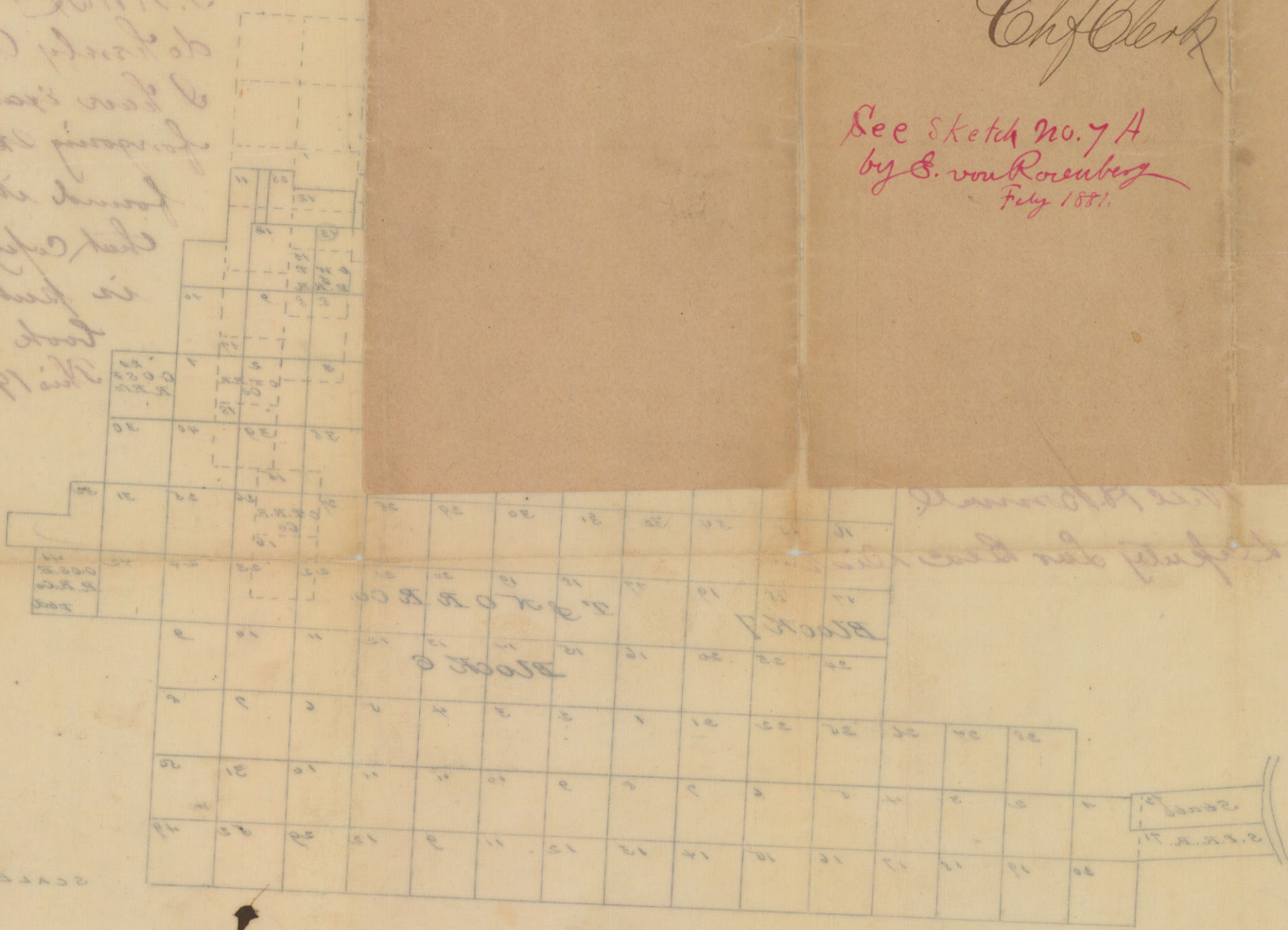

88061
 2000 YARDS TO THE WEST

Edwards Co. St. File #6