

Old Letter File 248189 City and County

(See SK in S. 20005)
See Connection in S 3869

See Vol 10 Texas
Civil Court p. 312
Blum vs B.T. Co.

For meanders of
Pease River see
S-3867
and for connections to
Blocks H & 16 see
S-3869
and connection line
in 1-1799 with
Cundiff Block of
Penny.
C. von Rosenberg
Surveyor

Old Letter File
248189 City and County
(D-1920 to 1926)
(D-1919)
Sketch

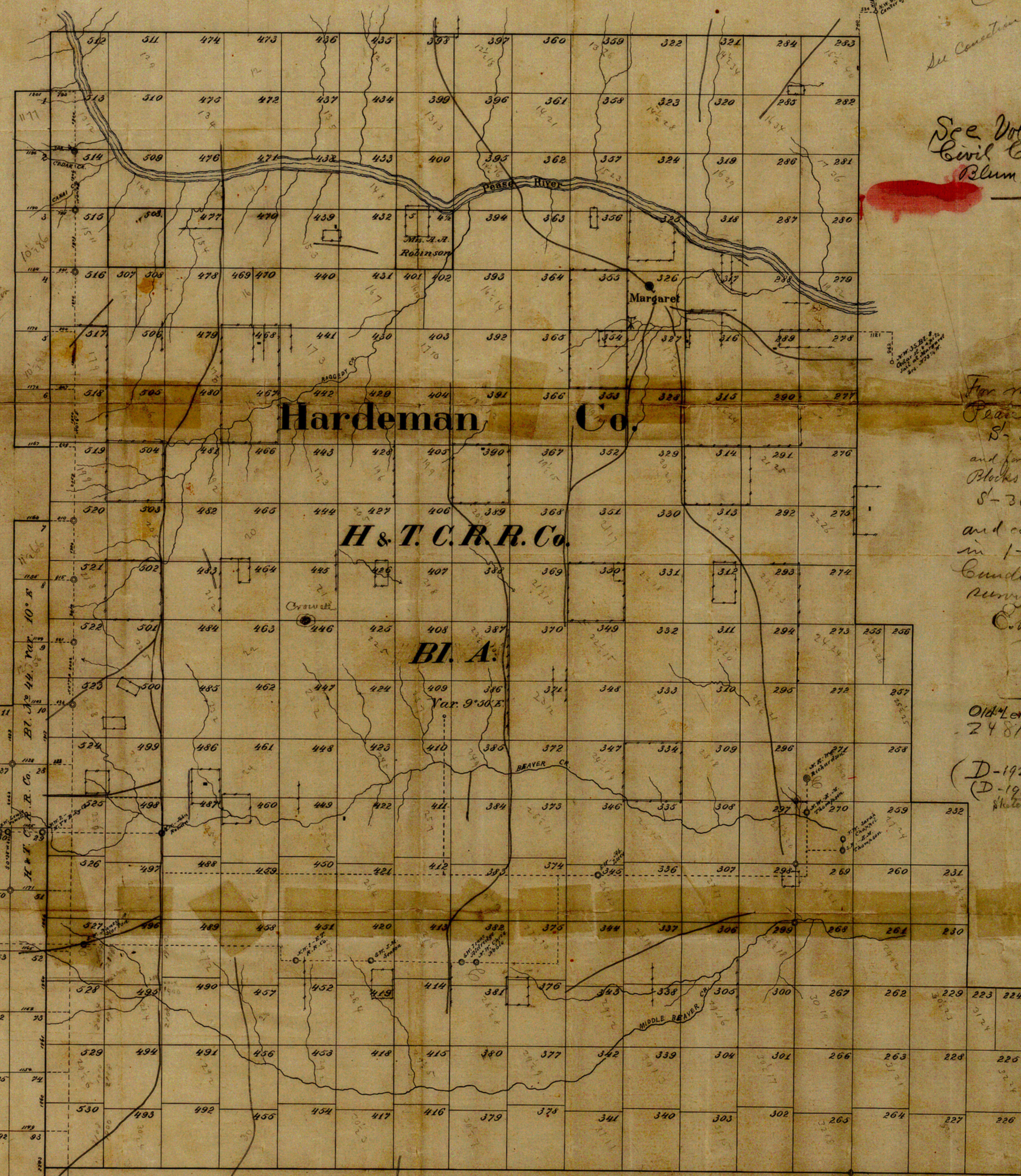

I, R. M. Kenney, State Surveyor, do
hereby certify that above sketch shows
the true and correct position of surveys
represented thereon, as surveyed by
me on the ground.
Dec. 14th 1889.

R. M. Kenney - State Surveyor

Filed March 28th 1890.
R. M. Shulley
Chief Clerk