

N
 Var 11° E

Hardeman Co

Texas

Block
 Connection of same in Conn. No. 2
 1885

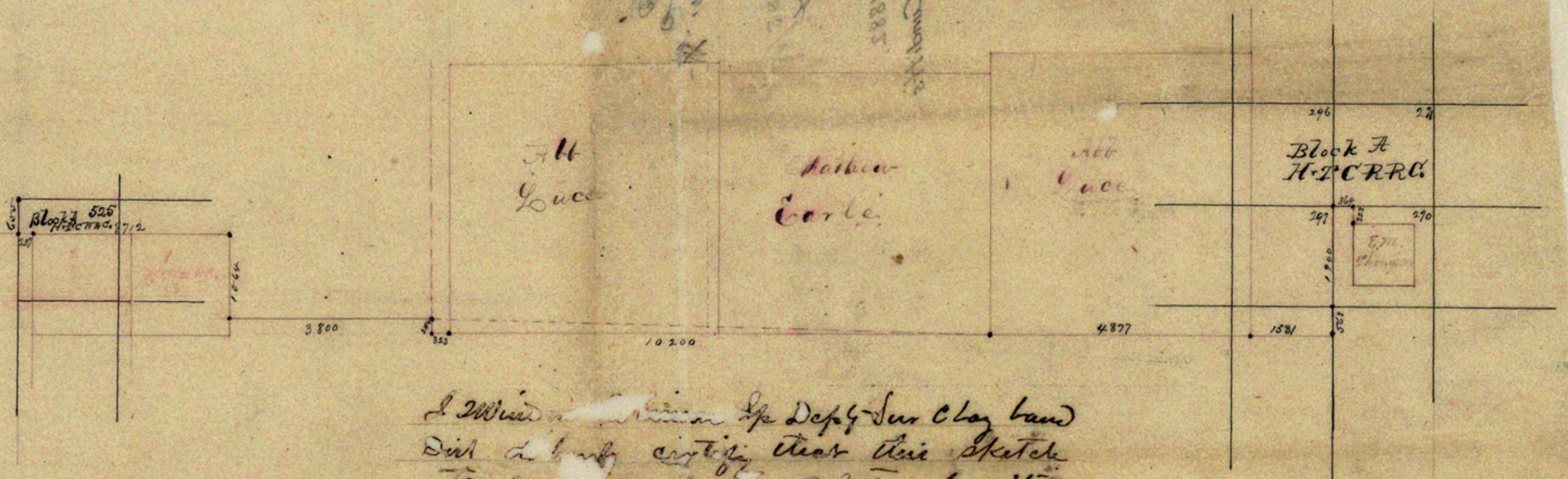

I Windsor Robinson Sr Depty Sur Clay land Dist do hereby certify that this sketch truly represents the relative positions of the Cassiff Survey and those of the H.C.R.R.C. Block ~~525~~ as found on the ground in Hardeman Co Texas.

I Windsor Robinson Sr Depty Sur Clay land Dist

J. E. B. Patterson Surveyor of Relay Land Dist do hereby certify that I have examined the above sketch and find it correct and the same is recorded in my office in book of on page.

J. E. B. Patterson Sur
 Clay Land Dist