

SL No 5

SL No 4

SL No 3

The foregoing Sketch Represents nearly all of the new work that has not been returned to the S. I. Office, the Remainder is in different parts of the County and will be found mapped on the page containing the Field Notes of the several Surveys, those on this Sketch marked in the S. E. Corner of their respective Surveys, are Preemption Surveys, the others are Locations made by Certificates,

Scale of 2000 yards to the Inch

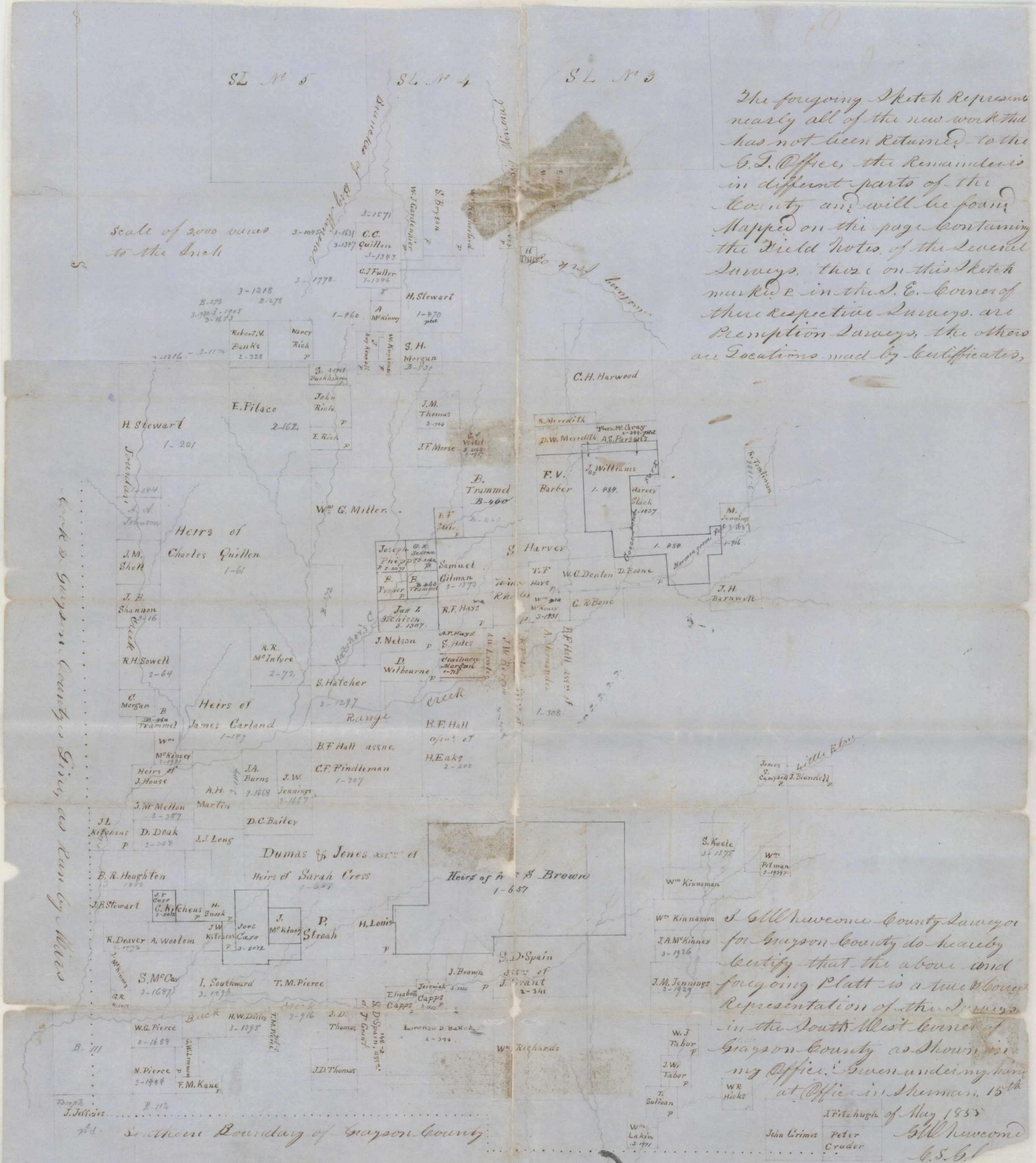

Check to Grayson County's Survey as run by Wm

I G.W. Newcome County Surveyor for Grayson County do hereby certify that the above is a true & correct Representation of the Surveys in the South West Corner of my Office. Given under my hand at Office in Sherman 15th of May 1855
G.W. Newcome
J.F. Fitzhugh
John Grimes Peter Cruder
G.S. Lakin

10

File

File 305

Map of the S.W.
Corner of Grayson
County Texas

Rec'd Jun 14th 1855
Grayson Co.
West of Sherman.
G.W. Newcome's S.K. of Surs.
in SW part of County.
Dated May 15, 1855.
Filed June 4, 1855.

Filed June 4th 1855
Robt. M. Kellogg
C. C. S. L. O.