

Made by
 E.R. Clark,
 Surveyor of Douglas County
 (1904)

See Decree of Court
 in SF 4772
 1004
 1004

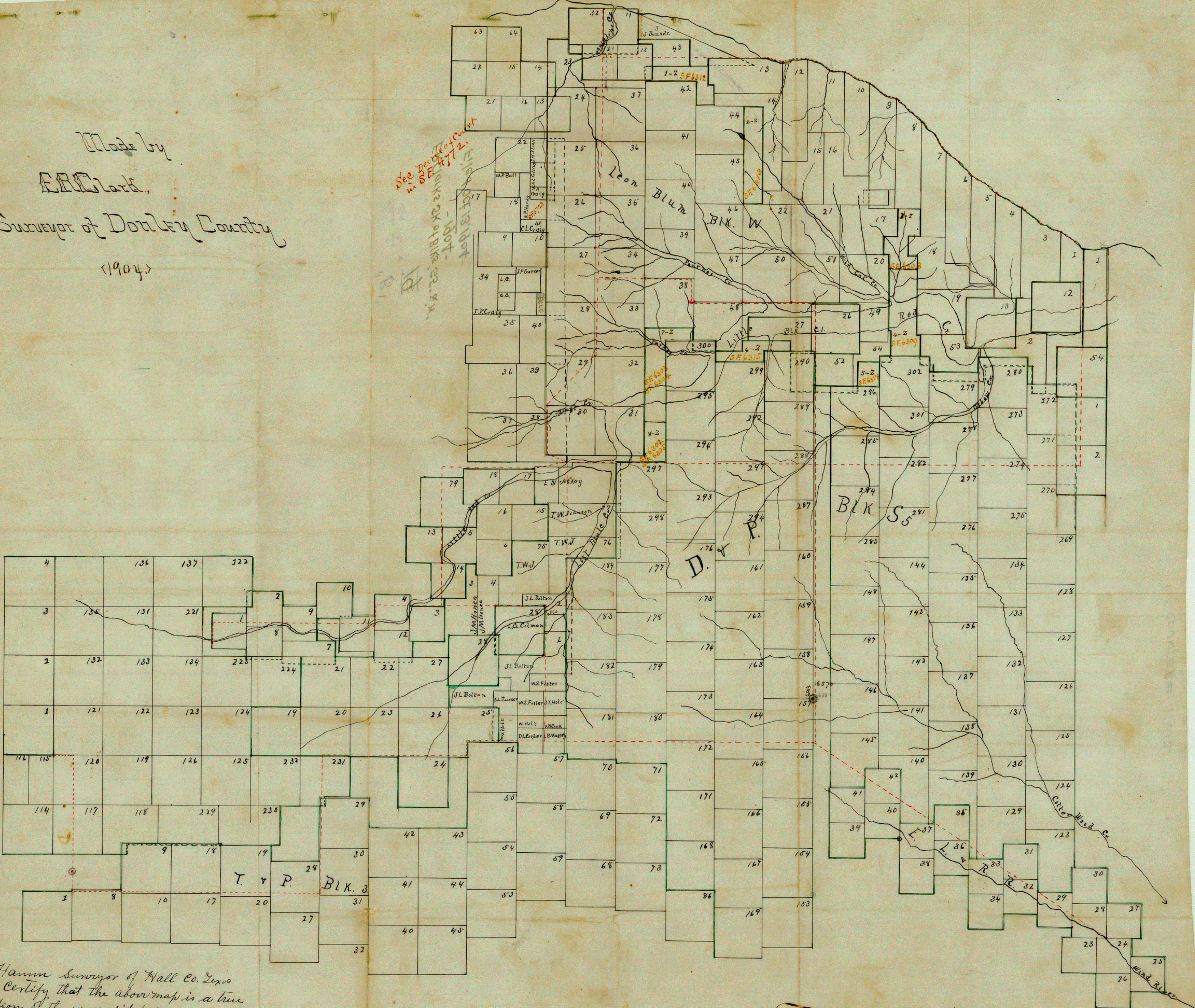

J.C. Hamm Surveyor of Hall Co. Tex.
 do hereby Certify that the above map is a true
 representation of the work did by me and my
 assistants in locating and correcting the surveys
 in Blk. W, Leon Blum & L.G. Coleman surveys.
 This the 19 of Sept. 1904
 J.C. Hamm
 County Surveyor
 of Hall County, Tex.

Sketch "B", Hall Co.
 Sketch files.

Filed October 13th 1904.

John J. Terrell
 Clerk

Examined by P. K.
 von Rosenberg
 May 3, 1905. Draft done