

MAP

Scale, 4000 rods per Inch

* Are Corners, found, and well identified

I, W. J. Glenn, Deputy Surveyor of Presidio County, do hereby certify that the above is a true & correct map of Block No. W. J. G. - 2; W. J. G. - 4; W. J. G. - 7; W. J. G. - 9; & No. 1. of Texas Mexican Ry. Co. and their connections, as made & found on the ground.
Given under my hand this 3rd day of April, 1882, at Fort Davis, Texas.

W. J. Glenn
Deputy Surveyor Presidio Co.

I, E. G. Gleim, Surveyor of Presidio County, have examined the above map, and do hereby approve the same.
Given under my hand, at Fort Davis, this April 3rd 1882.

E. G. Gleim
Surveyor Presidio Co.

W. J. Glenn
E. G. Gleim

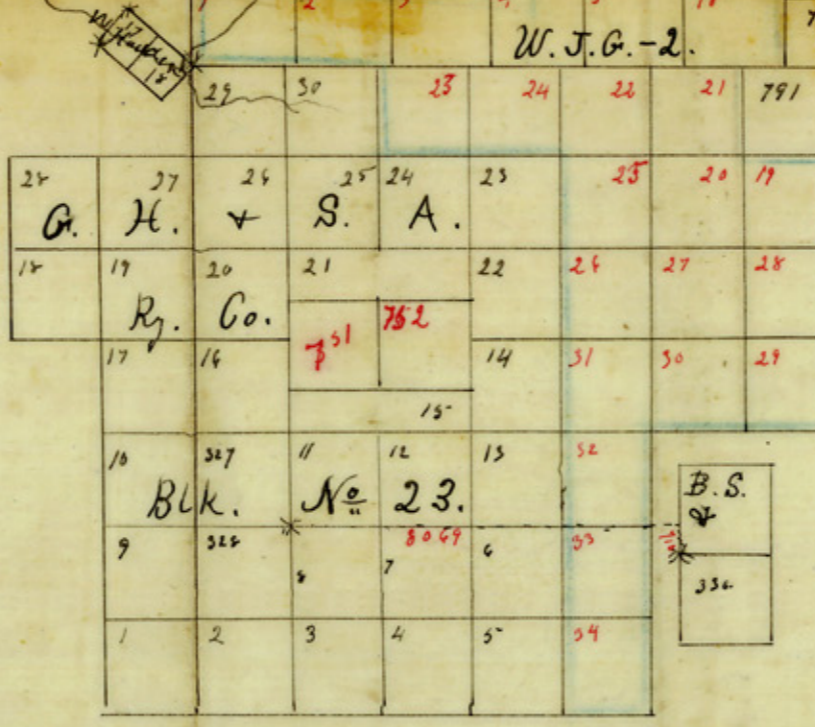

The S.W. Cor. of the 22nd Block (No. 23) is 52.0' - 2.4' 9.22' East of the S.E. cor. of Survey No. 7 made for the T. & M. Ry. Co.