

Map of Part of King County Texas.

Sketch 7A

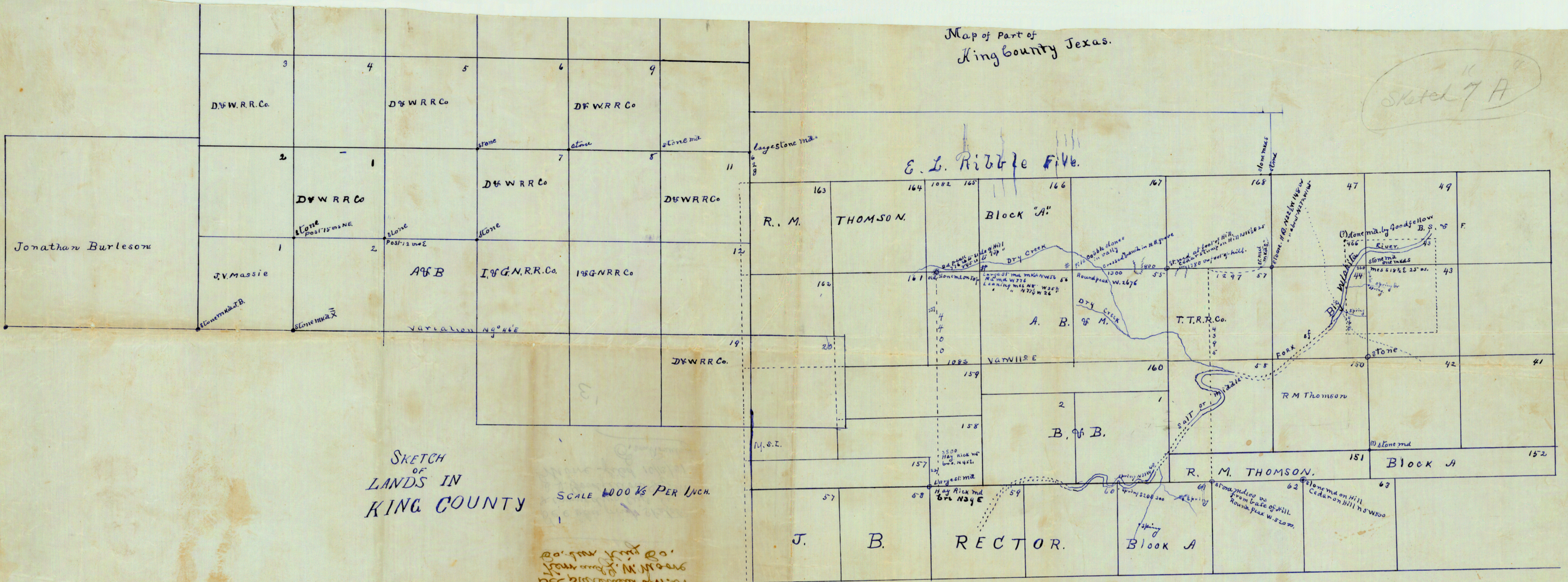

SKETCH OF LANDS IN KING COUNTY

SCALE 4000 FT PER INCH.

Original corners found upon the ground mks +  
 Original corners found with bearings mks +  
 " " by bearings and corners built, mks #  
 Corners built by course & distance also mks #  
 A doubtful md or corner mks (3) above dot.

Original corners found upon the ground mks +  
 Original corners found with bearings mks +  
 " " by bearings and corners built, mks #  
 Corners built by course & distance also mks #  
 A doubtful md or corner mks (3) above dot.

I A. D. Kerr, Surveyor of Bayles County Texas, do hereby certify that the above and foregoing sketch of a part of King County Texas represents the true positions of the surveys platted thereon, that all the natural and artificial objects called for in the original field notes were found on the ground as represented thereon, except the spring called for, and that I found spring branch about 1440 N of the S. 24. cor of 43 instead of as called in field notes of said Survey No 43 A B & M.

Witness my hand at Seymour Texas this 30<sup>th</sup> May 1902  
 A. D. Kerr.  
 Surv. B. C. D.

Filed June 10<sup>th</sup> 1902  
 John J. Ferrell  
 Chief Clerk

\$1.00

The State of Texas, # Field notes of connecting lines, in King county,  
county of King. # Texas. Var N. 10° E. May 18th. 1902.

Beginning at N. W. corner of survey No. 61 and N. E. corner of sur.  
No. 60 of Block A, made for J. B. Rector, whence a boiling spring in the  
bed of Middle Wichita River brs. N. 38 W. 43 vrs. and another spring or  
branch coming out from under the hill between it and the river brs. S.  
20 E. about 300 vrs. See field notes of section No. 61. Thence east at  
141 1/2 vrs. cross Middle Wichita at 160 vrs. on high bluff of same at  
485 re-cross river, at 1240 vrs. upon point of ridge at 1420 vrs. pass N  
side of round mound about 50 feet high, at 1942 vrs. a point 23 vrs. N, of  
corner, ~~was~~ an old stone mound, about 150 vrs. from base of ridge whence  
round mound brs. W. 520 vrs. Thence North at 1720 vrs. cross Middle Fork  
at 2100 vrs. cross it again, at 2520 vrs. cross it the third time, at 4750  
vrs. (2 1/2 miles) a point on North side of branch, thence east at 950 vrs.  
a point on east E. slope of ridge, whence a stone mound made for the S. W.  
cor of survey No. 47 brs. N. 13 W. 247 vrs. This mound of stone was made  
by Mr. Moore 1900 vrs. west of a stone mound made by Mr. Goodfellow for the  
N. W. cor. of survey No. 43.

Note: There are no indications of the original work of 56, 55 and 57 west  
of this point, nothing on this line going west as described in field notes.  
I did not run the line directly west from this point, but ran one parallel  
to it 500 vrs. south.

Thence south ~~45~~ East 335 vrs. Thence south 118 vrs. a stone mound of three  
stones, one set and marked S, which we supposed to be the S. W. cor. ~~of~~ 47  
A. B. & M. no bearings N. 22 1/2 W.

May 20th. 1902. Beginning at a ~~Pouring~~ spring, or rather between two  
springs 2 vrs. apart on N. bank of a branch about 150 vrs. east of where  
the old military trail crosses the Wichita river. Thence south at 160 vrs.  
cross the said trail at 300 vrs. another spring branch, at 478 vrs. an old  
stone mound about 100 vrs. S. W. of trail, course N. 30 W. There are numer-  
ous Hackberry and Mesquite trees around, some of them old. This is the cor-  
ner from which J. H. Glasgow says he made his connections to block A. and  
the one adopted by Mr. Goodfellow for S. W. corner of survey No. 43, A. B.  
& M. From this stone mound we ran south 45 east ~~2~~ 560 vrs. and south 162  
vrs. and west 8 vrs. to a stone mound, one stone set in ground, the old P. 8  
ranch brs. East about 1/2 mile. Thence north at 460 vrs. we are in a  
small wash, no spring, at 780 vrs. pass 20 vrs. east of the head of spring  
branch, at 1460 vrs. to spring branch, at 1480 vrs. crossed it, plenty of  
water in this very dry time, at 1948 vrs. a stone mound, one stone set in  
ground and marked S, whence a bunch of Mesq. brs. S. 18 east 25 vrs. The  
centre one is dead and is the parent tree, was an upright tree and was blazed  
upon its N. W. side, but the X is now gone. The creek brs. West 260 vrs. I  
see no reason for the discrepancy between this call and the call for a spring  
going south, except that the spring should have been called for 1440 vrs. N,  
of the southwest corner, instead of ~~xxxx~~ 1440 vrs. south of the N. W. corner.  
One thing is perfectly plain, that this is the N. W. corner of No. 43 as  
further developments will show. Mr. Goodfellow's corner can be seen across  
the creek N. 43 W. Thence west at 260 vrs. in bed of creek (Middle Wichita)  
at 466 vrs. a point whence stone mound brs. N. 499 vrs. I examined this stone  
mound, having noticed in Mr. Goodfellow's field notes that he enlarged it. I  
could recognize the newly placed stone by the portion of each that had lain  
in or upon the ground. On going to the bottom ~~of~~ I found a large flat stone,  
say, 18 X 18 inches, and a piece of same about 8 X 6 lying upon it, and un-  
derneath the small stone the large stone had a red spot the size of the small  
stone. The remainder of large stone ~~was~~ white, which showed it had been  
long exposed to the weather. A large Gypsum stone also laid upon the large  
flat stone, but it did not show to have ~~been~~ been recently dug up and suppos-  
ed it must have been laying ~~xxxx~~ beside the flat stone. Continuing west from  
point at 466 vrs. at 1905 vrs. a point, whence a stone set in the ground brs.

S. 45 W. 50 vrs. from which a Hackberry tree standing alone brs. N. 22 1/2 W. 148 vrs. (Var. 11°) and ~~xxxxx~~ another tree stands about 12 ~~xxxxx~~ vrs. to S. W. which answers very correctly to the call in field notes of No. 57 for a H. B. N. 27 1/2 W. 150. Beginning at stone set for S. W. cor. No. 47 A. B. & M. whence a Hackberry tree brs. N. 22 1/2 W. 148 and do brs. about N. 27 1/2 W. 140 vrs. Thence west (changed var. to 11°) at 225 vrs. passed the stone marked S. at 1780 vrs. base of hill at 2155 vrs. a stone ~~xxx~~ md. at base of another lower hill and cedar stump, top recently fallen down, but for a long time dead, brs. N. 15 1/2 E. 25 vrs. Thence west at 800 vrs. E. base of hill extending to the north at 1300 vrs. we crossed dry creek at grove of Hackberry trees (See field notes survey No. 55) at 1920 vrs. a point, whence a round mound or peak (60 ft. high) brs. west and and mound brs. N. 14 E. built <sup>stone md</sup> of small cobble stones. This point catches the east end of the m'd bearing N. 14 E., but I judge that the original surveyor was 20 or 25 vrs. further west. Thence west at 940 vrs. passed over a dam about 10 vrs. north of the west one of two windmills, at 1015 vrs. base of hill about 40 vrs. south of old dugout at 1900 vrs. (measured this line twice) built a stone mound about 2 feet each way, whence we marked a leaning mesquite tree mkd. X brs. N. 85 3/4 W. 25 2/5 vrs. another leaning mesquite tree mkd. X brs. N. 77 1/4 W. 26 vrs. one rock in md. mkd N. W. 56. Thence west at 776 vrs. on side of round peak at 845 vrs. passed 1/2 vrs. North of large pile of stone on top of said peak at 950 vrs. on ledge at ~~xxxxx~~ south base at 1440 vrs. branch at 1500 vrs. grove of Hackberry trees at 1940 vrs. cross branch at 2783 vrs. crossed a N. & S. wire fence at 2850 vrs. made small pile of stone for trial N. W. cor of No. 162 Blk. A, a double Hackberry on prairie brs. west about 150 vrs. and grove of Hackberries brs. S. 35 E. Thence north at 1474 vrs. passed 1 vr. east of a very old stone md. one stone mkd. X. at 1900 vrs. left reference for ~~xxxx~~ trial corner for N. W. cor. 163 Blk. A. (Further developments showed these corners to be further west if run from N. W. corner of survey No. 59 Blk A.)

May 22nd. Beginning at the S. W. cor. of the J. Burleson survey a ~~xxxx~~ stone md on prairie near Guthrie and Paducah road. Thence east var. N. 9° 46' East crossing Paducah road within 200 vrs. at 1038 vrs. crossed a ~~xxxxx~~ branch at 1415 vrs. on prairie, at 2460 vrs. in branch, at 3974 2/5 vrs. to stone mkd. J. B. as described in field notes of J. V. Massie No. 1. Thence East at 1900 vrs. a stone at cor. of fence ~~xxxx~~ mkd. X. Thence north at 1885 vrs. pass 14 vrs. east of cor of fence where two stones are set, at 1900 vrs. Bois 'd arc post. Thence east at 1885 vrs. passed stone set in ground at 1900 vrs. a post set in ground 1 1/2 vrs. south of fence line, at 3785 vrs. pass a stone on N. side of fence line, at 3800 vrs. a point 3 vrs. south of North end of fence line. Thence north at 1900 vrs. a point whence a stone lying on the ground, dead leaves under it, brs. South 15 east 36 vrs. and from it a young Hackberry brs. south 19 1/2 west about 60 vrs. Thence east at 1860 vrs. a pt. whence a stone lying on ground brs. S. 20 vrs. at 3788 vrs. a md. of stone at corner of fence, at about 4000 vrs. we found grove of Wild Chinas to our right about 100 vrs. No marks, at 5700 vrs. a large pile of stone built by Mr. Goodfellow for N. E. cor. of sur. No. 11 D. & W. R. R. Co. I accept this corner as correct. Thence south at 628 vrs. a point whence ~~the trial point (reference)~~ for N. W. cor No. 163 brs. West 43 vrs. Thence east 140 vrs. Thence N. 23 E. 97 3/5 vrs. to stone md. for S. W. cor. of land surveyed for E. L. Ribble by T. A. Bedford, Esq.

May 24th. Beginning at stone md. on round peak 845 vrs. west of N. W. cor. of survey No. 56, A. B. & M., whence a monument of rock built square and perpendicular brs. N. 34 E. about 200 vrs. and Hayrick mountain brs. S. 46 1/4 E. Thence south var. 9° 41' E. at 2690 vrs. on oblong flat top mountain, whence Hayrick mountain brs. N. 84 E., at 3800 vrs. Hayrick Mt. brs. North 45 E., at 4220 vrs. a point looked for N. W. 59 Blk. A., at 4400 vrs. point. Thence west 237 vrs. a large stone mound, whence Hayrick mountain brs. N. 39° E. *the N.W. cor. said 59.*

Beginning at S. W. survey No. 43, A. B. & M. a stone md. Thence south at 1300 vrs. in branch, measured west 466 vrs. and found no stone md. gave considerable search, continuing south at 1920 vrs. I found a dilapidated stone md., two stones with smaller stones between them and larger stone 12 X 12 on ground. I believe it to be the stone md. called for in field notes of survey No. 42 A. B. & M., but I could not verify it in any way. I ran no further lines, but was taken to a stone md. located north of the stone at S. W. cor of 47 and west of it I likewise found a stone mkd S. Mr. McCaughey says these stones mkd S. were put up in about the year 1884. The south line of No. 47 being 255 vrs. excessive I supposed they were put in course ad distance from the north west cor of survey No. 57 which had until recently been easily identified, but now the bearing tree has fallen down. I respectfully submit to the Honorable Commissioner these investigations, feeling sure that any fair minded surveyor will find them just as I have described them. I feel sure that the Honorable J. J. Goodfellow will likewise find them as I did. As to the stone md. near where he makes a cor. of 165 I find other stone mounds over the Block in different places. I am told by Mr. W. A. Jones that he built many corners in Block A. as he surveyed all this land for J. G. Eustice in about the same year J. H. Glasgow made the survey for Thompson and Rector.

Respectfully submitted,

A. D. Kerr

S. B. L. D.

I, G. W. Moore, surveyor of King county, do hereby certify that the foregoing survey was made upon the ground according to law and that the limits, boundaries and corners, with the marks, natural and artificial, are truly set forth in the foregoing fieldnotes, and that all the measurements, lines and angles, are truly given, having myself assisted in carrying the chain, and when occasion demanded took cognizance of course of lines and angles to bearings.

Witness my hand this 13th day of June, A. D. 1902.

G. W. Moore

Surveyor King county, Texas.

Filed June 13<sup>th</sup> 1902

John J. Driscoll  
Chief Clerk

