

State of Texas
 County of King } J.G.W. Moore, Surveyor of King County
 do hereby Certify that the Map hereon
 is a true & correct Copy of the map filed
 in my office in connection with the H.S. Rattliff
 and W.Q. Richards File
 Given under my hand in Office
 This the 6th day of Jan 1902

J.G.W. Moore

County Surveyor King C
 Texas.

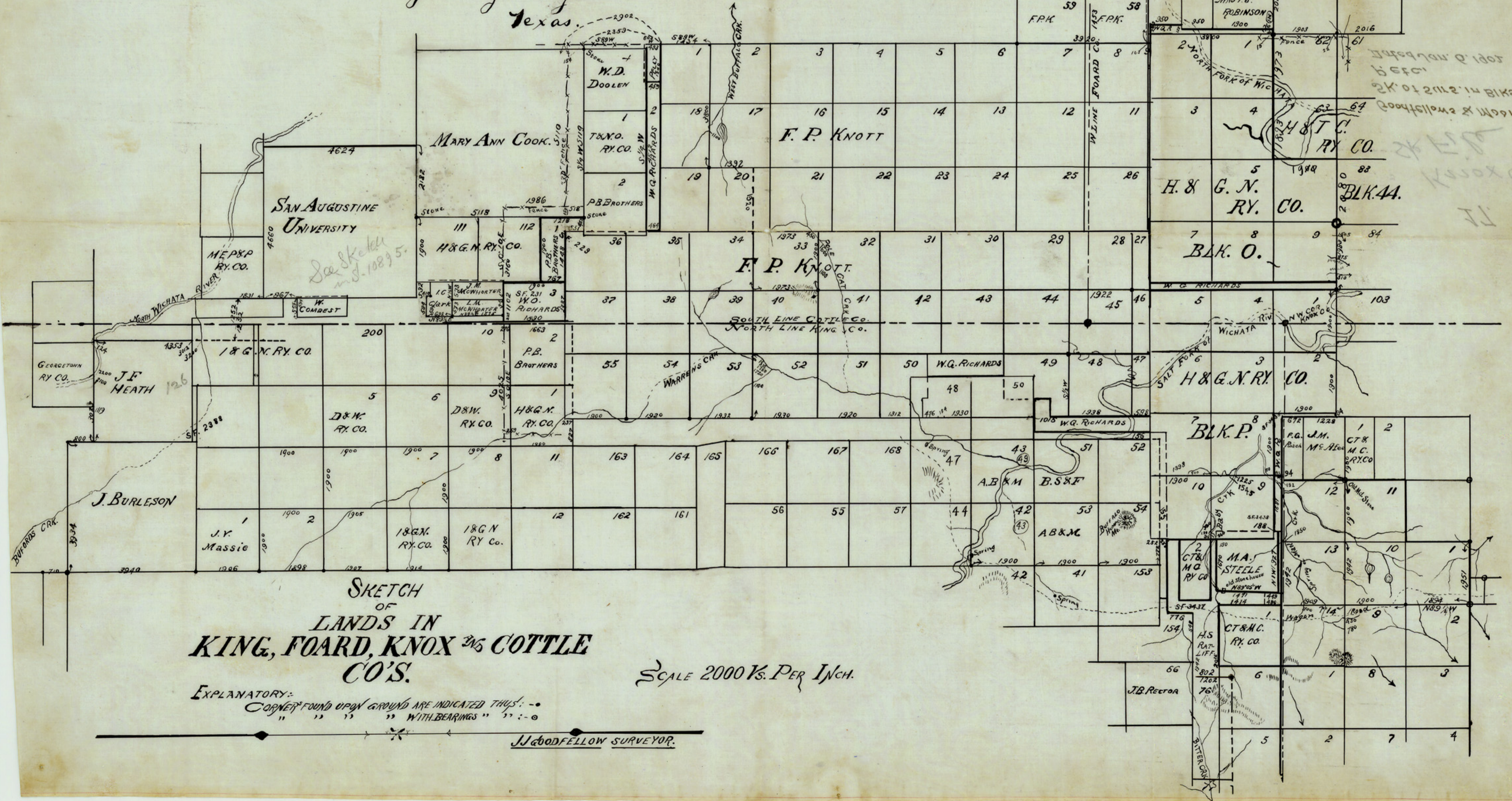

SKETCH
 OF
 LANDS IN
 KING, FOARD, KNOX & COTTLE
 CO'S.

SCALE 2000 FT. PER INCH.

EXPLANATORY:
 CORNER FOUND UPON GROUND ARE INDICATED THUS: --
 " " " " WITH BEARINGS " " :--o

J. WOODFELLOW SURVEYOR.