

FINE LINE COPY ON E 4

F A I L I S C O

cr. 625 28.966

Antanacio de la Sarda 11 Leagu

27624

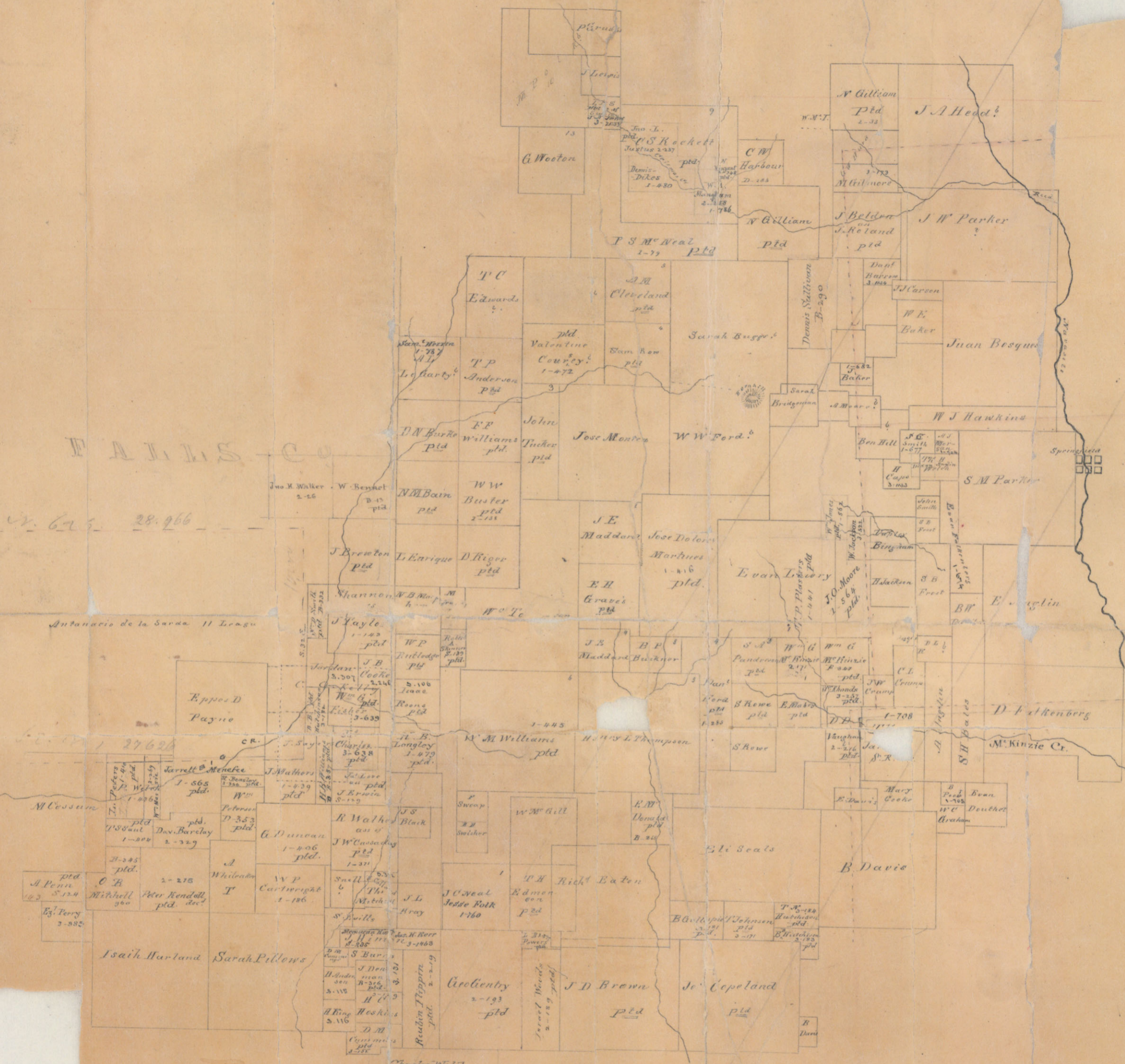

Corrected Plot of the western part of Limestone County  
Robertson District

The connection of Jose M. Viesca's & Elam  
Leagues on the Navisota is as follows  
From the North West corner of said Viesca's  
survey to the North East cor of Hugh  
Sturges' League survey the courses and distances  
is follows viz. Beg. at the North  
corner of said Viesca's League survey Thence  
S 32° E 198 varas To Stephen H. Eaton's N. boundary  
Thence S 60° W 1348 varas to said Eaton's N. W.  
corner Thence S 30° E 585 varas to Hugh Sturges'  
North East corner

C. C. Taylor  
Deputy Surveyor for  
Robertson Land District

This survey was made from another connection  
which does not correspond exactly with the  
one given

I David B. Mitchell District Surveyor for Robert-  
son Land District do hereby certify that  
C. C. Taylor was a regular appointed deputy  
at the date the within connection purports  
to have been made given under my hand  
at Office this 25<sup>th</sup> day of July 1847.

D. B. Mitchell D. S. R. S.

File 4  
Robertson Dist<sup>o</sup>

Connections of Fernando del Valle  
& Andrew Varela. — both  
large Mexican Grants.  
Returned July 1847.

Plotted on map.

---

Leon County  
above the Town of Cairo  
Sinnestone County  
by Springfield.

---

File 4-

Limestone Co.

Western Part of the  
County!