

Filed October 9/86.
 D. N. Robinson
 Chief Clerk

Unappropriated Public Domain
 - in -
MIDLAND, County, TEX.

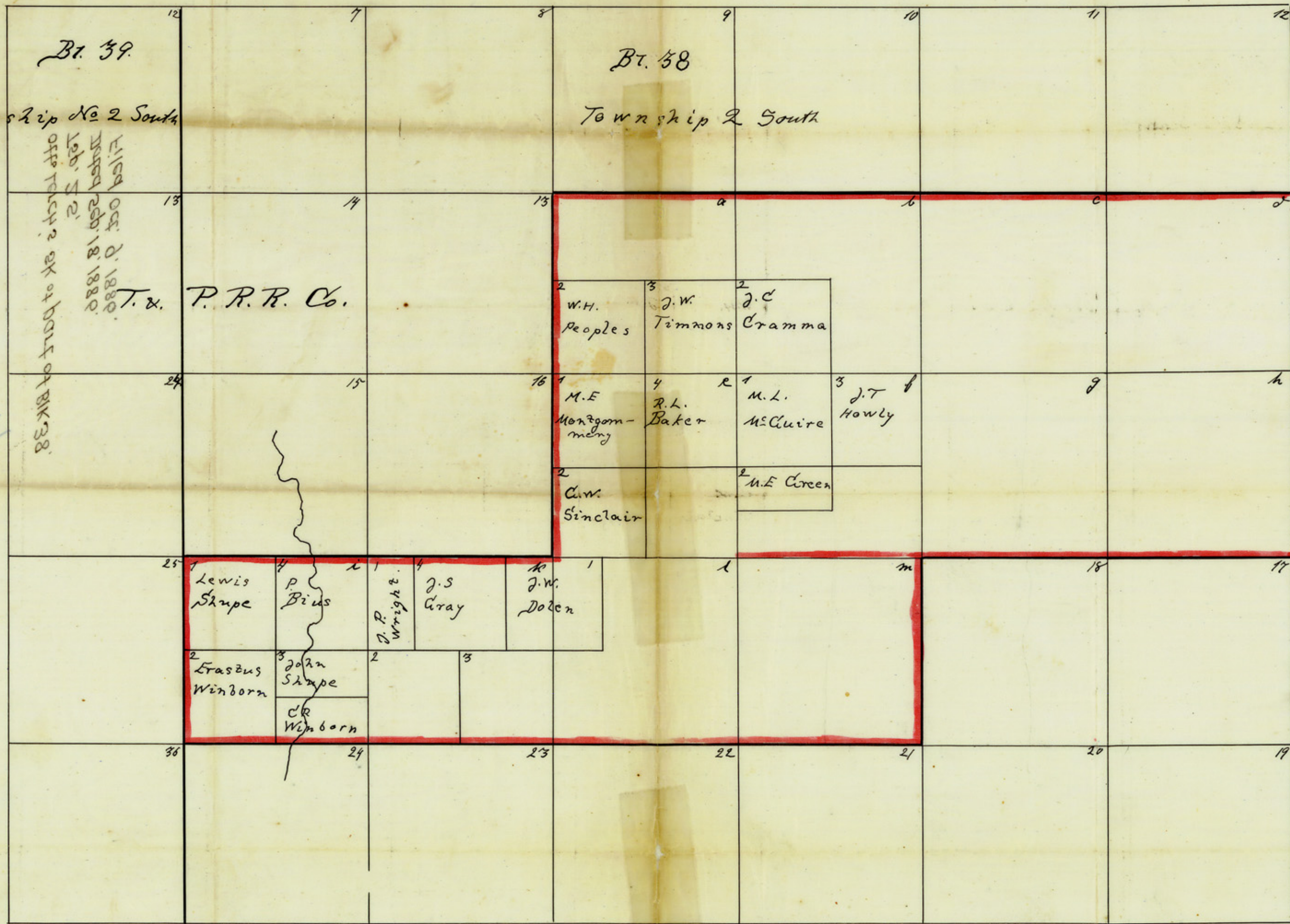

McQuinn & Co.
 12/1/86
 1886 Oct 9/86

offered to be added to
 Oct 1886
 1886 B.L.O. 1886
 T. & P.R.R. Co.

North 13 West.

COMPLET 15085

Course of Lines N 13 W
 N 77 E
Variation 12° 75'
Scale 950 vs. to 1 inch

Otto Lerch County Surveyor of Midland County
 do hereby certify that the foregoing sketch
 is a true and correct map of surveys made by me
 on the vacant and unappropriated public domain
 situated in Midland County

Midland, the 18th Day of Septor. A.D. 1886
 Otto Lerch
 Co. Surveyor Midland Co.