

JASPER CO.

NEWTON CO.

*Change to White  
J.F. Weed's sk. of sur. in Newton  
part of Orange Co.  
Dated Oct. 30. 1890*

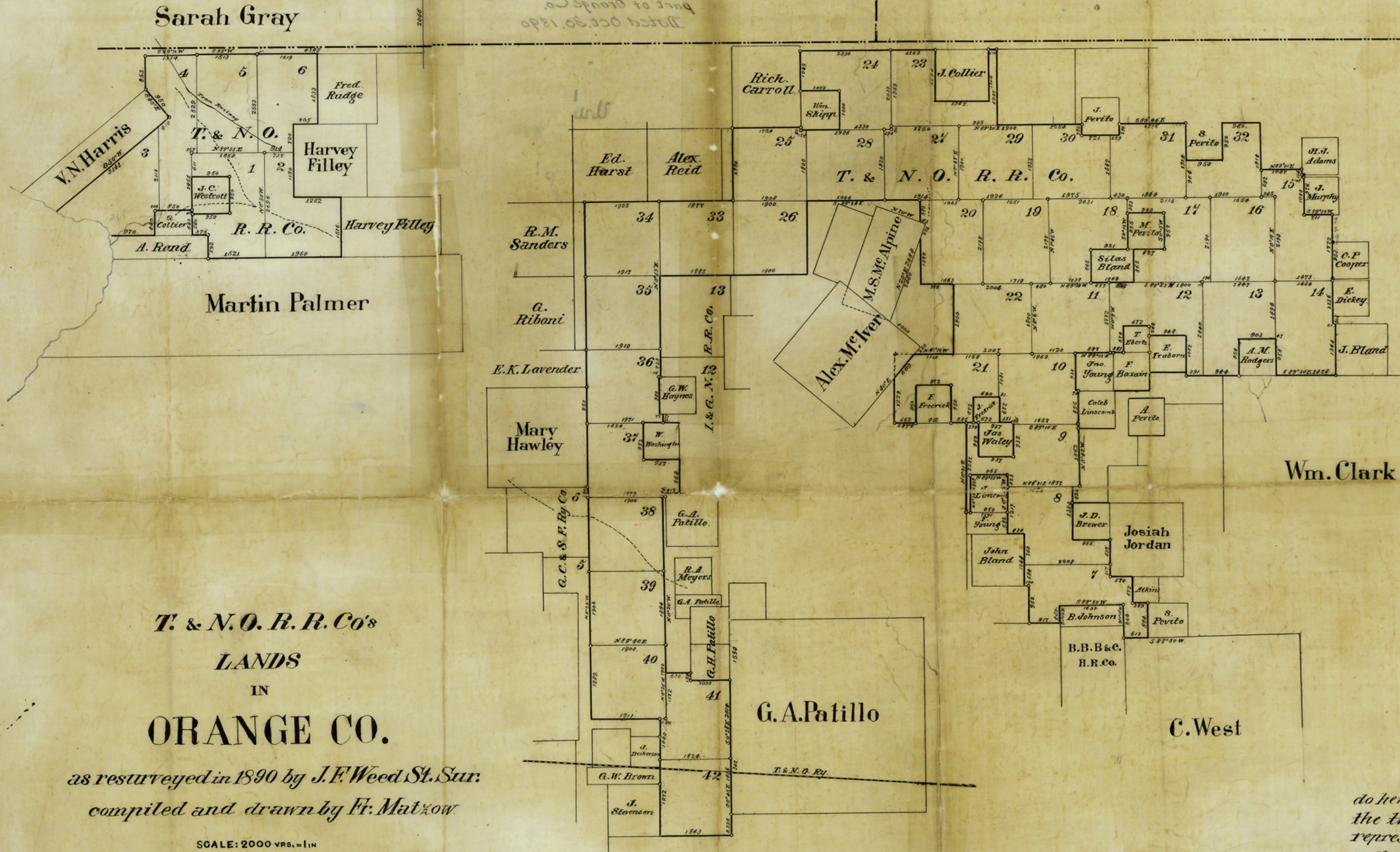

**T. & N. O. R. R. Co's  
LANDS  
IN  
ORANGE CO.**

*as resurveyed in 1890 by J.F. Weed St. Sur.  
compiled and drawn by Fr. Matxow.*

SCALE: 2000 YRS. = 1 IN  
VAR. 8°15'

*o indicates old corners found.*

*I. J. F. Weed State Surveyor  
do hereby certify that this sketch shows  
the true and correct position of surveys  
represented thereon as resurveyed by me  
on the ground.* *Jas. F. Weed State Surveyor.*  
October 30th 1890.

*See statement accompanying this sketch*

*Filed Nov. 8th 1890.*

*C. von Rosenberg  
Examining draftsman*