

1/4 mile from Cottonwood on West side of Brazos to established corner on Center line in Line of Parker & Palo Pinto Counties. Course  $A67^{\circ} 30'$  East Variation  $9^{\circ} 30'$ .

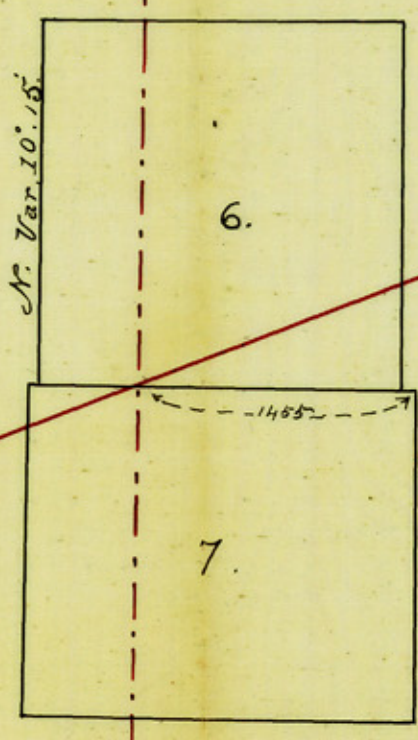

$N. Var. 10^{\circ} 15'$

6.

7.

County Line  
 $South. Var. 9^{\circ} 18'$

**MAP**

SURVEYS MADE  
for the  
TEXAS PACIFIC RAILWAY CO.  
IN  
**PALO PINTO CO.**  
BLOCK  
**B**  
M.E.P. & P.R.R.  
RESERVE  
WEST OF THE BRAZOS  
RIVER.

$S 82 \frac{1}{2}^{\circ} E$   
 $Var. 9^{\circ} 30'$   
Section 8

*[Handwritten signature]*

*[Handwritten notes]*

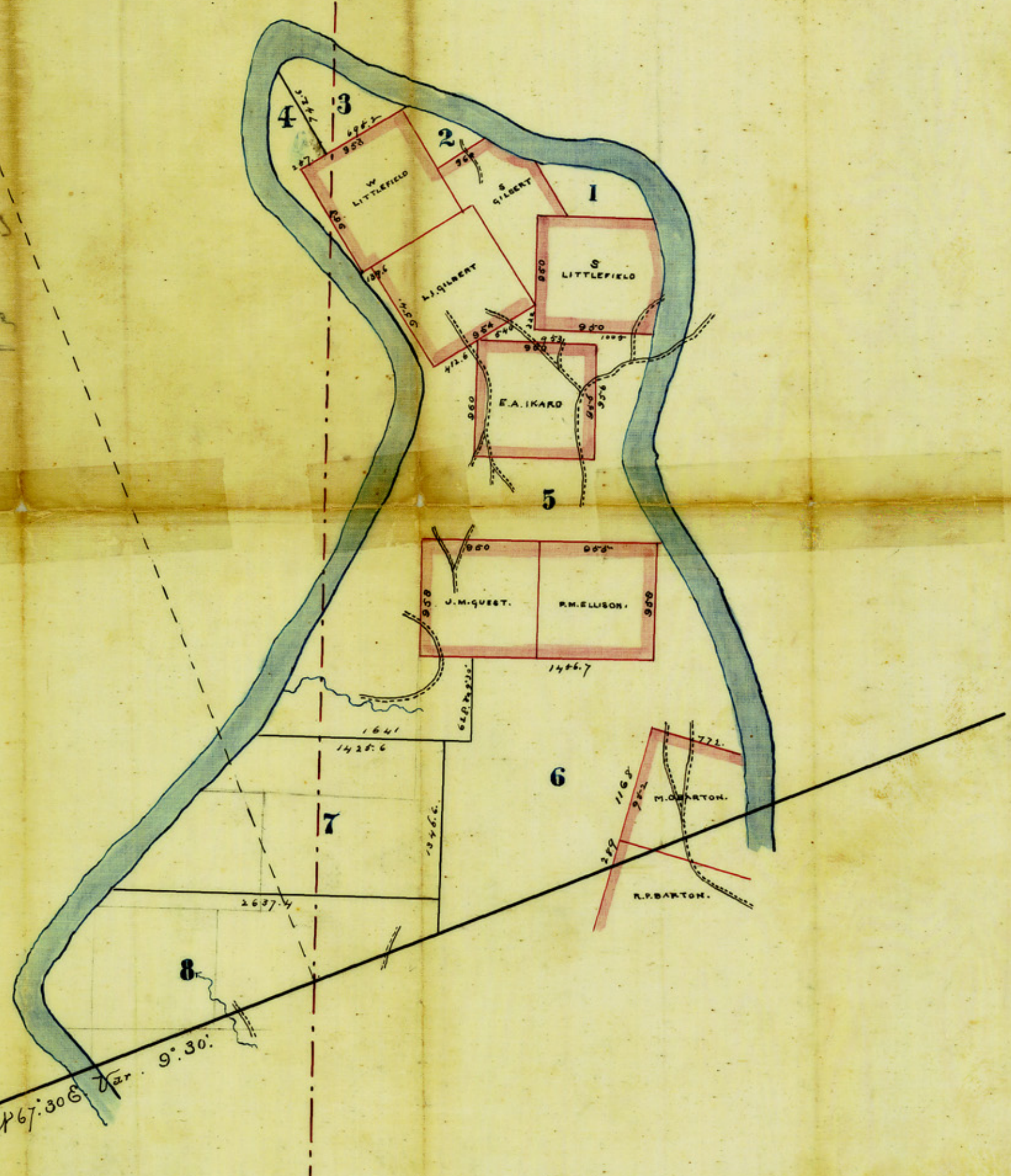

$A67^{\circ} 30' E$   
 $Var. 9^{\circ} 30'$

COMTE B# 1314