

DL31

556



COMMISSION
*
JOHN S. REDDITT, CHAIRMAN
REUBEN WILLIAMS
FRED E. KNETSCH

STATE HIGHWAY ENGINEER
D. C. GREER
*

TEXAS HIGHWAY DEPARTMENT

Laredo, Texas.
P.O. Box 592
August 8th 1946

Mr Bascom Giles
Commissioner General Land Office
Austin, Texas.

FILE NO.

Esteemed Sir;-

Being concerned in obtaining land lines in the process of surveys for a proposed new causeway route between the town of Portland, San Patricio County and Corpus Christi in Nueces County we reported the information and ties to the S.E. Corner of the John Mc Lean survey on Corpus Christi bay by means of a working sketch a print of which we take the liberty to enclose herewith for your information.

Historically this cedar post was set many years ago by my Father jointly with James O Gaffney surveyor for San Patricio county when reestablishing these surveys for the then Owners namely The Coleman Fulton Pasture Company and John G Willacy Probably about 1889-90 A.D.

Respectfully yours

Fred M. Percival

Fred M. Percival

FMP/vb

Note my father "Frank Percival County Surveyor of Aransas Co James O'Gaffney County Surveyor San Patricio Co both long since deceased

RECEIVED

AUG 8 - 1946

REFERRED TO MAP

EC

BLOCK C1	
7	
8	
9	
10	
11	
12	

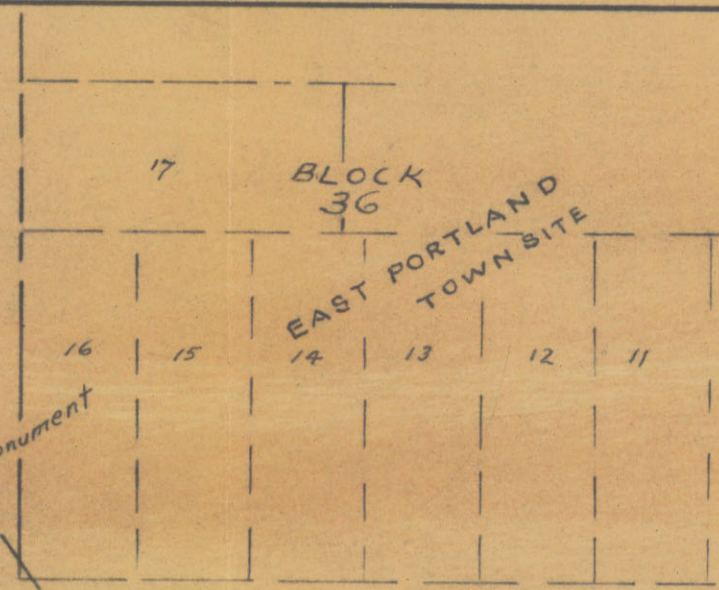

WEST PORTLAND TOWNSITE

JOHN McLEAN
L.W. 2476

THO'S T. WILLIAMSON
L.S. 37

John McLean Survey

T.T. Williamson Survey

PROPERTY OF J.W. HUNT

558

Water Tower at La Quinta bears N71°47'E
along 5" dia. Ingalas de Hotel H 71°38'E
Stan Pipe, Corpus Christi S45°18'30"W
Feb. 1911

Old Cedar post, cor. of McLean Survey

Monument Cedar Post

N 66°09'E
To square pine post

Concrete Cone Monument

BAY

746 varas of McLean
566°15'W course & distance
Survey & of Cyrus W. Egery Survey
To C.C. Water Stan Pipe
S 45°15'30"W
To C.C. Water Stan Pipe

CORPUS CHRISTI

43°16'40"

WORKING SKETCH
AT S.E. CORNER OF THE
JOHN McLEAN SURVEY
ON CORPUS CHRISTI BAY
SAN PATRICIO COUNTY, TEXAS
Scale 1:1000 feet

Judith Powell, 8/4/1946

(MAP FILE N° X-201)
(SIZE 21" X 14")

NOTE:
Bearings given, based upon
Main Street Portland as original
Surveyor's North, that being along & parallel
to the old and well establish line of said
John McLean Patent (L.W. 2476)
Judith Powell

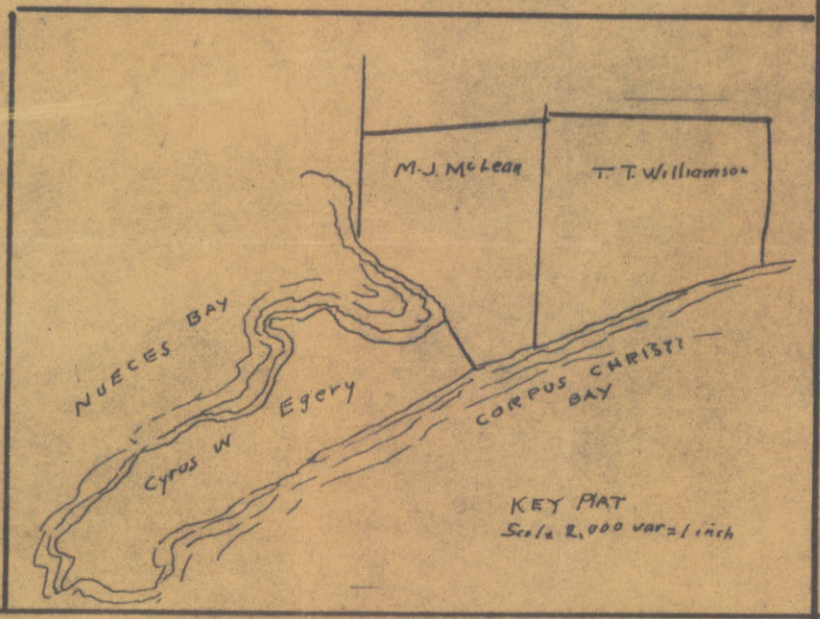

Ec'

556

RECEIVED

AUG 8 - 1946

REFLARED TO MAP

1231

SAN PATRICIO SK FL 33
 SKETCH AND STATEMENT
 RE S.E. CORNER
 JOHN Mc. LEON SURVEY
 ON CORPUS CHRISTI BAY
 BY FRED M. PERSONAL
 RECEIVED AUG 8 - 1946
 W. Phillips
 FL. CA.

EC²