

Map of the G. H. PATTERSON 24 Labors Survey  
and surveys conflicting therewith  
Shelby County.



Shelby County, Texas  
December 1st A.D. 1879

I Tom C. Davis County Surveyor of Shelby County do  
certify that this Map shows the correct position of the said  
G. H. Patterson 24 Labors and the connection therewith of  
conflicting surveys. I have carefully measured all  
lines (finding the original marks thereon) of which  
the courses and distances are stated on this Map,  
and said Courses and distances are as found  
same to be on the ground excepting such immat-  
erial changes as were necessary to be made in  
callancing the work. The map of Shelby County as prepared at the General  
Land Office shows the prob. Claim 309 acres survey as being in conflict with  
the Patterson survey, but although I made long search I could not find corners evidenced by upright trees, as  
called for in the field notes of the said Davis survey. Therefore I do not show said Davis survey on this map, but it  
is possible it may be in conflict. The Lewis Bass 16 acres is now invalid, being a forfeited preemption survey.

Given under my hand officially at Center Sec 14 A. D. 1879.

T. C. Davis  
County Surveyor Shelby County

Scale 400 varas per inch.  
Variation = East, 9° 20'

Shelby County, Texas.

S.L.N.E.

12319

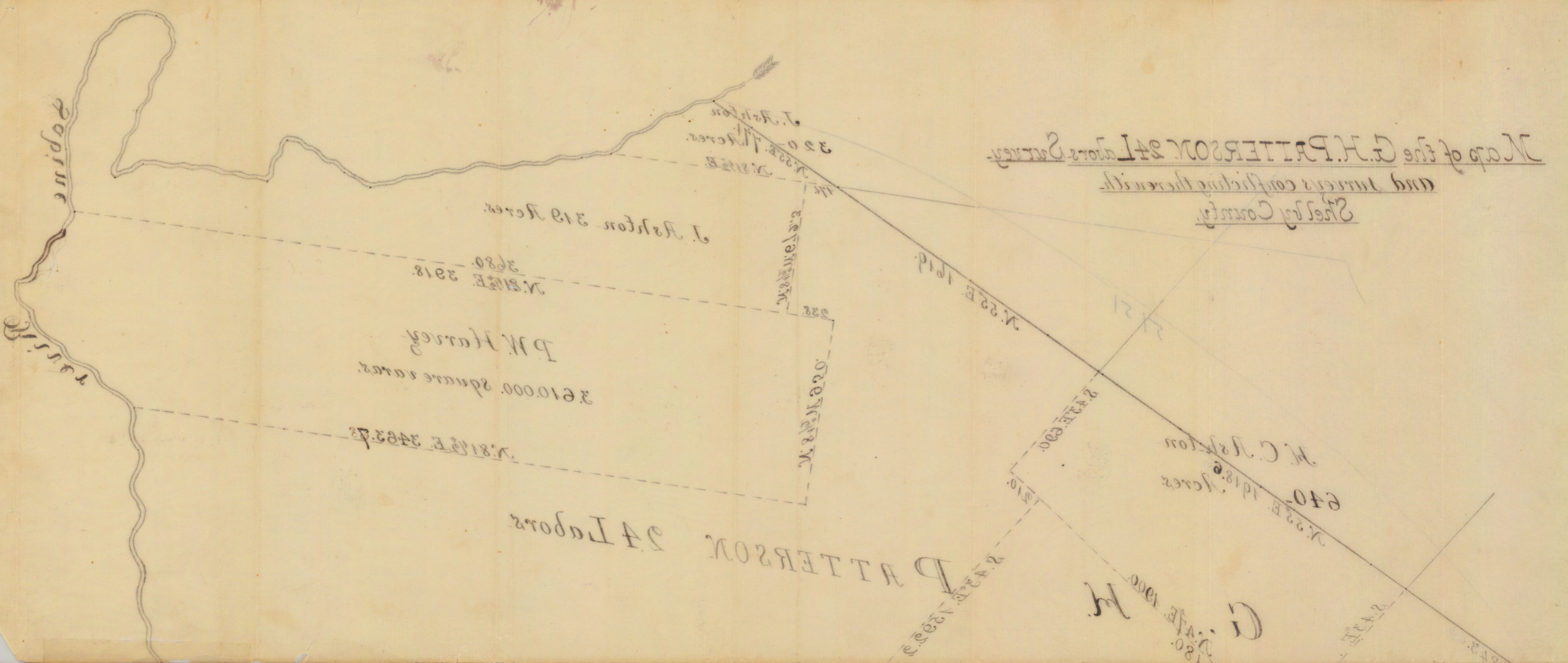

Map of the G.H. PATTERSON 24 LABOR SURVEY  
and survey conflicting therewith  
Shelby County

File 20.  
Shelby County Sketches.  
Surveyors Artificed Sketch,  
showing true position  
of the  
G. H. Patterson 24 Labor grant.

filed Decr 8 1879  
Rhoas Fisher,  
Chief Clerk  
The position of the C. Ashton  
survey as given within is  
erroneous according to  
the connection given in  
the A. Hill Co. Survey  
by C. M. Hill Co. Surveyors  
Febr. 26/80. This copy

RD



Shelby County, Texas  
Patterson 24 Labor  
2400 acres per right

**JAMES F. STARR.**

Marshall, Texas, Dec'r 6th 1879.

Hon. W. C. Walsh,

Corn<sup>r</sup> of G. L. O.

Austin, Tex.

Dear Sir:

Enclose:

1<sup>st</sup> - Map, with certified statement <sup>of county surveyor</sup> thereon, showing the G. H. Patterson 24 labors, Shelby Co. and surveys conflicting therewith.

2<sup>nd</sup> - Certificate of County Surveyor of Shelby County that the Lewis Bass 160 acres presumption survey conflicting with the said Patterson survey has been abandoned.

I trust that the evidences enclosed will suffice to have the said Patterson and conflicting surveys properly shown on your maps.

It is the result of much examination and surveying by the present County Surveyor of Shelby Co. Mr. Tom C. Davis, aided by his predecessor Mr. C. M. Hill - the latter being <sup>I believe</sup> more than ordinarily competent.

Please acknowledge.

Very respectfully

J. F. Starr.

Please inform me when the enclosures have been examined and passed upon, - as I then will desire to direct the attention of owners of the conflicting surveys to the matter, & request them to apply to you for information confirmatory of my statements; <sup>said owners being non-residents of county.</sup>

file 20.

SHELLEY CO

James F. Starr

Marshall

Decr 6/1879

With certified sketch of J. H.  
Patterson 24 Labor Survey.  
and evidence of abandonment  
of Lewis Bass's preemption

Recd & filed Decr 8/79.

Represented on Map.