

The State of Texas
Palo Pinto Co I D. Cunningham, Surveyor
of Palo Pinto Land Dist. do hereby certify
that by actual measurement & ~~by~~
on the ground. Beginning at the S.W. cor. of Survey
no 20 made by virtue of G.C. & S.F. R.R. Co Land Sale
#3058. Said Survey no 20 made by C.D. Foster
my Deputy Surveyor. I find the distance from
North line of Block no 7 made by H.F.
C.R.R. Co. North, to South line of S.P.
R.R. Co Block #13. to be 7000.00.

S.W. cor. of Survey #5 & S.E. cor. of Survey #6
Block #13. S.P.R.R. Co. old rock md found
and identified by Bearing True a mesy
by S 5 1/4 N 75.00. I also found S.W. cor. of
Said Survey #6. Old line plainly marked
Given under my hand at
Palo Pinto Tex November 23rd A.D. 1881

D. Cunningham
Surveyor of Palo Pinto
Land District

Part # 3
Sterling Co Slates

Pt. - # 3 - Sterling

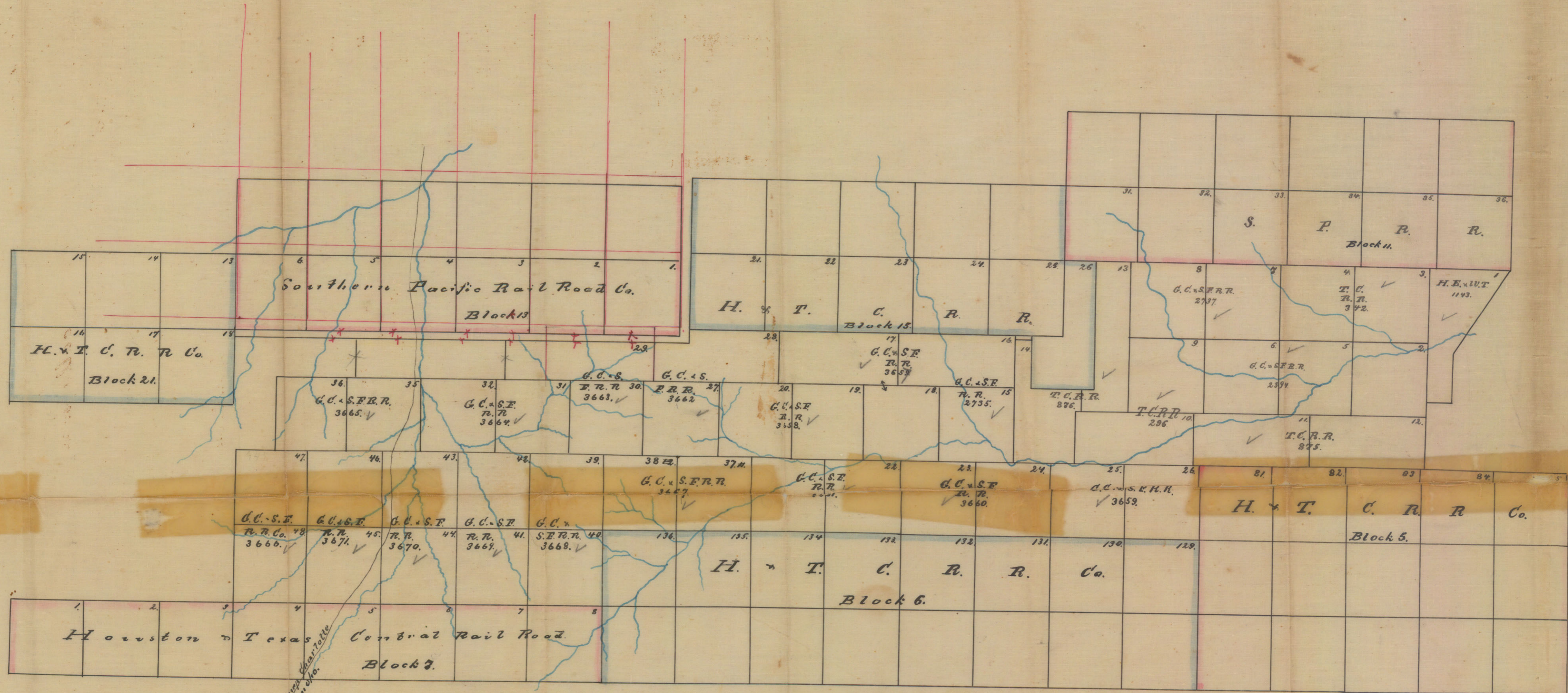

R¹

Military road from Camp near Talle to head of North Concho.

Statement of facts.

The North line of Block No. 5, Houston and Texas Central Rail Road Company, was established by

3.
File 40.

Tom Green County

Dated Novemb. 28/81

Roads & Bridges
Chas. C. C. R.

R²



Survey of the ...

R¹