

Meanders
OF
German Emigration Cos,
Surs. 551 to 560.

Cancho Co Texas,

State of Texas }
County of Cancho }

J. J. W. Ratchford
County Surveyor Cancho Co. Texas

do hereby certify that this is a correct sketch of a meandering of the Coucho River in Cancho County Texas, made by me with Alphonse Melin and Thomas Kemp as chain carriers on Dec. 6-1888. Commencing at a corner the U. W. cor sur. 551 and running to the U. W. cor of sur. no. 559. Said survey made by virtue of the U. B. Giddings Cert. no. 1255, sur. no. 1605 1/2 and that I found all the corners as marked by me in Red on this sketch.

J. J. W. Ratchford

County Surveyor
Cancho County Texas

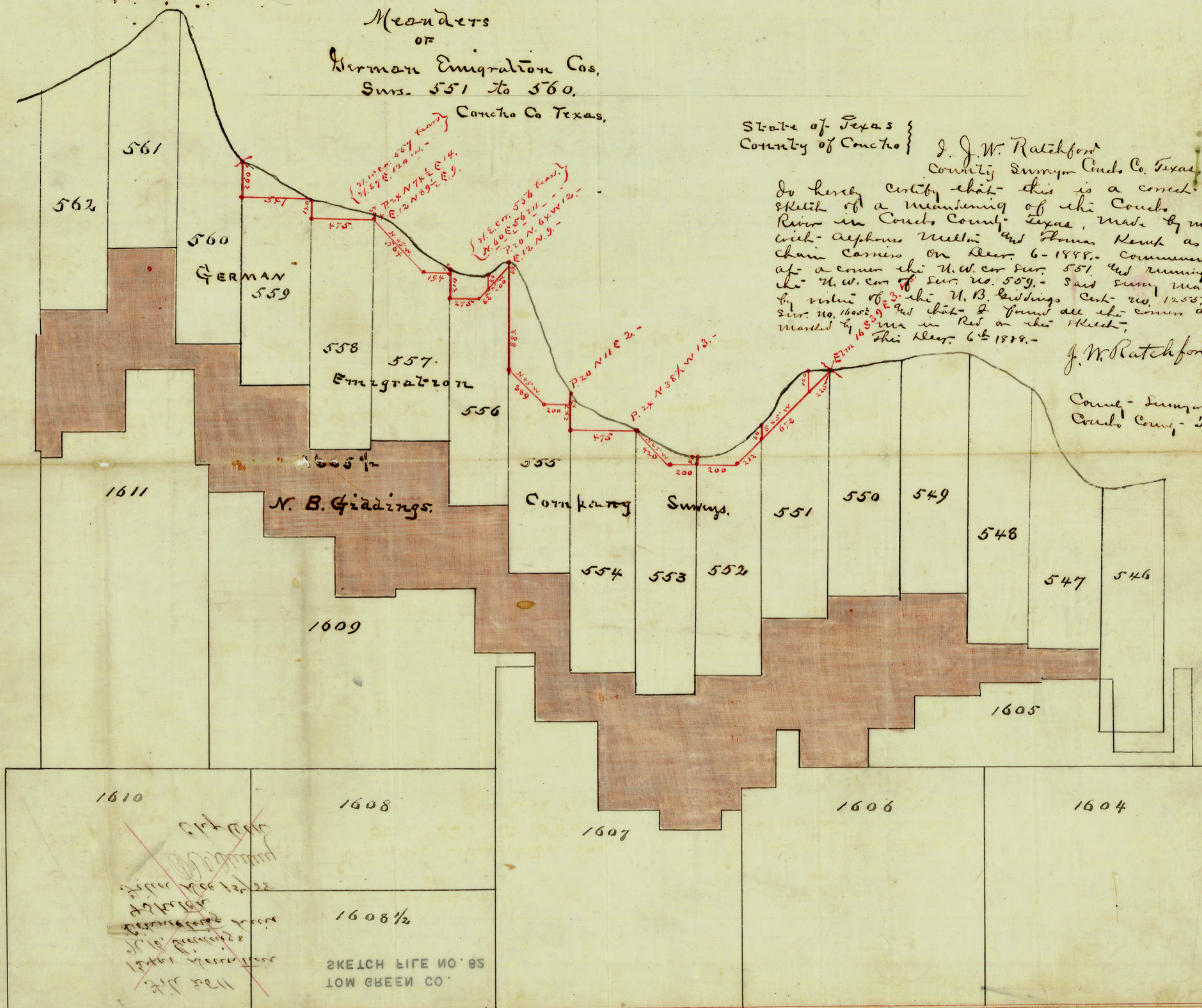

SKETCH FILE NO. 82
LOW GREEN CO.