

Sketch of a Survey of Connecting  
lines in Val Verde Co.  
Made by W.P. Ratchford, March 1907.

Explanation.

Corners marked with "O" in red  
Show those found.  
Lines run are marked in red.

For T.B. Jones,  
Del Rio.

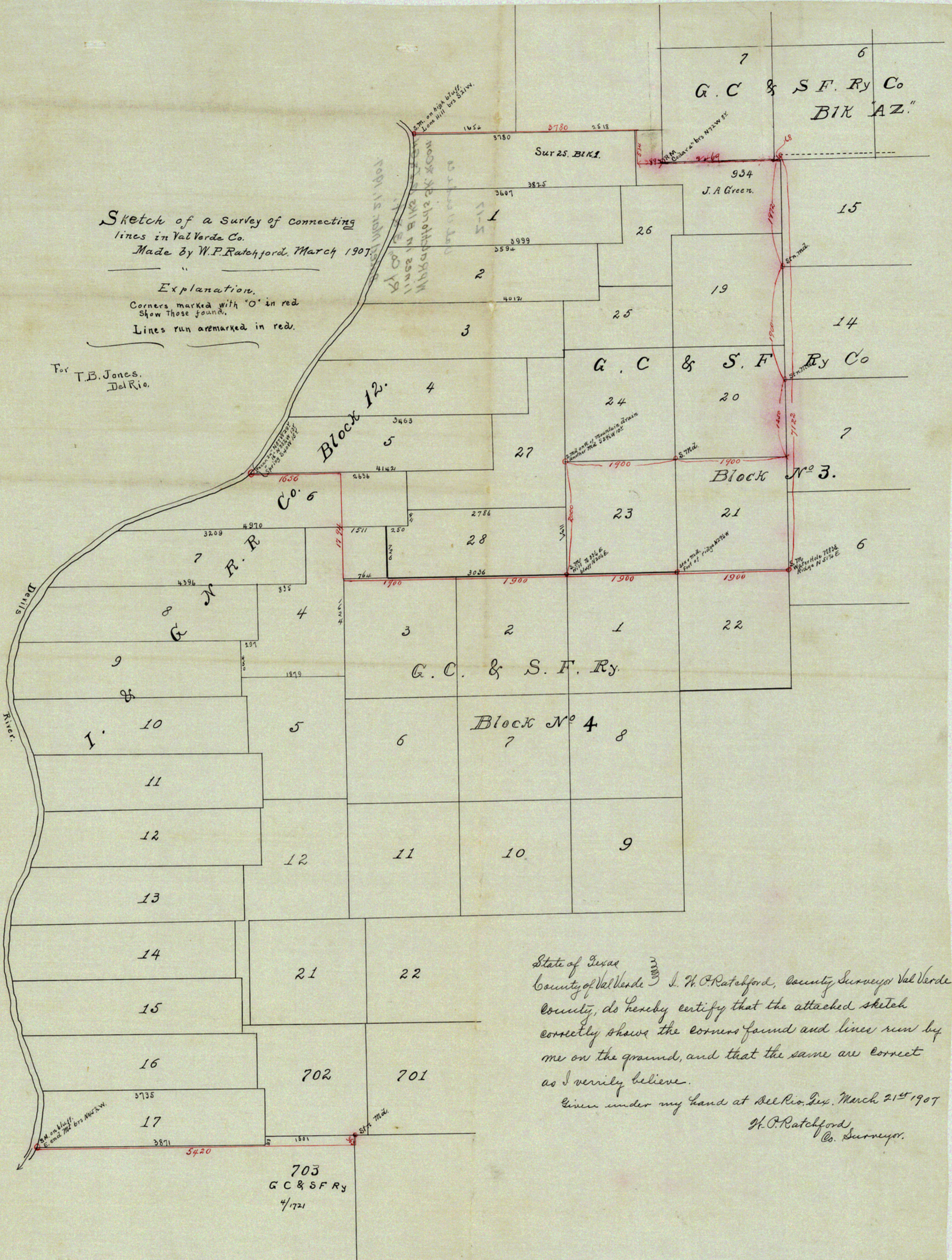

State of Texas  
County of Val Verde  
I, W.P. Ratchford, County Surveyor Val Verde  
County, do hereby certify that the attached sketch  
correctly shows the corners found and lines run by  
me on the ground, and that the same are correct  
as I verily believe.

Given under my hand at Del Rio, Tex. March 21<sup>st</sup> 1907  
W.P. Ratchford  
Co. Surveyor.

COPIER # 1225

The State of Texas }  
County of Val Verde }

Field Notes of the Survey  
of connecting lines between corners in  
G. C. & S. F. Ry Co Blocks 3<sup>rd</sup> & 4<sup>th</sup> and corners  
in I. & G. N. Ry Co Block No 12 on Devils River.  
This Survey was made at the request of  
T. B. Jones for the purpose of determining  
what vacancy, if any, existed between  
said Blocks 3<sup>rd</sup> & 4<sup>th</sup> and Block 12.

First line

Began at a stone md for N.E. cor. of Sur No 703.

G. C. & S. F. Ry Co Certif. No. 4/1721.

Thence South 363 Varas

Thence West 5420 Varas to a stone md. on bluff  
bank of Devils river, from which East end of Mt. bears  
N 45 1/2° W. for S.W. corner Survey No 17. I. & G. N. Ry Co  
Block No 17.

Second line

Began at N.E. corner of Survey 22, G. C. & S. F. Ry Co  
Block 3, a stone md, from which Griffin Griffin  
Water hole bears N 83° E and End of ridge bears N 51 1/4° E.

Thence West at 1900 vrs old stone md for N.W. cor  
Sur 22, from which East of ridge bears N 29 1/4° W. —  
at 3800 vrs stone md for N.W. cor. Sur. No 1 Block 4,  
from which Hill bears N 33 1/2° E and bluff bank bears  
N 20 1/2° E. — in all 7600 vrs.

Thence North 1794 Varas.

Thence West 1656 Varas, <sup>N.W.</sup> Corner of Survey No 6  
I. & G. N. Ry Co Blk 12, from which large Pecan  
bears N 87° W 29 vrs. another bears N 35 1/4° W. 13 vrs.  
a spring in bluff bears S 40° W 15 vrs.

Third line.

Began at same beginning point as above

Thence North at 3250 Vs pass stone md for  
NN Cor Sur 7 Blk 3. - 5153 Vs pass s. md. for  
NN Cor Sur 14 Blk 3. - 7122 Vs to old stone md  
for NN corner Sur 15 Blk 3.

Thence South 68 Vs

Thence West at 2169 Vs old stn. md for S.W. cor Sec 7  
Blk "A", from which cedar 4" br N 72 W 8' - 2857 Vs.

~~Thence West 2159 Vs~~

Thence North 534 Vs.

Thence West 3780 Vs to a stone md on  
bluff bank of Devils river from which a lone  
hill bears S 21 W, for NN corner Sur 25 Blk 1  
I. & G. N. Ry Co.

Surveyed March 1907.

I, H. P. Ratchford, County Surveyor Val Verde  
Co. Texas. do hereby certify that the foregoing  
survey was actually made by me on the  
ground, according to law, and that all  
the corners, lines, boundaries and marks  
of the same are truly and correctly described  
and set forth in the foregoing plat and  
field-notes.

H. P. Ratchford  
Co. Surveyor Val Verde Co.

Val Verde Co. SK File

2-17