

Val Verde Co.

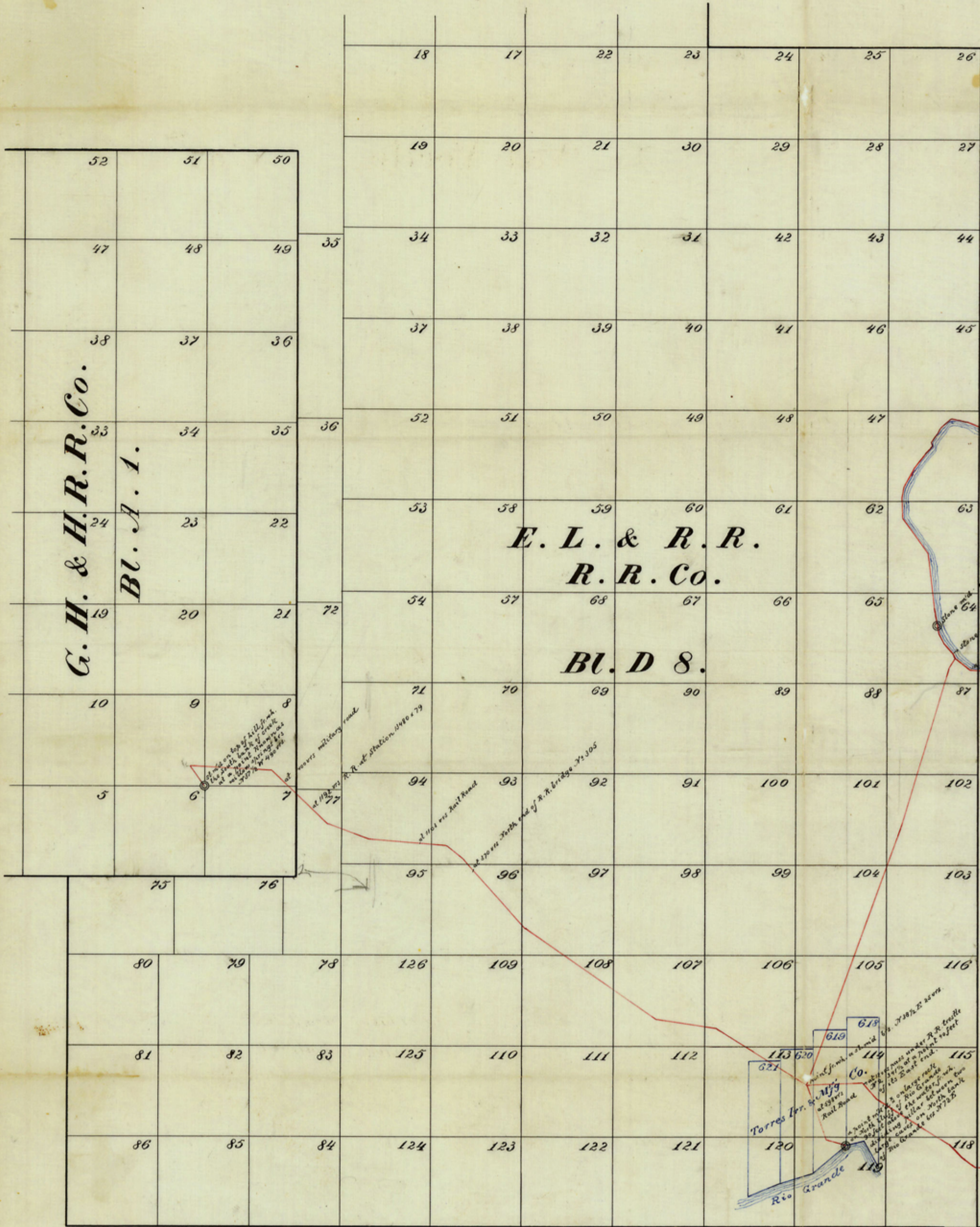

G. H. & H. R. R. Co.  
BL. A. 1.

E. L. & R. R.  
R. R. Co.

BL. D 8.

- References:
- ⊙ Old corners identified
  - new corners established

I, D. L. Reavis, State Surveyor do hereby certify that the above sketch shows the true and correct position of connecting lines between original corners represented thereon, as run by me on the ground.

August 2<sup>d</sup> 1889.

D. L. Reavis  
State Surveyor.

for correct position of all 'D's'. See Sketch in Box S-35814 Rosenberg

Houston & Texas Central  
Railway Company.

CHAS. DILLINGHAM, RECEIVER.

Land Department.  
C. C. Gibbs, Land Agent.

Houston, Texas Aug. 28th '89

Hon. R.M. Hall, Commissioner, General Land Office,  
Austin, Texas

Dear Sir:-

On January 11th 1889, you furnished me a working sketch  
of a portion of Val Verde County, on the Pecos and Rio Grande  
Rivers, and requested that the Company furnish you with certain  
particulars in that locality:

I enclose you notes of lines run by Mr D.L. Reavis, State  
Surveyor, and sketch of his work, which shows the surveys in a

... on top of a hill near  
... to the South-east corner of survey # 319 in the  
... Irrigation Co, on the Rio Grande, identified by call  
... between two caves etc- A line to show the position of  
... Rio Grande, South of # 117, Block d8 E.L & R.R. surveys:  
Thence to a stone marked # on bluff of Pecos River, near a natural  
cistern, as described on sketch furnished by your Office. These  
lines were all carefully measured and I trust you may find them  
correct.

Yours respectfully,

C. C. Gibbs  
Land Agent

Enc

counter 39185

Sketch C.  
Val Verde Co.

Connecting line by D.L.  
Reavis State Surveyor  
From S.E. cor. of  $\& 9$  Block A1.  
G & B. P. Co. at Willow Sp.  
to S.E. cor.  $\& 619$  Torresdrington  
Co. on the Rio Grande near  
Langtry.

Filed August 27/89

*P. A. Sheeley*  
CHIEF CLERK.

See Sketch in  
S-35814 & 35812  
This is out of old Pecos Co.

and Langtry  $\& 22$

(No. 2.)

1 connecting line from the SE corner of survey No 9  
2 G H & H R R Co's Blk A.1 to the SE corner of survey  
3 No 619 in the name of Torres Dr & Mfg. Co

4 Beginning at a stone mid on top of hill the  
5 SE corner of survey No 9 G H & H R R Co Blk A.1  
6 Thence  $S 37^{\circ} 1/2' W$  490 w to the south bank of creek at  
7 a point known as Willow Springs.

8 Thence  $S 86^{\circ} 55' E$  1675 w a point

9 "  $S 47^{\circ} 15' E$  at 400 w military road at 1192 w  
10 R R at station 13480 + 79 at 1635 w point.

11 Thence  $S 69^{\circ} 45' E$  897 w a point.

12 "  $S 85^{\circ} 52' E$  at 1103 w R.R. 1639 w point

13 "  $S 62^{\circ} 23' E$  435 w a point.

14 "  $S 42^{\circ} 12' E$  at 370 w north end of R R bridge

15 No 305. 1976 w a point.

16 Thence  $S 55^{\circ} 5' E$  3335 w a point

17 "  $S 81^{\circ} 13' E$  1275 w . point.

18 "  $S 58^{\circ} 28' E$  2222 w " from which a  
19 a stone mid on  $S 88^{\circ} E$  25 w

20 Thence  $S 20^{\circ} 49' E$  at 598 w R.R. 1208 w point.

21 "  $S 68^{\circ} 56' E$  403 w point on river bank on  
22 large rock marked  $\frac{2}{3}$  from which dividing pillar  
23 between two large caves on north bank of Riv.  
24 Grande on  $N 72^{\circ} E$

25  
26  
27  
28  
29  
30  
31  
32

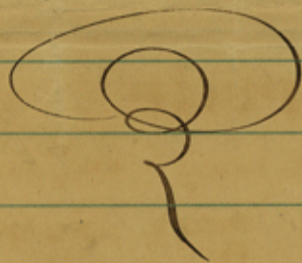

1 Connecting line from a point from which a  
 2 stone mid brs  $N 38 \frac{1}{2} E 25$  vrs <sup>Referred to on preceding page.</sup> to a point on  
 3 The Rio Grande

4 Beginning at a point from which a stone mid  
 5 brs  $N 38 \frac{1}{2} E 25$  vrs refer to above

6 Thence  $N 87^{\circ} 29' E 1131$  vrs point near East end  
 7 of R.R. trestle 34 1/4.

8 Thence  $S 40^{\circ} 34' E$  at 12 vrs pass under R.R. trestle  
 9  $N 2 34 \frac{1}{4}$  at a point 40 feet West of its East  
 10 end at 463 vrs a point.

11 Thence  $S 58^{\circ} 39' E 180$  vrs point.

12 "  $S 41^{\circ} 45' E 380$  " "

13 "  $S 54^{\circ} 50' E 351$  " "

14 "  $S 88^{\circ} 36' E 365$  " "

15 "  $S 26^{\circ} 51' E 1785$  " "

16 "  $S 19^{\circ} E 3267$  " from which river  
 17 brs  $S 19^{\circ} E$  about 400 vrs

20 Connecting line from a point from which  
 21 a stone mid brs  $N 38 \frac{1}{2} E 25$  vrs (above referred to)  
 22 to a stone mid marked  $\pi$  on edge of bluff on  
 23 Pecos River.

24 Beginning at a point from which a stone  
 25 mid brs  $N 38 \frac{1}{2} E 25$  vrs

26 Thence  $N 79^{\circ} 54' E 5692$  vrs point.

27 "  $N 16^{\circ} 14' E 3495$  vrs "

28 "  $N 34^{\circ} 12' E 252$  " " from which

29 "  $N 25^{\circ} 45' W 95$  vrs to a stone mid on point  
 30 of bluff 125 feet above the Pecos River.

31 Thence  $N 35^{\circ} 52' W 320$  vrs a point.

32 "  $N 30^{\circ} 37' W 228$  "

1 Thence N 8° 16' W at 160 or a stone marked A on  
2 top of 50 foot bluff to S 73 3/4° W 40 or at 537 or  
3 a point.

4 Thence N 6° 13' W 330 or point -

- 5 " N 8° 8' W 820 " "
- 6 " N 16° 39' W 740 " "
- 7 " N 3° 39' W 433 " "
- 8 " N 17° 6' E 236 " "
- 9 " N 27° 28' E 427 " "
- 10 " N 36° 17' E 386 " "
- 11 " N 46° 27' E 157 " "
- 12 " N 52° 33' E 77 " "
- 13 " N 16° W 123 " "
- 14 " N 30° 29' E 182 " "
- 15 " N 40° 12' E 160 " "
- 16 " N 50° 44' E 270 " "
- 17 " S 88° 52' E 333 " "
- 18 " S 68° E 432 " " about 50 ors from bluff
- 19 " East 1045 " " 50 ors from bluff
- 20 " S 61° 52' E 134 " " on top of bluff
- 21 " S 80° E 434 " " on North bank of river
- 22 " N 56° E 40 " "
- 23 " N 51° 5' E 62 " "
- 24 " N 84° 29' E 152 " "
- 25 " N 60° 7' E 183 " "
- 26 " N 71° 21' E 432 " "
- 27 " N 61° 14' E 275 " "
- 28 " N 73° 12' E 778 " "
- 29 " N 88° E 177 " "
- 30 " S 40° 54' E 186 " to a stone mid an edge
- 31 of bluff stone marked H from which natural
- 32 cistern to North about 200 ors

1 Few meanders of Pecos River -

2 Beginning at the end of course  $N 34^{\circ} 12' E 262$  m  
 3 referred to on preceding page from which a stone  
 4 is on an point of bluff 125 feet above the  
 5 Pecos River to  $N 25^{\circ} 45' W 95$  m

6 Thence  $S 51^{\circ} E 373$  m point

7 i  $S 88^{\circ} E 2000$  m mark huge soft lime  
 8 boulder 25 feet long 10 feet thick <sup>any</sup> 15 feet  
 9 high @ on top and roman cross + on west side  
 10 The above boulder is in the bottom of cañon 30 m  
 11 from bluff -

12 August 2<sup>d</sup> 1889

13 D L Reavis

14 State Surveyor

15  
 16 I D. L. Reavis State Surveyor do hereby  
 17 certify that I have actually measured  
 18 on the ground the foregoing connecting  
 19 lines between the points mentioned; -  
 20 that the distances are correct and the  
 21 marks both natural and artificial  
 22 are truly described in the foregoing notes -

23 Given under my hand

24 D L Reavis

25 State Surveyor

J. Forest DeMontel