

WILBURGER COUNTY

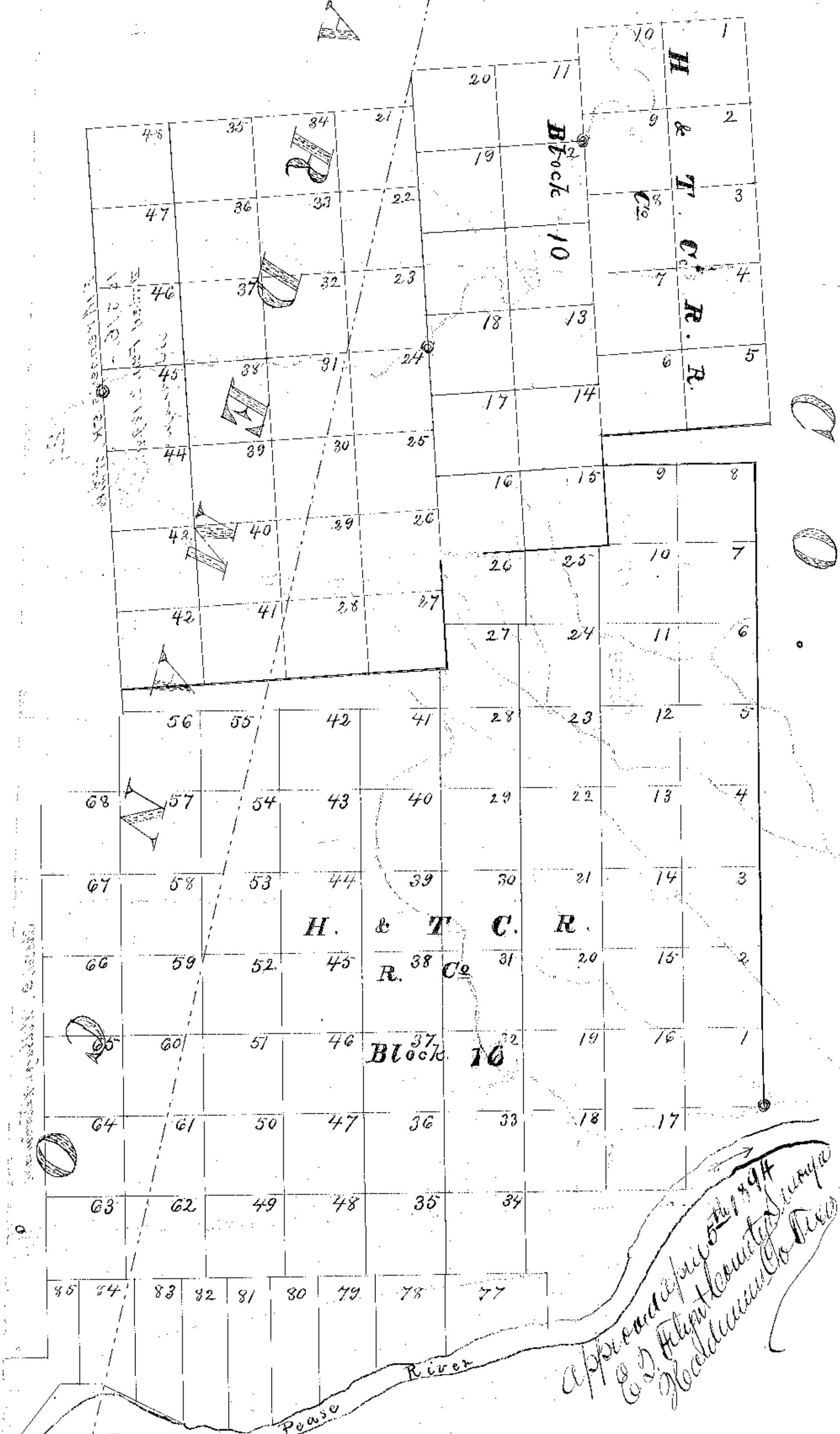

Filed in the General Land Office July 13th 1894

Adams notes filed herewith.
 Chief Clerk
 Feby. 8, 1894

J. R. W. Kenney, Surveyor of Wilbarger County
 do hereby certify that this is a correct map of
 Blks. 10 & 16, compiled from corrected field
 R. W. Kenney
 Surveyor of Wilbarger County Texas.

*Approved by the
 Co. of Plant Counties Survey
 Goodwin Co. Tex.*