

Arroyo de San Juan

Arroyo de Aguirre

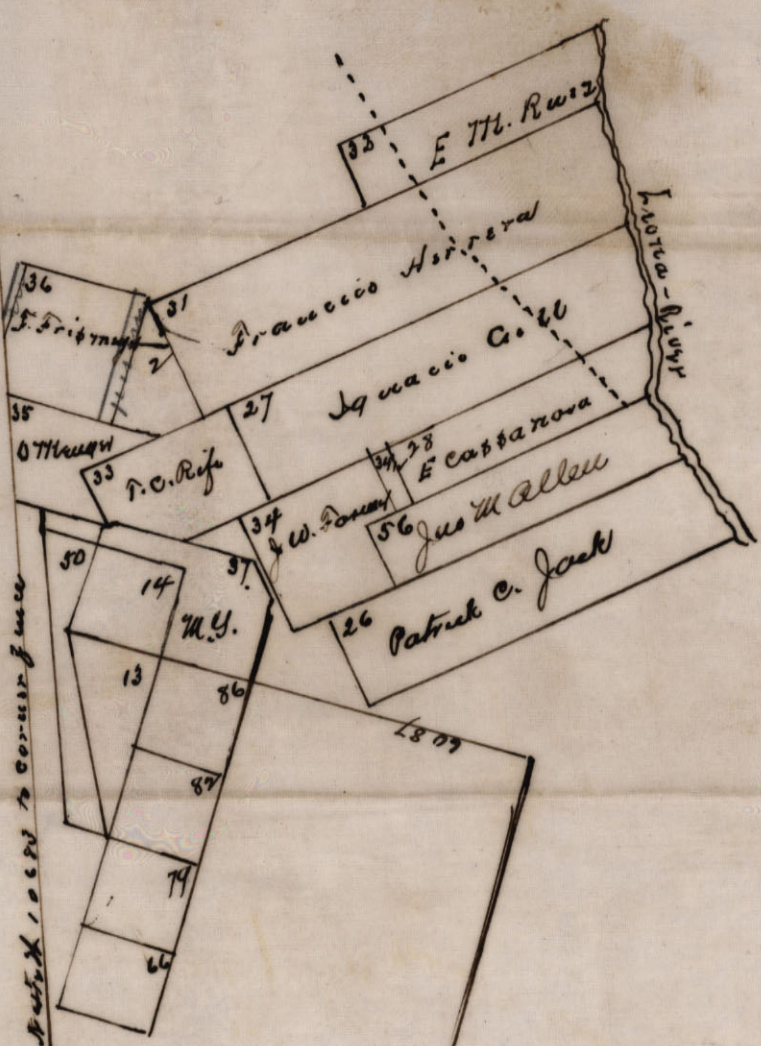

Patrol 10688 to corner of main

Patrol 20423 to corner of main

Patrol 20423

Sketch by Geo Myron
 County Surveyor
 Zavalla Co Texas
 7/15/1899

OFFICE OF GEO. MYERS,
REAL ESTATE AGENT AND COUNTY
SURVEYOR ZAVALLA COUNTY.

A full and complete abstract of all
the lands in Zavalla Co. in office.

Paying taxes and inquiring about
lands in other counties a specialty.

BATESVILLE, TEXAS, 189.....

San Charles Logan

Austin Texas

Dear Sir

Replying to yours of 25th with enclosed
sketch

- Will say you have platted 1st call correct N 4 1/2 W 10683
- " " " " " 2nd " " N 75 E 2170
- " " " " " 3rd " " S 75 1/4 E 3296
- " " " " " 4th " " S 78 1/4 E 207
- " " " " " 5th " " S 38 1/2 E 1333
- " " " " " 6th " " N 65 E 1529
- " " " " " 7th " " N 25 W 1326

on the 3rd call comes first error It is N 65 E at 107400
Yass S. E. Cor No 34 1/2 M. A James at 5986 as center
of Batesville and Union road. You have used the distance
107400 true it is only a part of this call The Union
and Batesville road is 4912 or N 65 E from S E Cor
No 34 1/2 and not 5986 as shown by your sketch

- You have platted the 9th call correct N 46 1/2 W 4980
- The 10th call if platted is not noted on sketch it N 37 1/4 W 37000
- You have platted the 11th call correct N 26 1/4 W 11000
- " " " " 12 " " N 39 W 27400

OFFICE OF GEO. MYERS,
REAL ESTATE AGENT AND COUNTY
SURVEYOR ZAVALLA COUNTY.

A full and complete abstract of all
the lands in Zavalla Co. in office.

—
Paying taxes and inquiring about
lands in other counties a specialty.

BATESVILLE, TEXAS, *2*

189.....

You have platted the 13th call correct 2327 2098
" " " " 14th " " " 2658 5040

The 13th call is 600 and not 60000 as shown
by your sketch

When you correct your sketch I trust you
will find that I am correct

The South line of Cassanova is not as long
as called for in original notes so you must be guided
by data such you as to other line

Referring to original corners of this side of river
that can now be identified are the upper corner of the
Ruiz and the lower corner of the Allen. The upper corner
of the Thomas was standing several years ago but would
have before I ever got a connection to it. I further
could only show me with in a few feet of when it stood

After correcting if every thing is not plain
I will send you in sketch on a large scale

Yours truly
Geo Myers

P.S. The west line of the Oscar Whiggin calls for 2199
Your plat shows abt 2500 or

Box 1.

Zavalla Co

Sketch A1, Connecting
Lines, &c. &c. &c.

George Myers

SK + Concty Lines. A 1

Zavalla, on Leona
River, between Antonio
Aguirre Grant & said
river.

Filed July

25th 1899

Chf Clerk