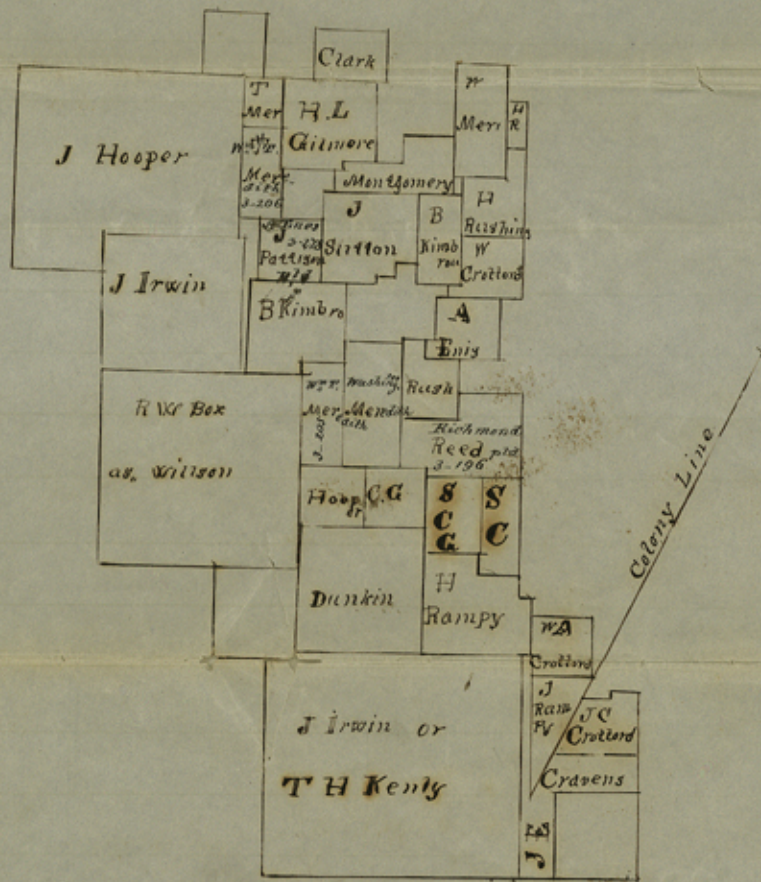

Plate 11.
and 11a.

Anderson Co.

C. the N.W. corner of the
County west of catfish Bayou
on Otter Cr. 2 Sh.

1. Rec^d 9 July 1853
2. " March 25/54. (Sketch 11a)



I James E League County Surveyor of Anderson
 County do certify under my oath of office that
 the above sketch is correct according to the records
 in my office all closing survey will except a
 survey for Montgomery which appears by platery
 that the west Boundary line is too long this being
 the closing survey given under my hand at
 Palmetto June 28th 1833

~~W.D.~~ Sketch

File 11

Anderson Co.

West of Catfish Bayou or
Otter Creek

2 1/2 Mi. N. 50 W Palestine

Rec^d 9 July 53

Geo. C. ...

~~W.D.~~

COUNTER # 12767