

Angelina Co.

below B. A. Mudd's League
 on Angelina River
 Rec^d Sept 15th 1858

Situated about

18 Miles S. 70 E. of Homer.

Surreys on Angelina River,
 25 Miles. S 65° E from Lufkin.

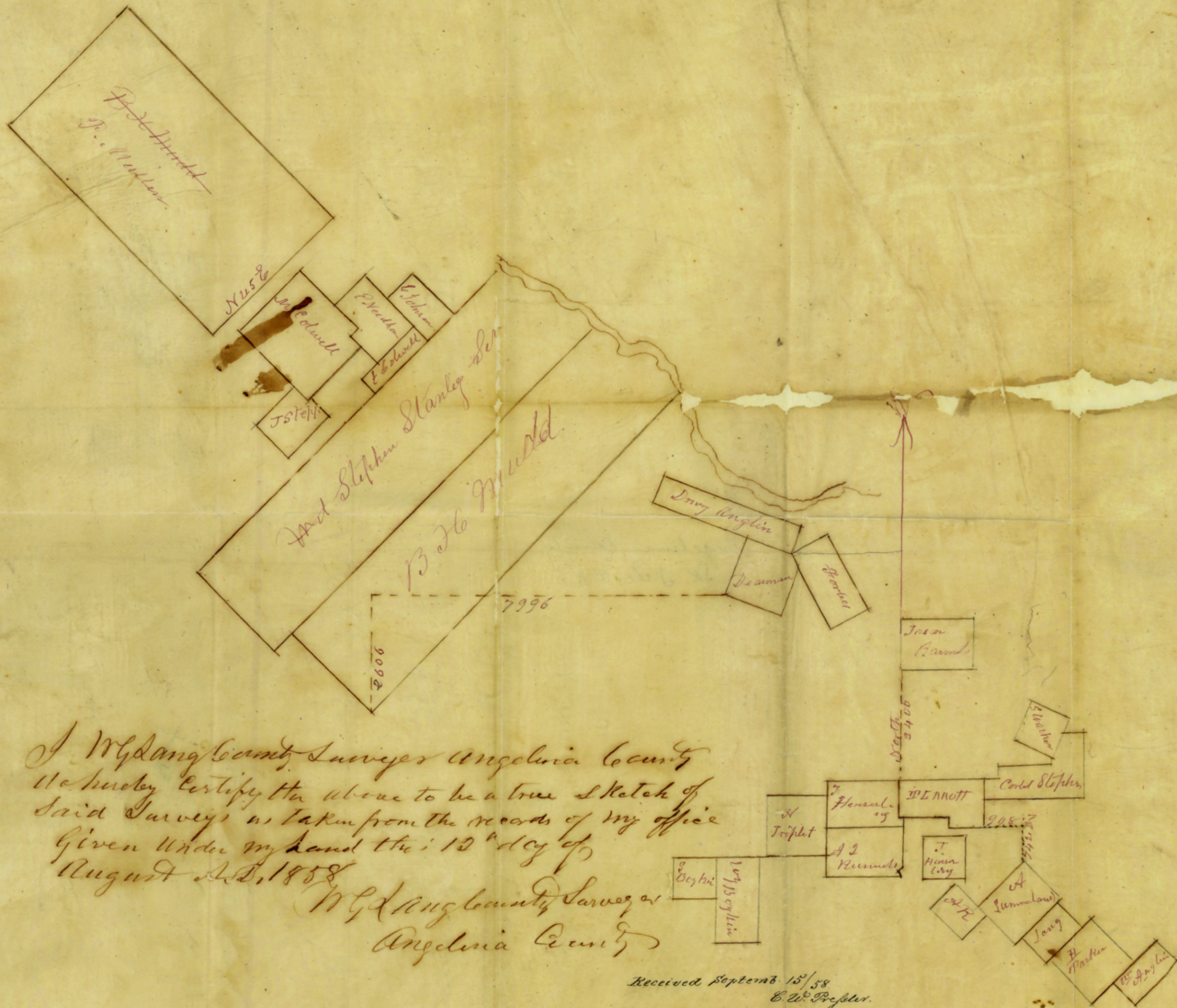

I, Wm Lang County Surveyor Angelina County
 do hereby certify the above to be a true sketch of
 said survey as taken from the records of my office
 given under my hand the 12th day of
 August A. D. 1858

Wm Lang County Surveyor
 Angelina County

Received Septemb. 15th / 58
 C. W. Prepler.