

This beginning at McCarper S.E. Corner by the C.S. A. C. & J. Depueville between the bearing line in Casper field. Notes evidence one bears S $42^{\circ} E$ 408' of the other bears S $4^{\circ} W$ 267' or thereabouts 109 vs Neg E 170° to the Water of Arkansas bay an amount 1/2 then of the Water line to W. See maps the Water line deared the Survey one go N. the other south leave Vacant land West of Crocobia & South of N.E. of T. Williams Survey for the Survey Point

A to 3

A to 3

Stand

Crocobia

Williamson Ar 25

Vacant

ARANSAS BAY

the bearing live Oak line the corner S E Corner

against the law

against the law

from these line North show the Vacant land on the North see the Blue line from their go south then go north from their line toward co. P.A.C.

This line is division line as presented by R.H. Wood and Phillips a stake no object any stake the Blue line or Water line the Call of the title the green presentat the Vacant the Water line or Mendears of Arkansas bay was run by S. Pensavall C.S. P.C. see N. and S. of said line and mak your opinion

Error shall be 165.6 to the corner of Grandbig Homestead

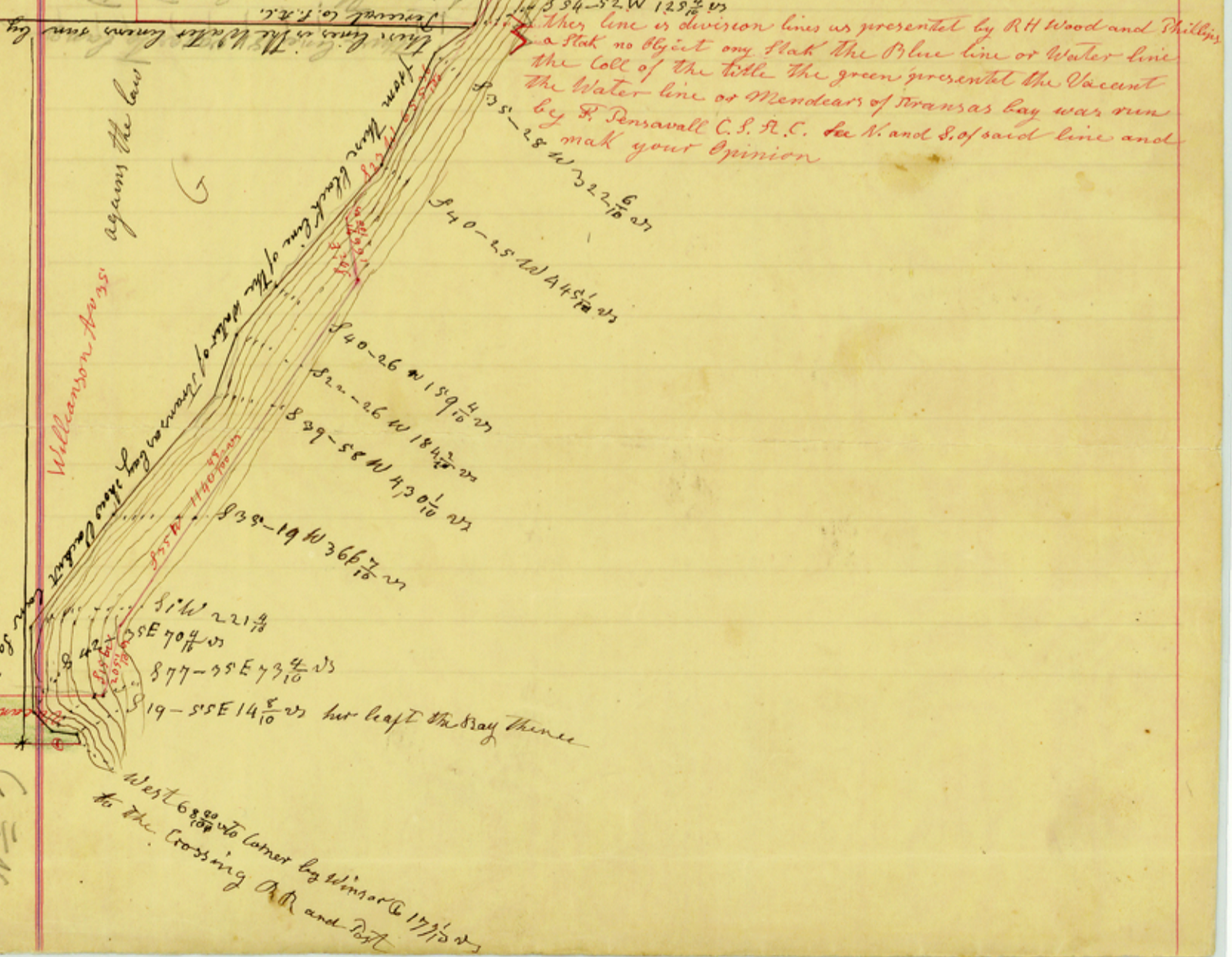

St. File No. 21(d)

Aransas County

St. of sur. at Rockport

by

F. J. Frandolig