

Plot to show the connection of the surveys made  
for John Atkinson on Sandy creek

by  
D. Charles C. Amthor  
District surveyor

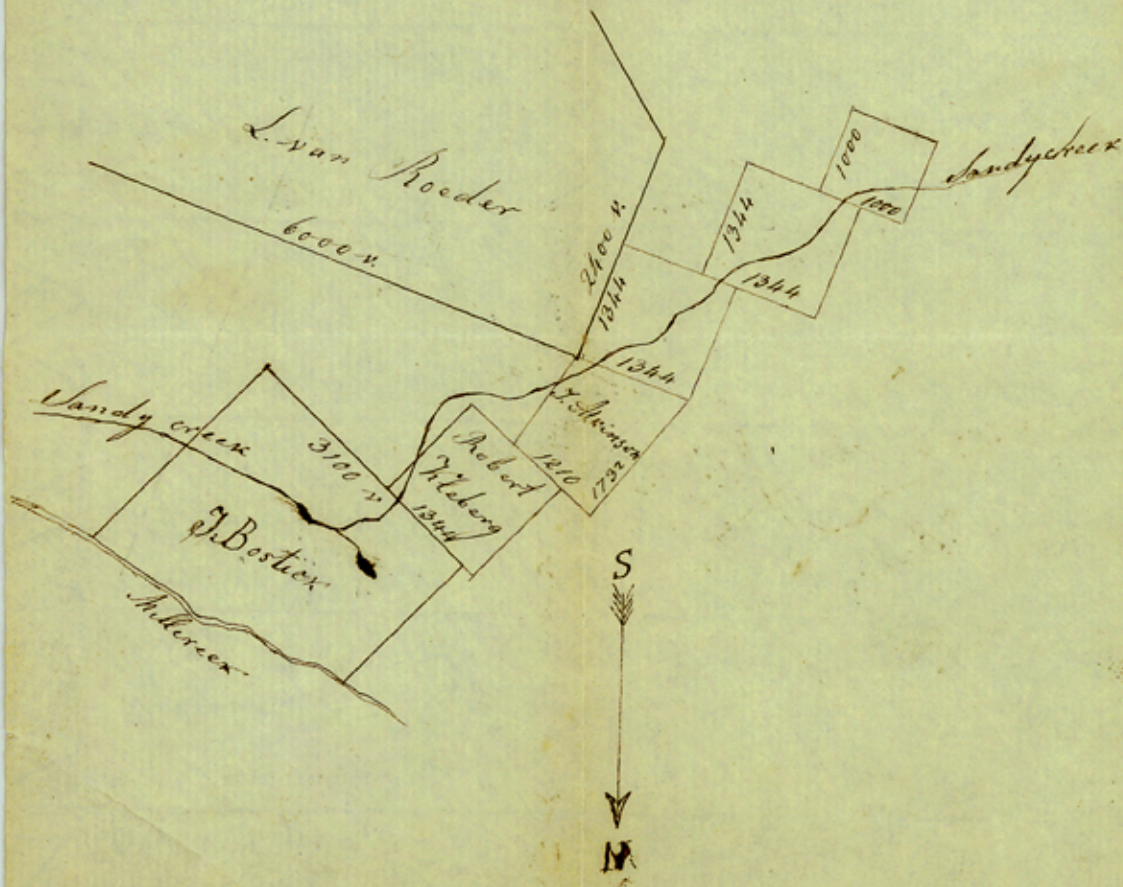

Sketches — File 2

— Austin Dis. —

Sandy Cr. - W. branch.  
of Mill Creek.  
rec'd. Febr'y. 22. 1849.

Plotted on map.

Situated  
S. W. of Bellville

6 Mi. S. 60° W. Bellville

Surveys on Sandy Cr.

County 13856

Sketch for  
Dunghillman