

File No. Sk. File 15  
Austin County

Filed 1894 ~~19~~ #15  
J. EARL RUDDER, Com'r.

By \_\_\_\_\_  
*Part of sk. File 8?*

*Meanders along San Benard*  
*by A. Ludwig*  
*#15*

J. EARL RUDDER  
COMMISSIONER  
GENERAL LAND OFFICE  
AUSTIN 14, TEXAS



*Counter 13882*



Count 13883

1883 returned

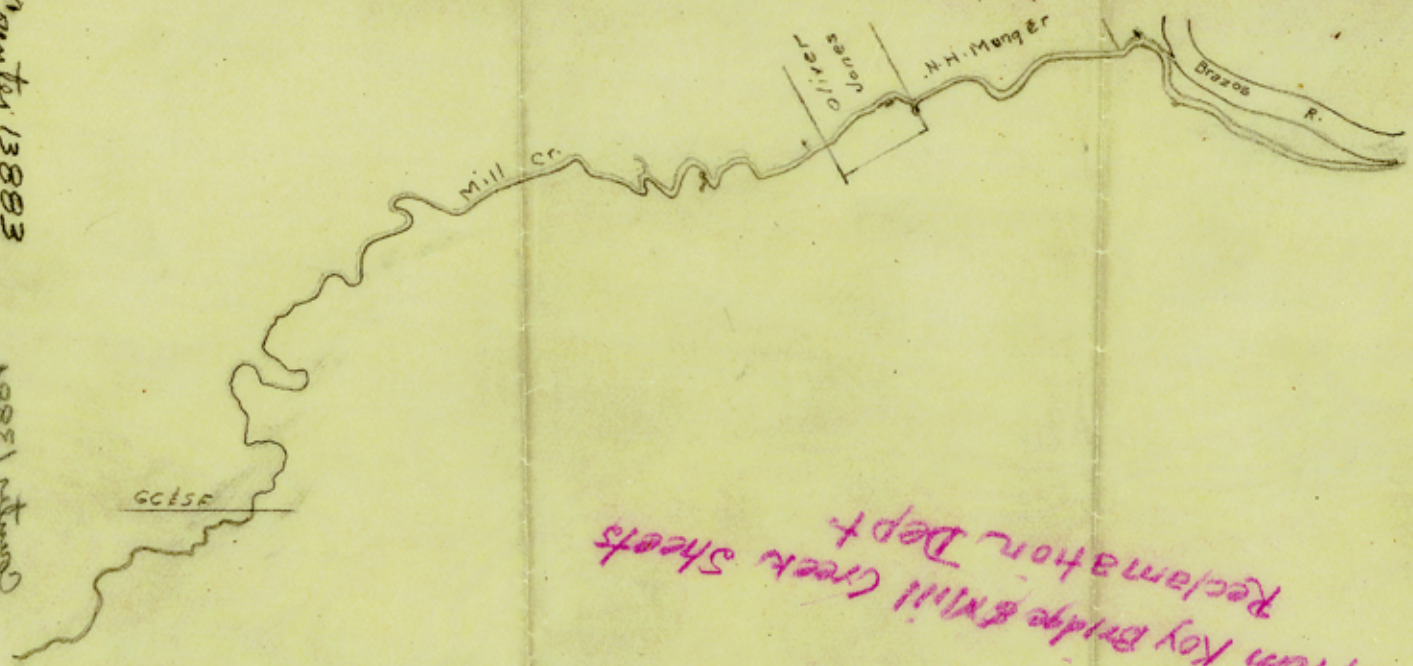

Reduced  
 From Roy Bridge & Mill Creek Sheets  
 Reclamation Dept

CO N. H. Menger  
 21 2/3 1/2

Mill Creek



Mill Creek

Austin Co  
sk. File 15

Reduced  
From Roy Bridges Mill Creek sheets  
Reclamation Dept

Countdown 13884

ES821 Johnson

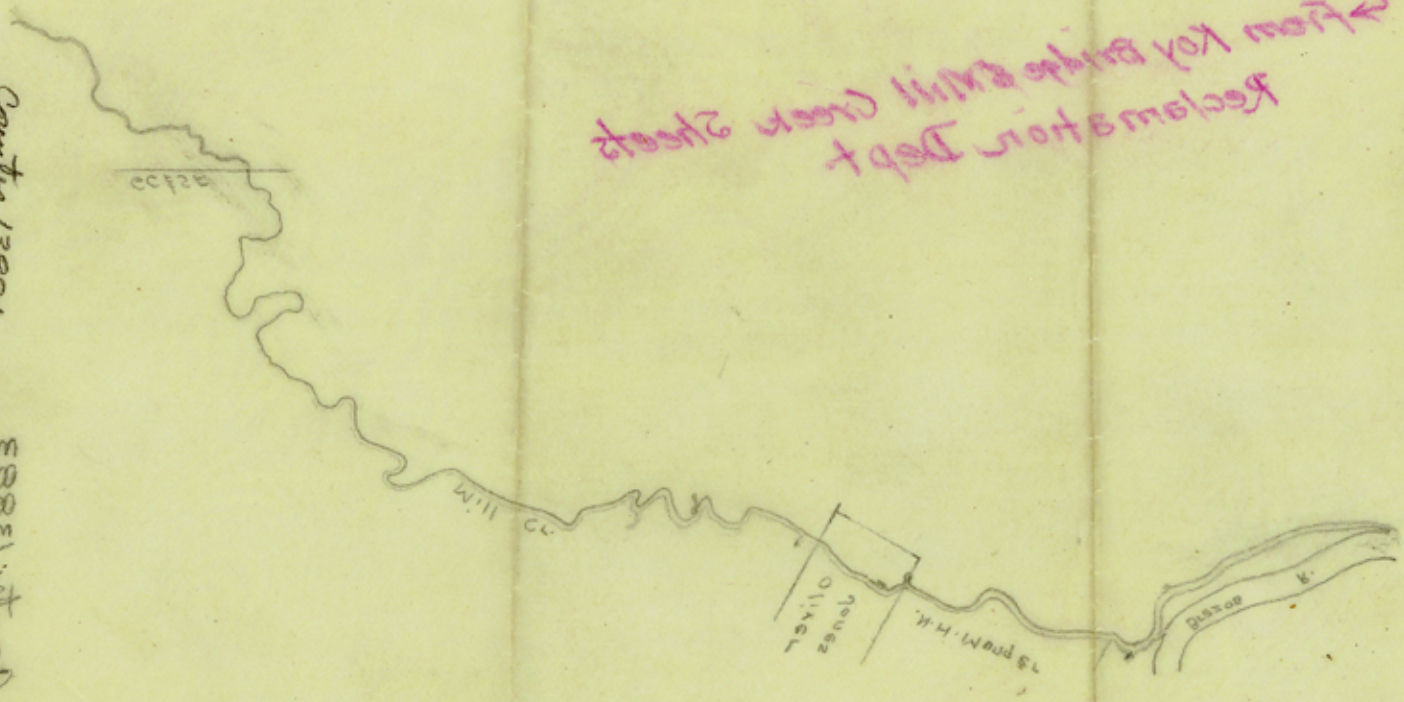



Meanders of old Channel from South  
line of Frisviss Up

N 47 1/2 W 340

S 70 W 420

N 85 W 170

S 82 W 280

S 57 1/2 W 240

S 43 1/2 W 150 beginning

S 81 W 180

of devils bend

N 88 W 130

N 68 1/2 W 320

N 35 1/2 W 130

N 56 1/2 W 290

N 40 W 280

N 46 W 110

N 62 1/2 W 230

S 87 1/2 W 330

N 55 1/2 W 595

N 77 1/2 W 252

S 76 W 100

S 52 1/2 W 80

S 50 W 140

S 45 W 100

S 40 1/2 W 270







AUSTIN COUNTY COURT HOUSE.



COUNTY OFFICERS  
 S. R. BLAKE, Co. JUDGE. G. S. CUMINGS, Co. CLERK.  
 J. W. GOODE, DIST. CLERK. W. I. GLENN, Co. ATTY.  
 W. B. GLENN, SHERIFF. C. LANGHAMMER, TAX COL.  
 C. H. BROSSMANN, TREAS. A. LUDWIG, SURVEYOR.  
 OTTO WANGEMANN, TAX ASSESSOR.

COMMISSIONERS  
 D. WILLRODT, PRECINCT NO. 1.  
 MAX MEISSNER, " " 2.  
 HENRY VORNKAHL, " " 3.  
 EMIL RINN, " " 4.

Bellville, Texas, July 5. 1894  
 Sealy

M. A. Westcott Esq.  
 Houston.

Dear Sir:

The following are the meanders of the San Bernard  
 from North line of Trisius down:

First S' 75° 30' E 80 vrs.	N 79° 30' E 90 vrs.
S' 70 E 140 "	N 85 E 620 "
S' 80 E 120 "	S' 64 E 100 "
S' 85 E 100 "	S' 66° 30' E 60 "
S' 50° 30' E 150	S' 57 E 200 "
S' 72° 30' E 310	S' 48° 30' E 75 "
S' 56° 30' E 140	to South line of Trisius
S' 41 E 160	Thence across the San
S' 35° 30' E 140	Bernard with said S. line
S' 34° 30' E 120	<u>S' 45 W 180 vrs. to Center</u>
S' 53° 30' E 330	<u>of old R Channel</u>
S' 69° 30' E 340	

Respectfully  
 A. K. Sealy

h'



COUNTY OFFICERS  
 S. H. BARKER, Judge  
 J. WOODRUFF, Clerk  
 W. C. LEECH, Co. Atty.  
 C. G. HANCOCK, Tax. Ass.  
 W. B. GLENN, Sheriff  
 C. G. BROWN, Treas.  
 O. T. WARDMAN, Coroner

COMMISSIONERS  
 D. WILSON, Precinct No. 1  
 MAX MESSER, " 2  
 HENRY YORKMAN, " 3  
 EMIL BIRN, " 4



1874

Austin Co  
 Sk. File 15

Mr. A. M. Westcott  
 (Part of 7?)

Dear Sir:

The following are the members of the San Antonio  
 from that list of names given:

275	200	80	200
270	140	182	200
265	120	204	200
262	100	202	200
250	120	227	200
245	200	248	200
242	200	to that list of names	
237	100	then were the	
232	140	Removal will be	
224	120	242	180
213	200	of old N. County	
209	240		

Respectfully,  
 O. B. ...