

Nº 12.
NATE
3-1814

18

15

14

13

17

16

Nº 11.

3198

3197

Nº 10

Nº 8

Nº 9

Nº 6.

Nº 7.

1087

S Counter 14119

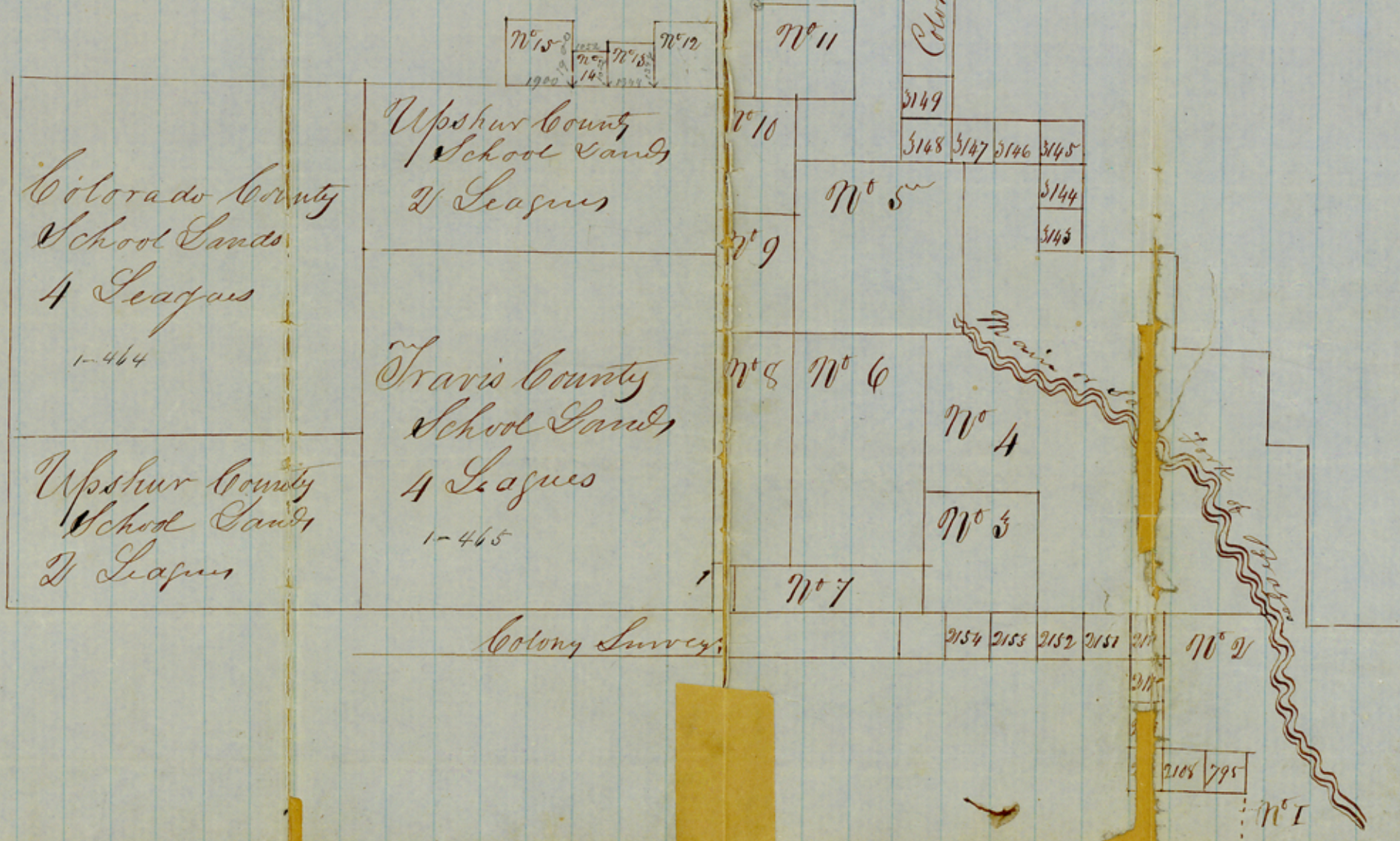

Counter 14120

5

School Land. Pla

File 2.

~~File 31~~

Cooke County.

On the West boundary line of
Cooke & Denton district.

Plotted on Map Feb. 1856

File
18

Praylor Co.

Counter 14121

52

South Fort County.
 County School Leagues
 3 Sketches
 Baylor County
 File 5

48

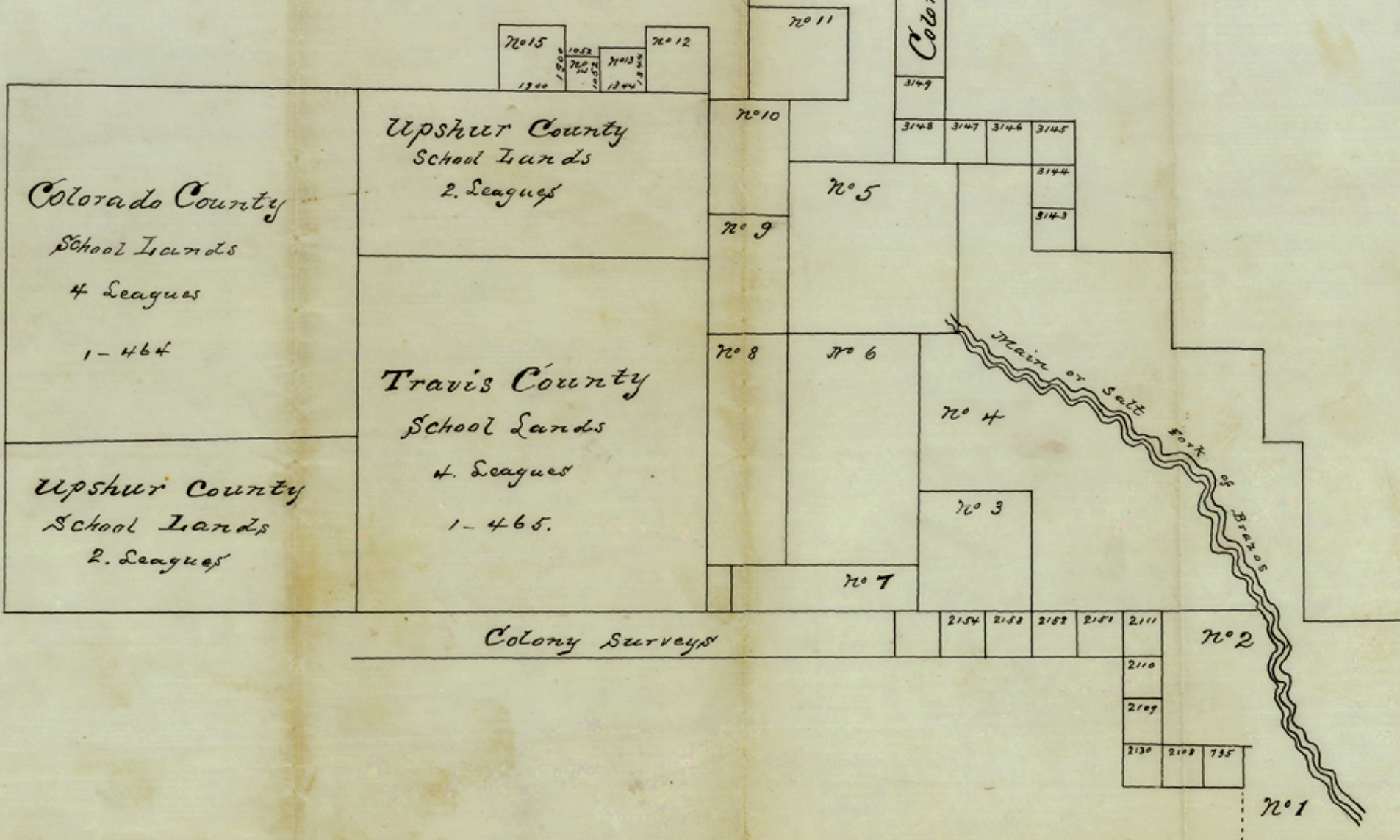

ES 171 returned Counter 14122

48

54

SSIA Natural Counter 19123

File 2
 Baylor County
 35 sketches
 County School Leagues
 South Part County.

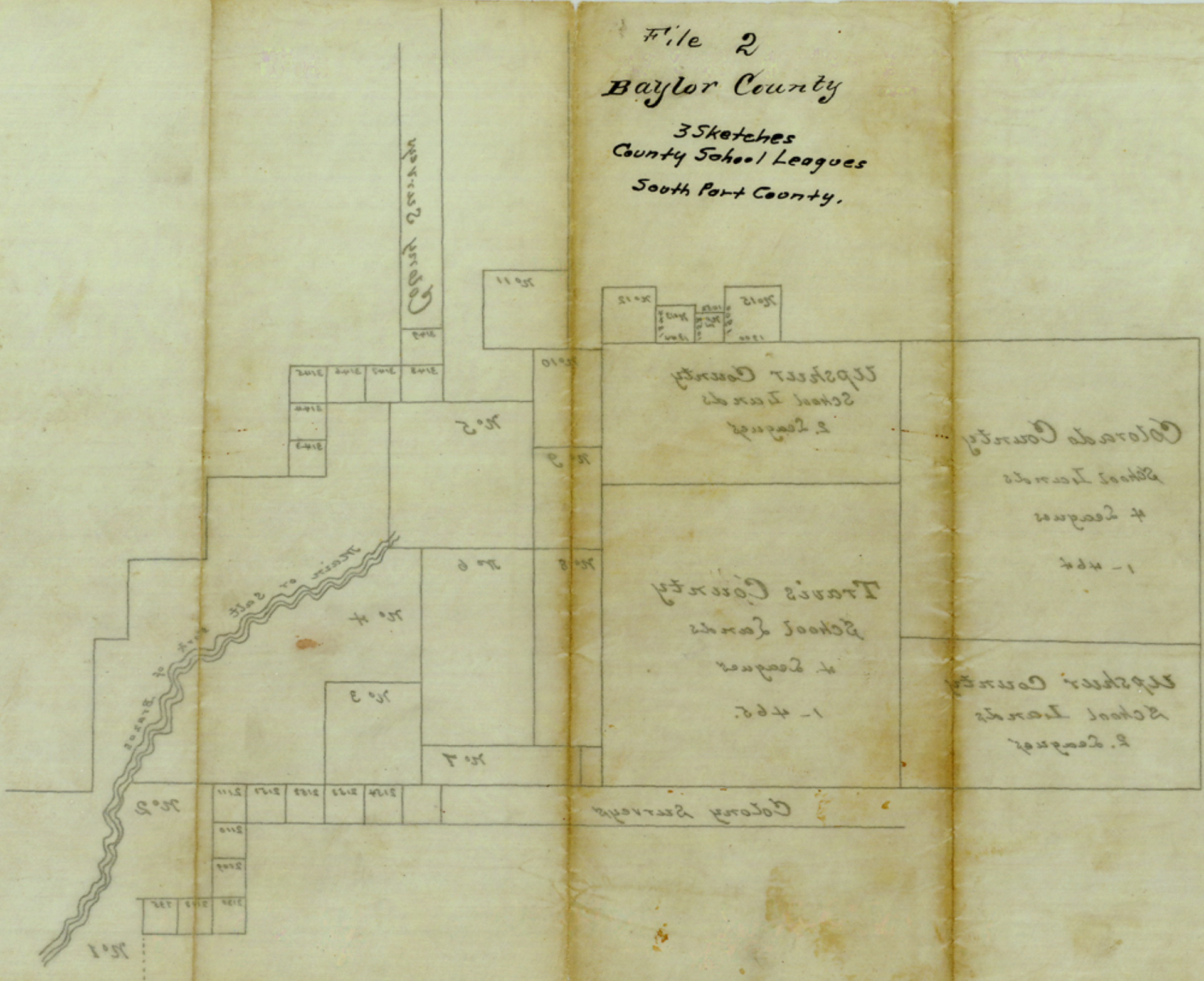

5