

Filed 11/21/90

The State of Texas, } Survey No. \_\_\_\_\_  
County of Baylor } Block No. \_\_\_\_\_

Corrected Field Notes of a survey of a Acres of  
Land, made for the a Connecting line  
RAILROAD COMPANY, by virtue of Certificate No. \_\_\_\_\_

Variation 10.20 East.

issued by the Commissioner of General Land Office.

Situated in Baylor County, on the waters of Little Wichita  
a tributary of Big Wichita River, about 6 miles N. E  
from Seymour and known as Survey No. \_\_\_\_\_ in Block ~~№~~ 11 of T. & N. O. R. R. Co

Beginning at a Stone md. located by me for N. W. corner of  
Survey No. 109 - T. & N. O. R. R. Co. from which a meridian  
brs. or 49 3/4 W. 247 1/2 vs. - Thence North 793 vs. a point  
Thence S 22.13 W. 246 vs. to an old Rock md. located  
by Schafer and adopted by me for the N. E. corner  
of Survey No. 170 - Thence West 1958 vs. an old  
Rock md. the original N. W. corner of 170 - T. & N. O.  
R. R. Co. Survey.

Bearings marked X Re-Surveyed, July 7th. 1890  
David Beatty }  
Doc. Mott } Chain Carriers.

I, R. W. Keeney State Surveyor, do hereby certify that the foregoing  
Survey was made actually on the ground according to law, and that the limits, boundaries and corners, with marks, natural  
and artificial, are truly described in the foregoing plat and field notes.

Approved, R. W. Keeney State Surveyor.  
Counter 14139

2

The State of Texas, } Survey No. \_\_\_\_\_  
County of Baylor } Block No. \_\_\_\_\_

Corrected Field Notes of a survey of \_\_\_\_\_ Acres of  
Land, made for the Connecting line  
RAILROAD COMPANY, by virtue of Certificate No. \_\_\_\_\_

Variation 9.48 East. issued by the Commissioner of General Land Office.

Situated in Baylor County, on the waters of Little Wichita  
a tributary of Big Wichita River, about 17 miles N.E  
from Seymour and known as Survey No. \_\_\_\_\_ in Block No. T & N. O.

Beginning at a Sand Stone set in the ground and located  
by me for S.W. corner of Survey No. 7, H. & T. C. R. R. Co.  
B.K. No. 4. Thence West 1538 ns. a point, thence  
S. 36.24 W. 254 ns. to a Rock wd. the original N.E.  
corner of Survey No. 94 T & N. O. R. R. Co.

*On the line of  
Baylor Co.*

Bearings marked X Re-Surveyed, May 13th. 1890

David Beatty  
S. J. Fergesow } Chain Carriers.

I, R. W. Kenney State Surveyor, do hereby certify that the foregoing  
Survey was made actually on the ground according to law, and that the limits, boundaries and corners, with marks, natural  
and artificial, are truly described in the foregoing plat and field notes.

Approved, R. W. Kenney State Surveyor.

Counter 14140

The State of Texas,

Survey No. \_\_\_\_\_

County of Baylor

Block No. \_\_\_\_\_

Corrected Field Notes of a survey of a Acres of  
Land, made for the connecting line  
RAILROAD COMPANY, by virtue of Certificate No. \_\_\_\_\_

Variation \_\_\_\_\_ East.

issued by the Commissioner of General Land Office.

Situated in Bay Co County, on the waters of Big Wichita  
a tributary of Red River, about \_\_\_\_\_ miles

from Seymour and known as Survey No. \_\_\_\_\_ in Block No. I & N. O. R. R.

Beginning at a stone rod the original N. E. corner of 142  
I & N. O. R. R. Co. - Thence va. 10- N. 1900 ws. to the  
N. E. corner of survey No. 141 - Thence changing va. to 10.51  
N. 52.00 ws. to the N. E. corner survey No. 3. - Thence va. 10.15  
run west 1985 ws. to a rock rod the original N. W.  
corner of survey No. 3. I & N. O. R. R. Co.

Bearings marked X ~~Re~~ Surveyed, April 1890

S. J. Fergeson  
David Beaty } Chain Carriers.

I, R. W. Kenney State Surveyor, do hereby certify that the foregoing  
Survey was made actually on the ground according to law, and that the limits, boundaries and corners, with marks, natural  
and artificial, are truly described in the foregoing plat and field notes.

Approved, R. W. Kenney State Surveyor.  
Counter 14141

Q2

The State of Texas, } Survey No. \_\_\_\_\_  
County of Baylor } Block No. \_\_\_\_\_

Corrected Field Notes of a survey of 0 Acres of  
Land, made for the connecting line  
RAILROAD COMPANY, by virtue of Certificate No. \_\_\_\_\_  
issued by the Commissioner of General Land Office.

Variation \_\_\_\_\_ East.

Situated in Baylor County, on the waters of Big Wichita  
a tributary of Red River, about \_\_\_\_\_ miles  
from Seymour and known as Survey No. \_\_\_\_\_ in Block No. T & N. O.

Beginning at a st. md. the original N.E. corner of Survey  
No. 142 T. & N. O. R. R. Co. Thence va. 10° North  
1900 ws. the N.E. corner of #141 - Thence va. 10° 51' -  
North 1372 ws. the N.E. corner of No. 1 - Thence va. 10° 15'  
East 3986 ws. to a st. md. the original S.E. corner of No. 16  
T. & N. O. R. R. Co.

Bearings marked X ~~Re~~ Surveyed, April 1890.  
} Chain Carriers.

I, R. W. Keeney State Surveyor, do hereby certify that the foregoing  
Survey was made actually on the ground according to law, and that the limits, boundaries and corners, with marks, natural  
and artificial, are truly described in the foregoing plat and field notes.

Approved, R. W. Keeney State Surveyor.  
Counter 14142

23

Connecting lines  
in N + N. C. R. R. Bks

Taylor County -

Taylor Co. st. File #9

Counter 14143

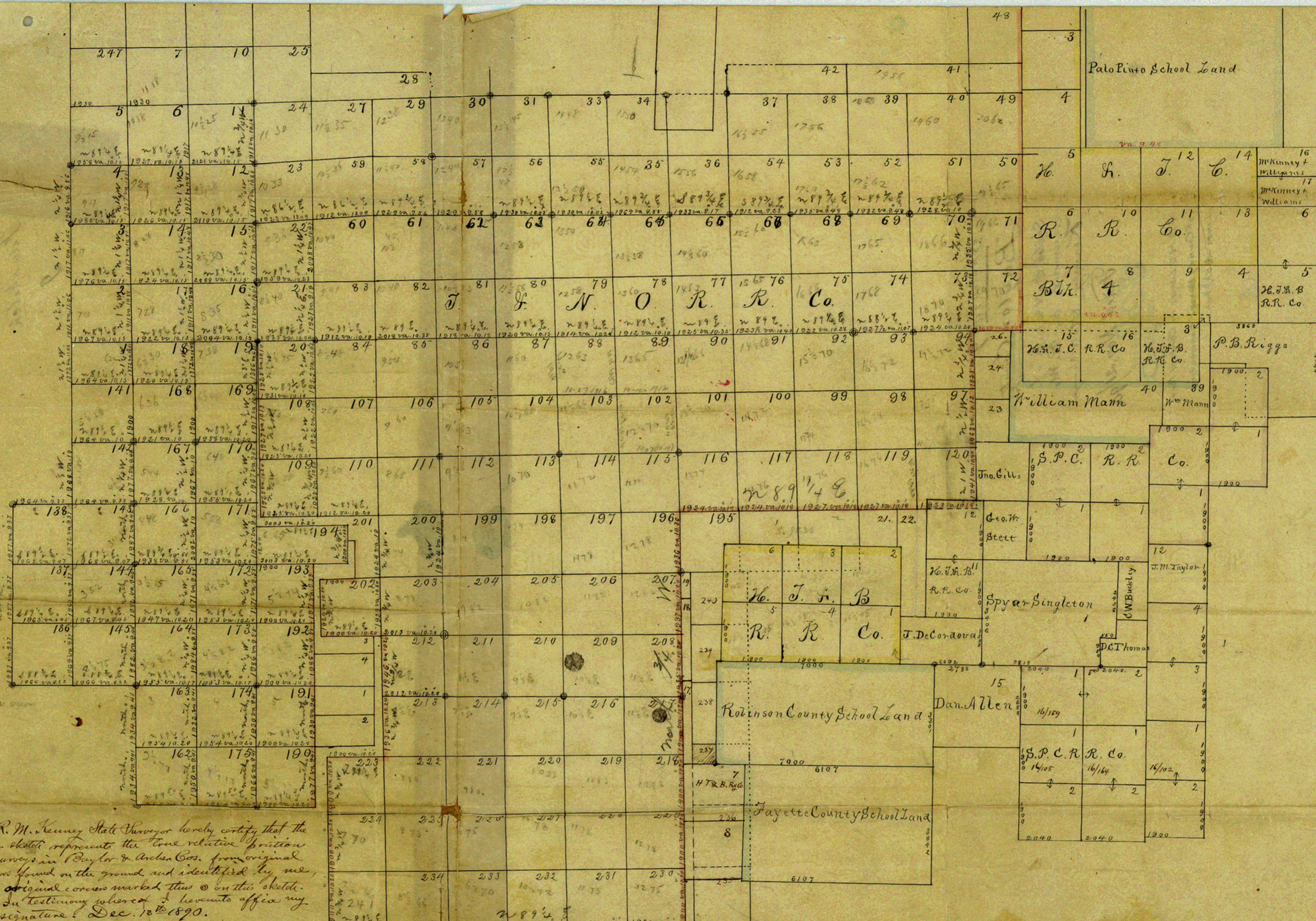

I, R. M. Kenney State Surveyor hereby certify that the above sketch represent the true relative position of surveys in Baylor & Archer Cos. from original corners found on the ground and identified by me, said original corners marked thus ⊙ on this sketch. In testimony whereof I hereunto affix my signature Dec. 13<sup>th</sup> 1890.

R. M. Kenney  
State Surveyor

File Sketch

9

Sketch File 9.

Baylor County.

Sketch East & N. E. of  
Seymour by R. M.  
Kenney State Surveyor

Filed Nov. 21/90.

R. M. Kenney  
CHIEF CLERK.

T. & N. O. Lands in Central Part  
of County Kenney's Connecting  
Lines - & Sketch.

A 850

COUNTER # 78862

Baylor Co. St. File # 9

County  
Portico