



State of Texas
 District of Millam
 I do Certify that the above
 sketch is a correct representation of the Sur-
 vey returned to this office by Matthias
 Wilberger Deputy Surveyor of said District
 Given at Caldwell this 24th day of April 1848
 James Howlet
 District Surveyor

Bell File 3
1838

File 15

Milam Dist.

Sketch - I. of Sampalga
received. May 20. 1848

Plotted on map. May. 22. 48.

Bell County

About 7 m. S. 40 W
of Belton.

Sketch File No. 3.

Bell County

Old Surveys on Lampasas
and Salado Rivers.

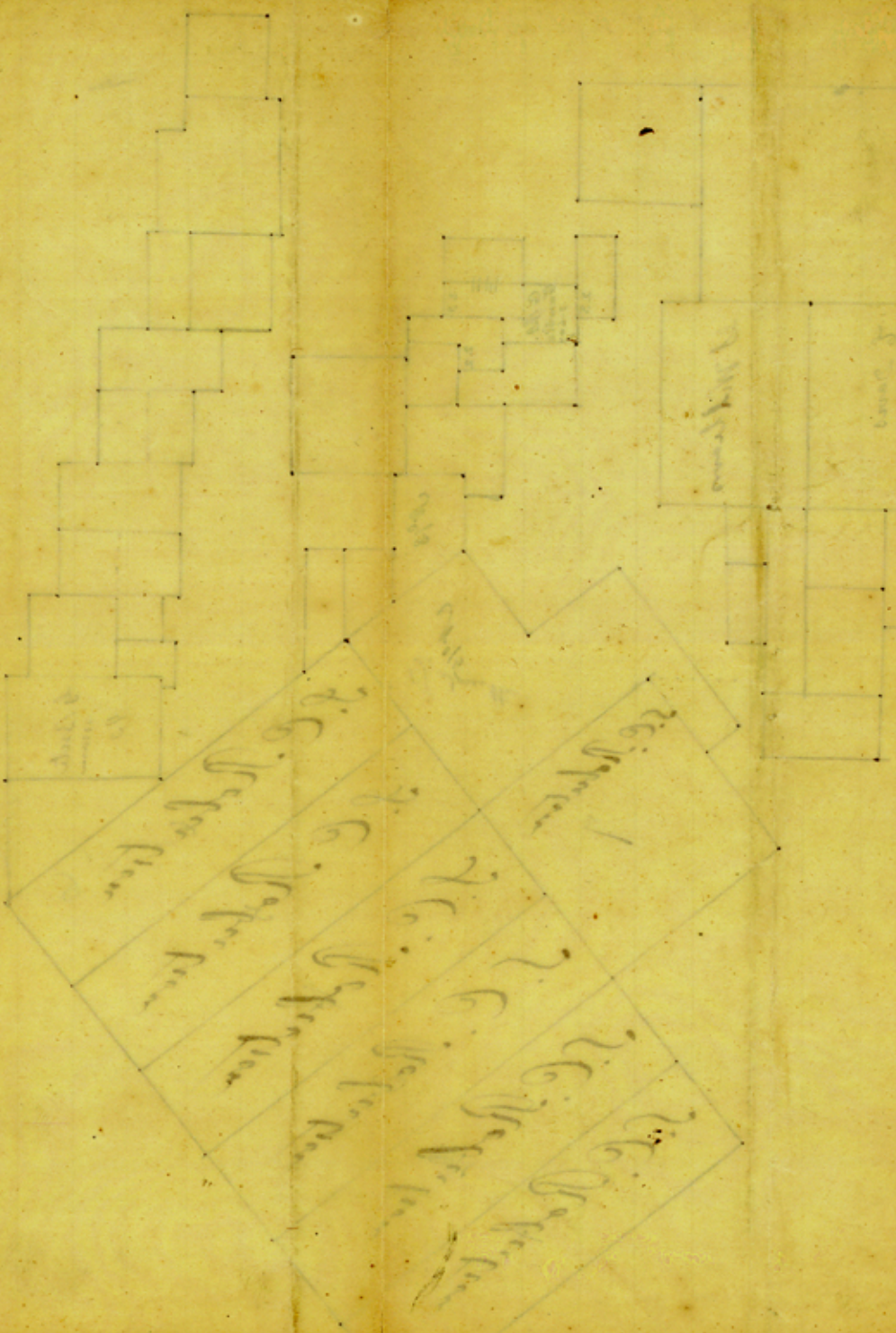

[Faint, mostly illegible handwritten notes in cursive script, likely describing survey details or land ownership.]

County 14368