

Bell Co

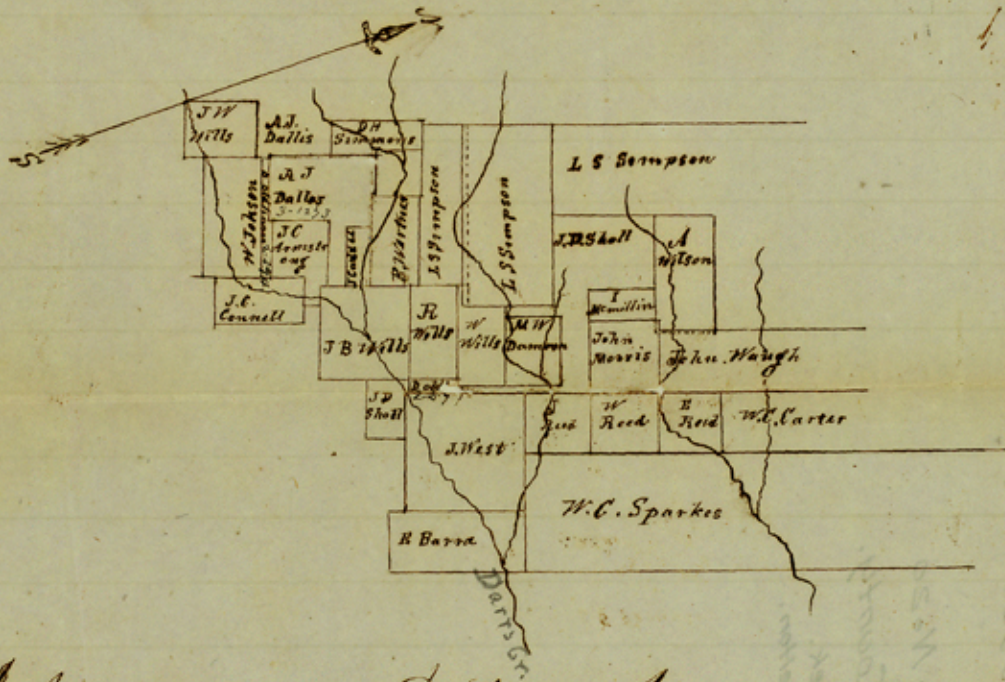

I Isham Mcmillin District Surveyor for Indian Land
District do hereby Certify that the above sketch
is correct, Given under my hand this 25th July 1855

Isham Mcmillin
Surveyor for Indian
Land District

Pat. 67, Bell C

Rec. July 27th 1855

July 20
Bell Co.

J. G. Coffey Belton

St. File No 20
Bell County.

On Dart's Creek.
13 Mi. S. 15° E. Belton.

Vertical handwritten notes on the left edge of the page.

Vertical handwritten notes in the center of the page, partially overlapping the map.



County 1907