

Bell County.

Compiled January 27<sup>th</sup> 1870. by Schumann.

12 Mi. S. 25 W Belton

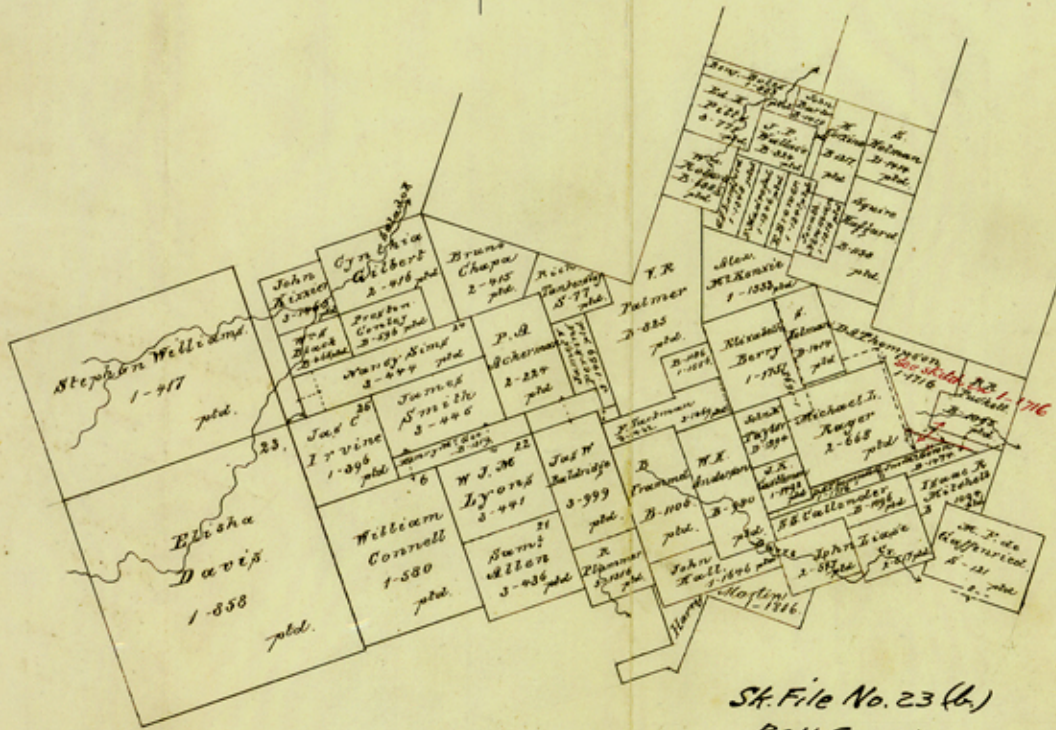

Sk. File No. 23 (b.)  
Bell County  
12 Mi. S. 25 W. Belton  
Office Sketch.



Sk. File No. 23 (a)  
Bell County  
15 Mi. S. 15 W. Belton

Scale 2000 ft to an inch

15 Mi. S. 15 W. Belton

302  
207  
509

204  
1666  
3482  
5050

Counter 14416

South

Feb 1806

McLain 19

Sketch

File 23(a)

Sk. Files 23(a) & 23(b)

Bell County

Harvey Martin's  
Survey.

S. by W. of Belton  
adjoining Williams  
son County.

Sk. File 23(a)

Sketch of  
Harvey Martin's  
Survey in Bell Co.

Counter 14417