

The State of Texas  
 County of Travis

Survey of the Connection between  
 the Surveys on the Cypress of the Cardinals and  
 the Surveys on the Cypress of the Colorado.

Beginning at the South East Corner of S.  
 Royster's Survey No. 1. Thence N. 31° E. at 11,450 Varas 1<sup>st</sup>  
 Station, Thence N. 59° E. at 900 Varas 2<sup>nd</sup> Station. Thence  
 N. 31° E. at 430 Varas to the S. E. Corner of Survey No. 257. Made  
 for Alexander Cans ass. Thence S. 35° 30' W. at 11,700 Varas  
 the beginning

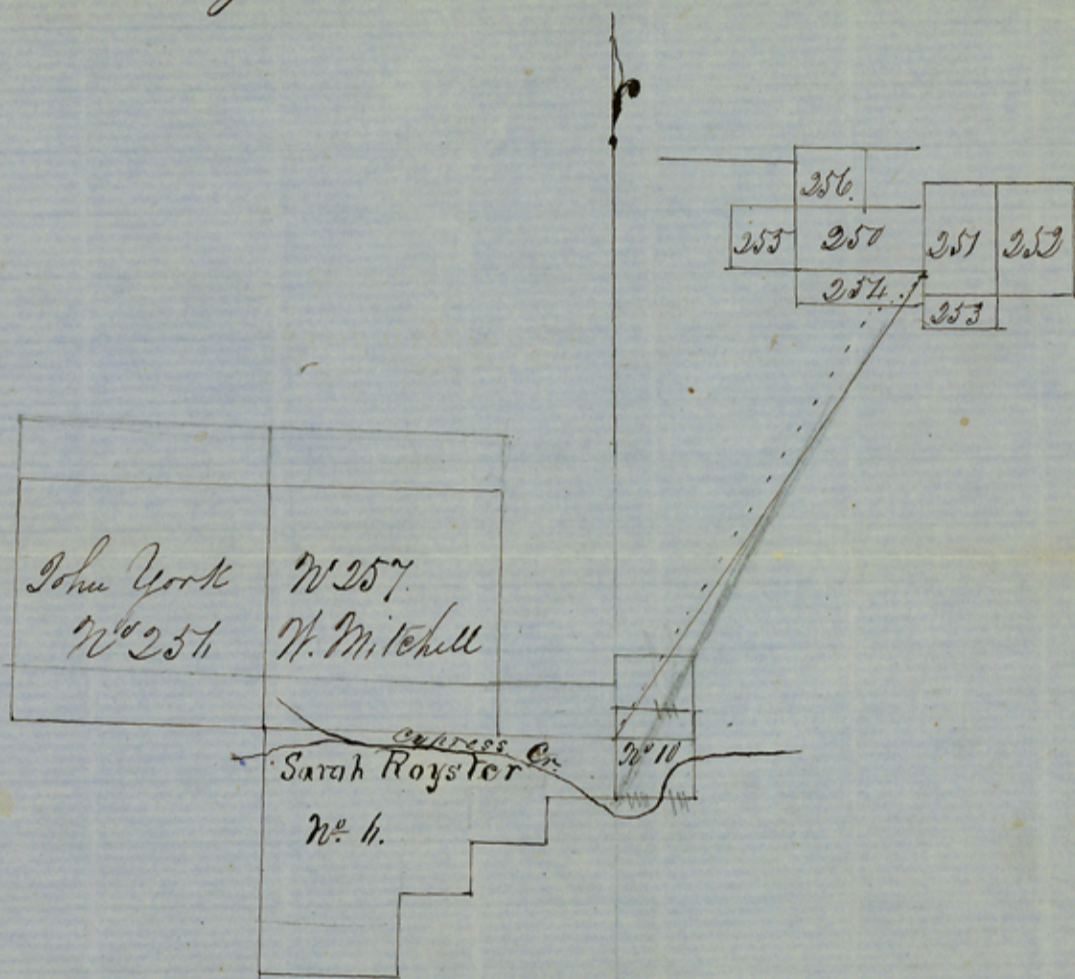

J. C. S. Mann a Special Deputy appointed to make the  
 foregoing survey do solemnly declare that the foregoing  
 plat and field notes represent truly the Connection of  
 the aforesaid Work. May 14<sup>th</sup> 1853.

Jas M. Swisher  
 J. C. Collins } Chairman

J. C. S. Mann  
 Special Dept.

described therein.

Surveyor Travis District.

I, H. L. UPSHUR, District Surveyor for Travis District, do hereby certify, that I have examined  
 the foregoing Plat and Field Notes, and find them correct; and that they are recorded in my office, in  
 Book No. , page

H. L. Upshur  
 District Surveyor, Travis District.

Austin, May 16<sup>th</sup> 1853.

Counter 14588

File 10. Blanco/68

U.S.G. File No. 10.

~~File 24~~  
Blanco Co.  
Travis District

Connection between the  
Colorado work - and the  
Pedernales work - in  
Barnet County -

Seays & Barnet Co.

On Map  
Blanco Co.

North East corner.  
12 Mi. N. 50 E Johnson City

Counter 14589