

File 3 Bosque 1865 XXX-XX  
Mitam Dis.

Hog Cr., Neill's Cr.,  
&  
Bosque.

Received June 15. 1846.

Plotted on map  
Sk. File No 3  
Bosque County

13 Miles S 30° E  
South of Meridian &  
adjoining M. Glennan Co.

County 14742



Sketch of Townships and connections on the bosque  
and tributary

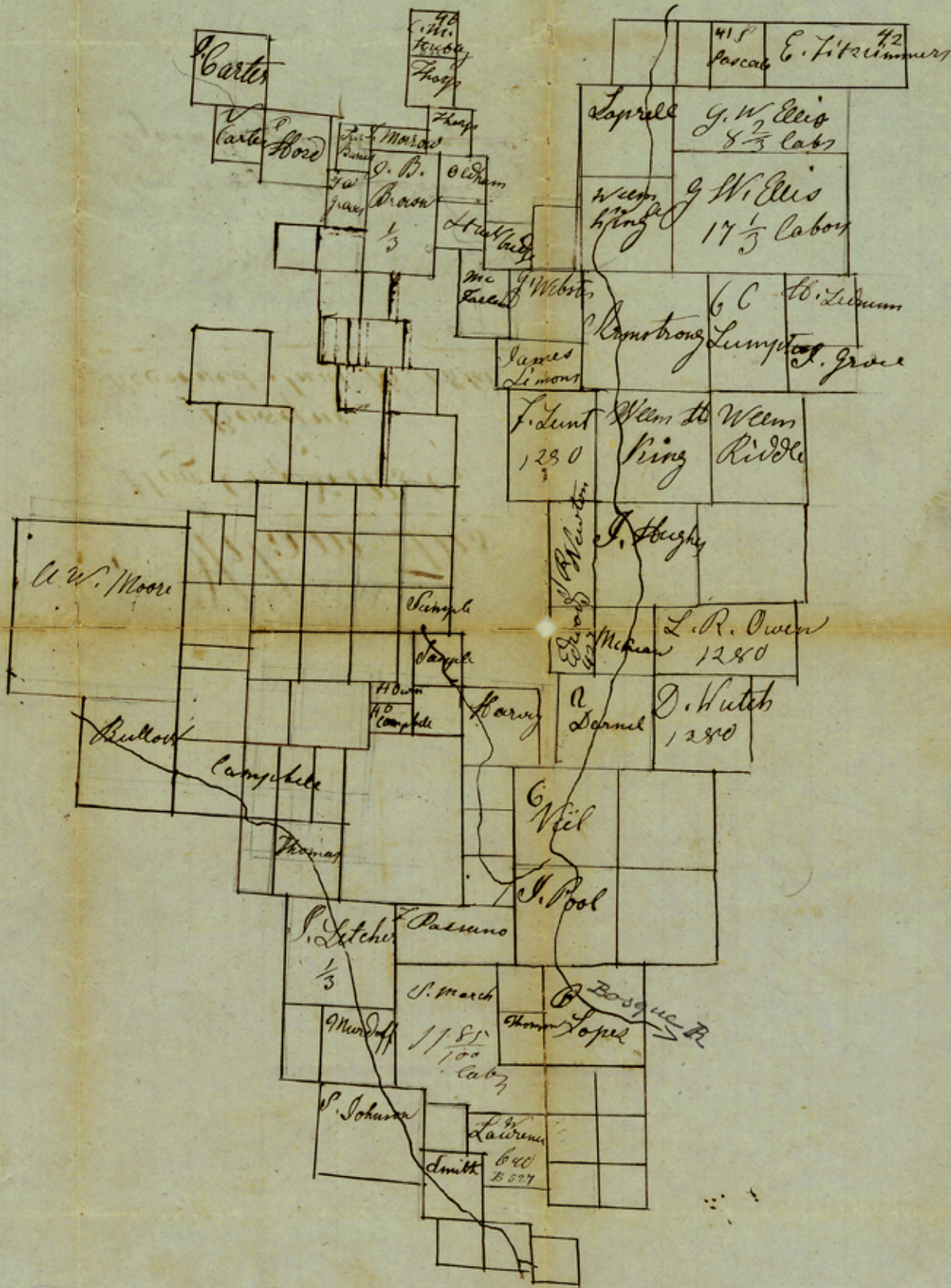

State of Texas  
District of Williamson I do Certify that the above sketch  
is a correct representation of the survey returned  
to this Office by George Green Dep Surveyor of said  
District  
Given at Caldwell this 10<sup>th</sup> day of June 1848  
James Howlet  
District Surveyor  
Counter 14743